

FLORIDA DEPARTMENT OF ENVIRONMENTAL PROTECTION CERTIFIED CORNER RECORD

DOC. # 083016

CORNER DESCRIPTION: **MONUMENTATION DESCRIPTION (EVIDENCE FOUND OR METHOD TO SET)**

Depict corner with

Found broken 4"x4" concrete monument with aluminum disk (HMA 2052) on TOE of berm and TOE of tee number 11.

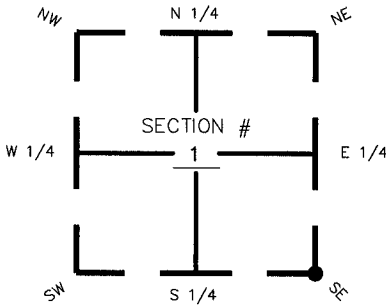

SE corner of Section 1
Twp 48 South, Rge 25 East
Tallahassee Base Meridian,
Collier County(s), Florida

HORIZONTAL POSITION INFORMATION (if determined):

Latitude 26 19 00.67695 N Longitude 81 45 15.32240 W
Y(NORTHING-Ft.) 721576.682 X(EASTING-Ft.) 409095.050 Zone FL83-EF
Convergence -00 20 03.85394 Scale factor 1.00001117
Coordinate determination (circle one): Field traverse GPS
Horizontal datum (circle one): NAD27 NAD83(1986) NAD83(1990) other (explain)
Accuracy (circle one): 1st 2nd 3rd other NAD83(1999)

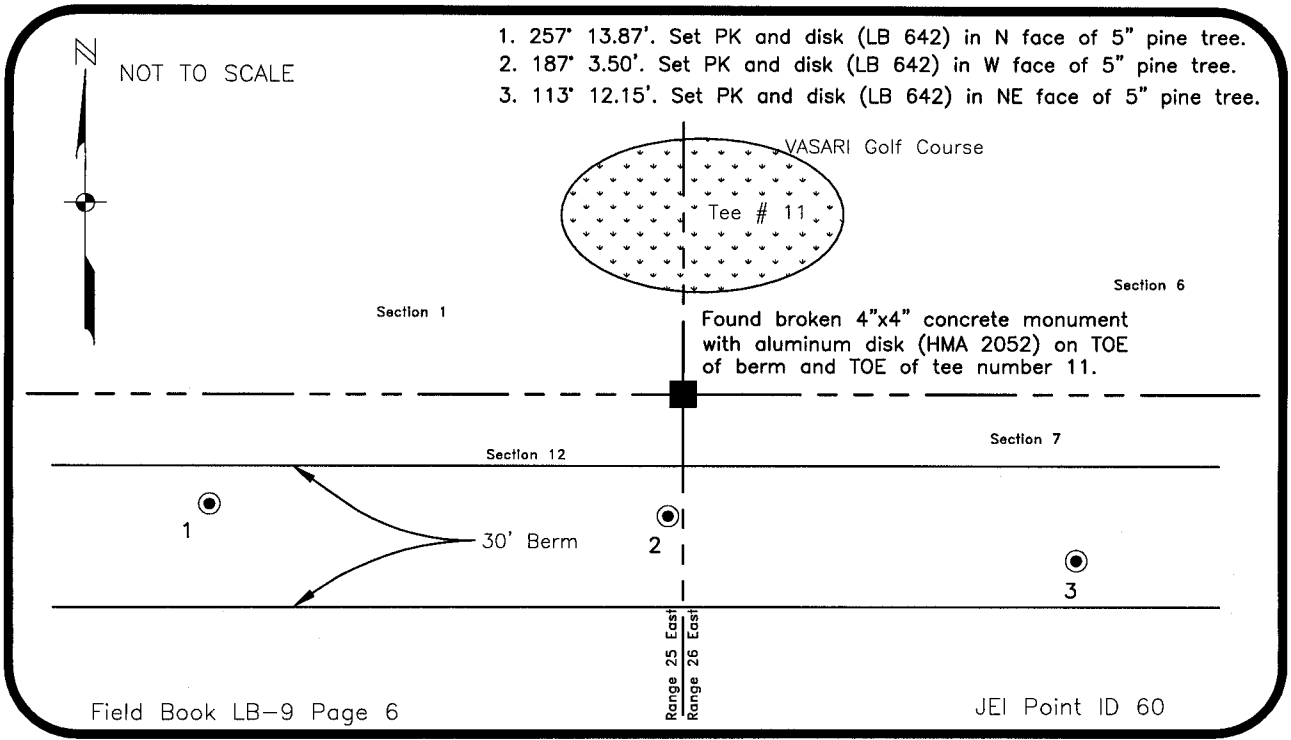

SURVEYORS CERTIFICATE:

I certify the monument and accessories indicated above were field located on June 16, 2004

[Signature]
SIGNATURE 4912
Johnson Engineering, Inc. PSM NO. 642
2158 Johnson Street P.O. Box 1550 LB NO.
Fort Myers, FL 33902-1550 ADDRESS Florida 33902-1550 STATE ZIP
(239) 334-0008 CITY DATE June 3, 2004
HOME NUMBER DATE

SEND ORIGINAL TO:
Department of Environmental Protection
Bureau of Surveying and Mapping
3900 Commonwealth Boulevard
Mail Station 105
Tallahassee, Florida 32399

D.E.P. USE ONLY

Processed: 8-2-04

B.L.M. - I.D. 700 600

QUAD - I.D. 1915 Bonita Springs

EMBOSSED SEAL OVER SIGNATURE