

# FLORIDA DEPARTMENT OF ENVIRONMENTAL PROTECTION CERTIFIED CORNER RECORD

DOC. # \_\_\_\_\_

A-15

CORNER DESCRIPTION: \_\_\_\_\_ MONUMENTATION DESCRIPTION (EVIDENCE FOUND OR METHOD TO SET) \_\_\_\_\_

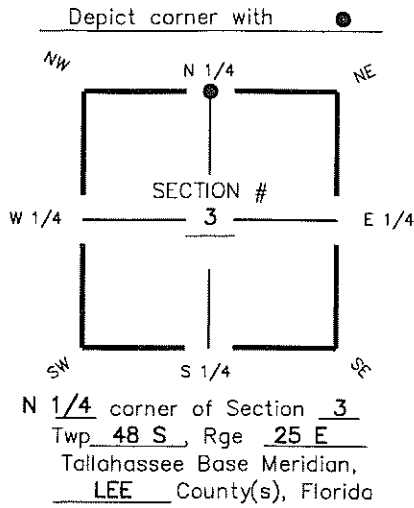

SET P.K. NAIL & DISK  
"AIM ENG. LB 3114"  
USING COORDINATE VALUES  
PER CCR # 077444

HORIZONTAL POSITION INFORMATION ( if determined ):

Latitude 26° 19' 51.1366" N Longitude 81° 47' 41.7742" W  
Y(NORTHING-Ft.) 726003.62 X(EASTING-Ft.) 723329.85 Zone FL W  
Convergence 00° 05' 27.4" Scale factor 0.99994635  
Coordinate determination (circle one): Field traverse (GPS)  
Horizontal datum (circle one): NAD27 NAD83(1986) (NAD83(1999)) other (explain) \_\_\_\_\_  
Accuracy (circle one): 1st (2nd) 3rd other \_\_\_\_\_

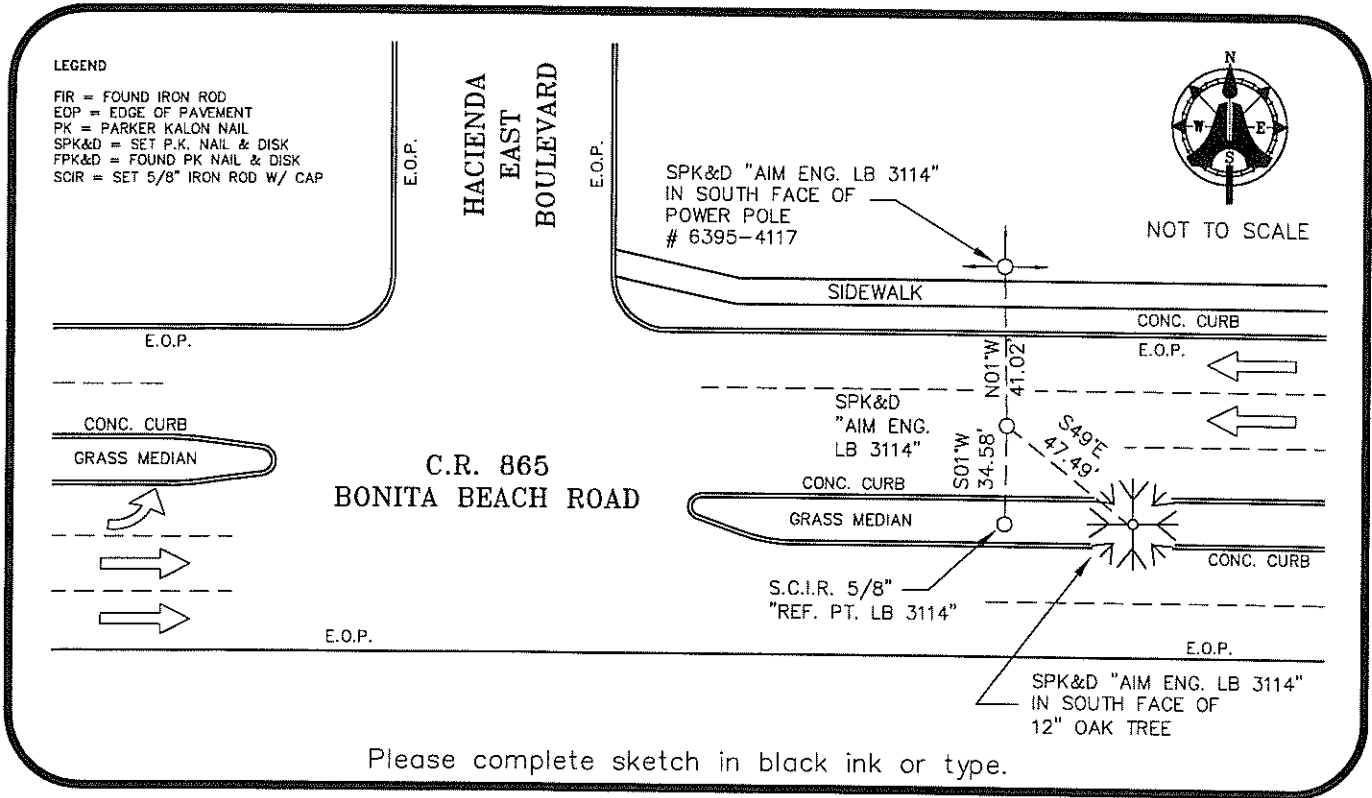

SURVEYORS CERTIFICATE:

I certify the monument and accessories indicated above were field located on APRIL 30, 2008

SIGNATURE \_\_\_\_\_ PSM NO. 5688  
AIM ENGINEERING & SURVEYING, INC. LB 3114  
FIRM OR AGENCY \_\_\_\_\_ LB NO. \_\_\_\_\_  
5300 LEE BOULEVARD  
ADDRESS \_\_\_\_\_  
LEHIGH ACRES, FLORIDA 33971-1026  
CITY STATE ZIP  
(239) 332-4569 03-20-09  
PHONE NUMBER DATE

SEND ORIGINAL TO:  
Department of Environmental Protection  
Bureau of Surveying and Mapping  
3900 Commonwealth Boulevard  
Mail Station 105  
Tallahassee, Florida 32399

D.E.P. USE ONLY
Processed: _____
B.L.M. - I.D. _____
QUAD - I.D. _____

EMBOSSSED SEAL OVER SIGNATURE