

# FLORIDA DEPARTMENT OF ENVIRONMENTAL PROTECTION CERTIFIED CORNER RECORD

DOC. # \_\_\_\_\_

A-13

CORNER DESCRIPTION: MONUMENTATION DESCRIPTION (EVIDENCE FOUND OR METHOD TO SET)

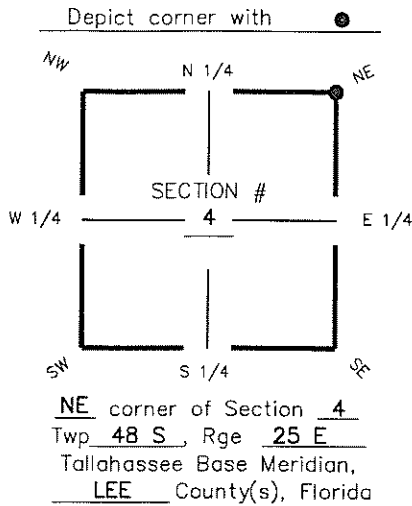

SET P.K. NAIL & DISK  
"AIM ENG. LB 3114"  
USING COORDINATE VALUES  
PER CCR # 077447

HORIZONTAL POSITION INFORMATION ( if determined ):

Latitude 26° 19' 50.5033" N Longitude 81° 48' 10.7999" W  
Y(NORTHING-Ft.) 725935.57 X(EASTING-Ft.) 720689.21 Zone FL W  
Convergence 00° 05' 14.6" Scale factor 0.99994595  
Coordinate determination (circle one): Field traverse  GPS  
Horizontal datum (circle one): NAD27 NAD83(1986)  NAD83(1999) other (explain)  
Accuracy (circle one): 1st  2nd 3rd other \_\_\_\_\_

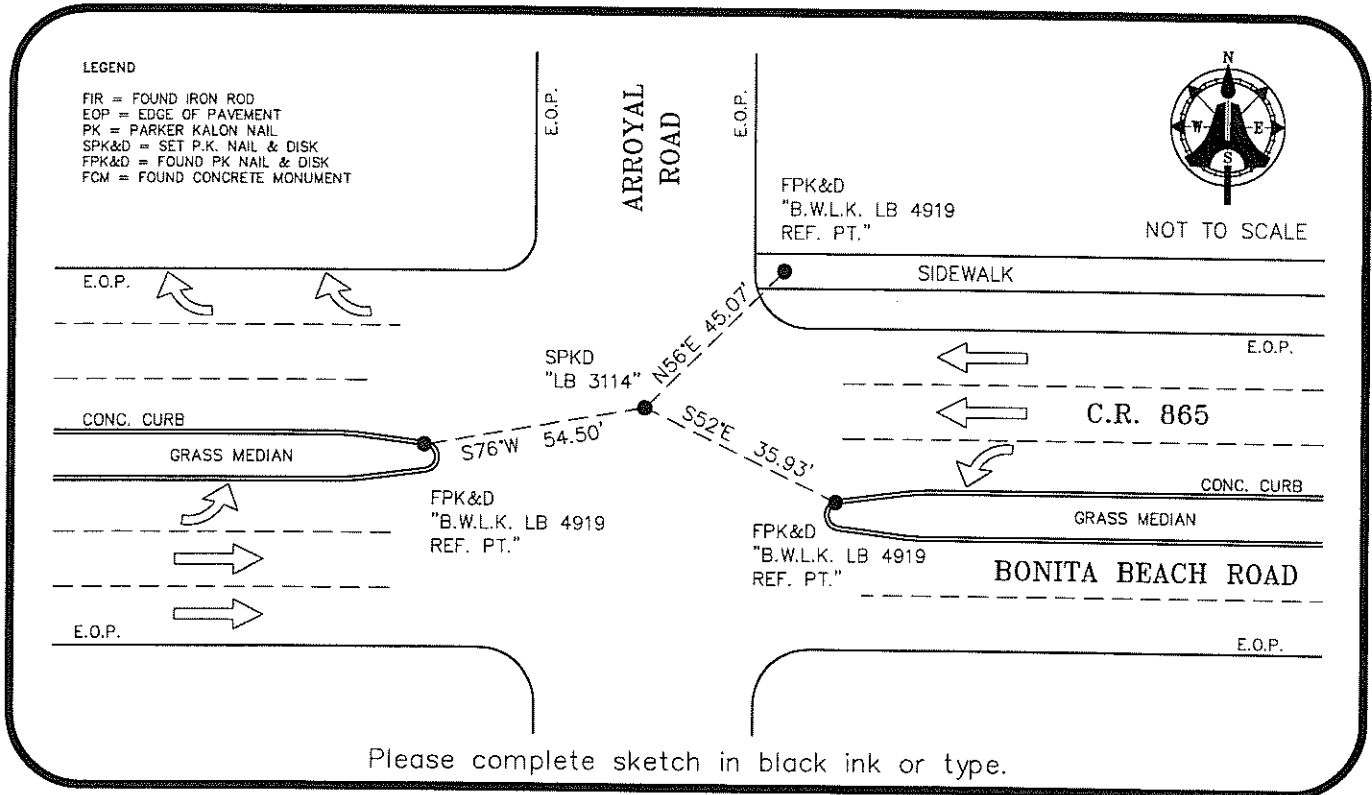

SURVEYORS CERTIFICATE:

I certify the monument and accessories indicated above were field located on APRIL 30, 2008

[Signature] 5688  
SIGNATURE PSM NO.  
AIM ENGINEERING & SURVEYING, INC. LB 3114  
FIRM OR AGENCY LB NO.  
5300 LEE BOULEVARD  
ADDRESS  
LEHIGH ACRES, FLORIDA 33971-1026  
CITY STATE ZIP  
(239) 332-4569 03-20-09  
PHONE NUMBER DATE

SEND ORIGINAL TO:  
Department of Environmental Protection  
Bureau of Surveying and Mapping  
3900 Commonwealth Boulevard  
Mail Station 105  
Tallahassee, Florida 32399

D.E.P. USE ONLY	
Processed: _____	_____
B.L.M. - I.D. _____	_____
QUAD - I.D. _____	_____

EMBOSSSED SEAL OVER SIGNATURE