

FLORIDA DEPARTMENT OF ENVIRONMENTAL PROTECTION CERTIFIED CORNER RECORD

DOC. # _____

A-09

CORNER DESCRIPTION: MONUMENTATION DESCRIPTION (EVIDENCE FOUND OR METHOD TO SET)

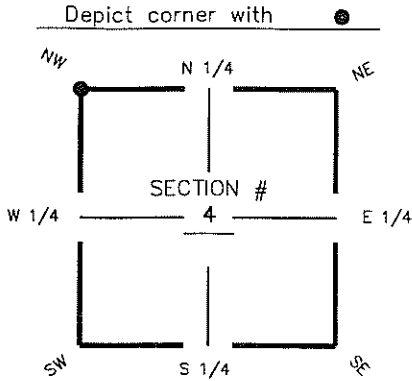

SET P.K. NAIL AND DISK
"AIM ENG. LB 3114"
BASED ON WILSON MILLER SOLL & PEEK, INC.
RIGHT OF WAY MAPS (BONITA BEACH ROAD)
AUGUST 1986.

HORIZONTAL POSITION INFORMATION (if determined):

Latitude 26° 19' 49.7760" N Longitude 81° 49' 08.8694" W
 Y(NORTHING-Ft.) 725854.41 X(EASTING-Ft.) 715406.18 Zone FL W
 Convergence 00° 04' 48.8" Scale factor 0.99994520
 Coordinate determination (circle one): Field traverse GPS
 Horizontal datum (circle one): NAD27 NAD83(1986) NAD83(1999) other (explain) _____
 Accuracy (circle one): 1st 2nd 3rd other _____

NW corner of Section 4
 Twp 48 S, Rge 25 E
 Tallahassee Base Meridian,
LEE County(s), Florida

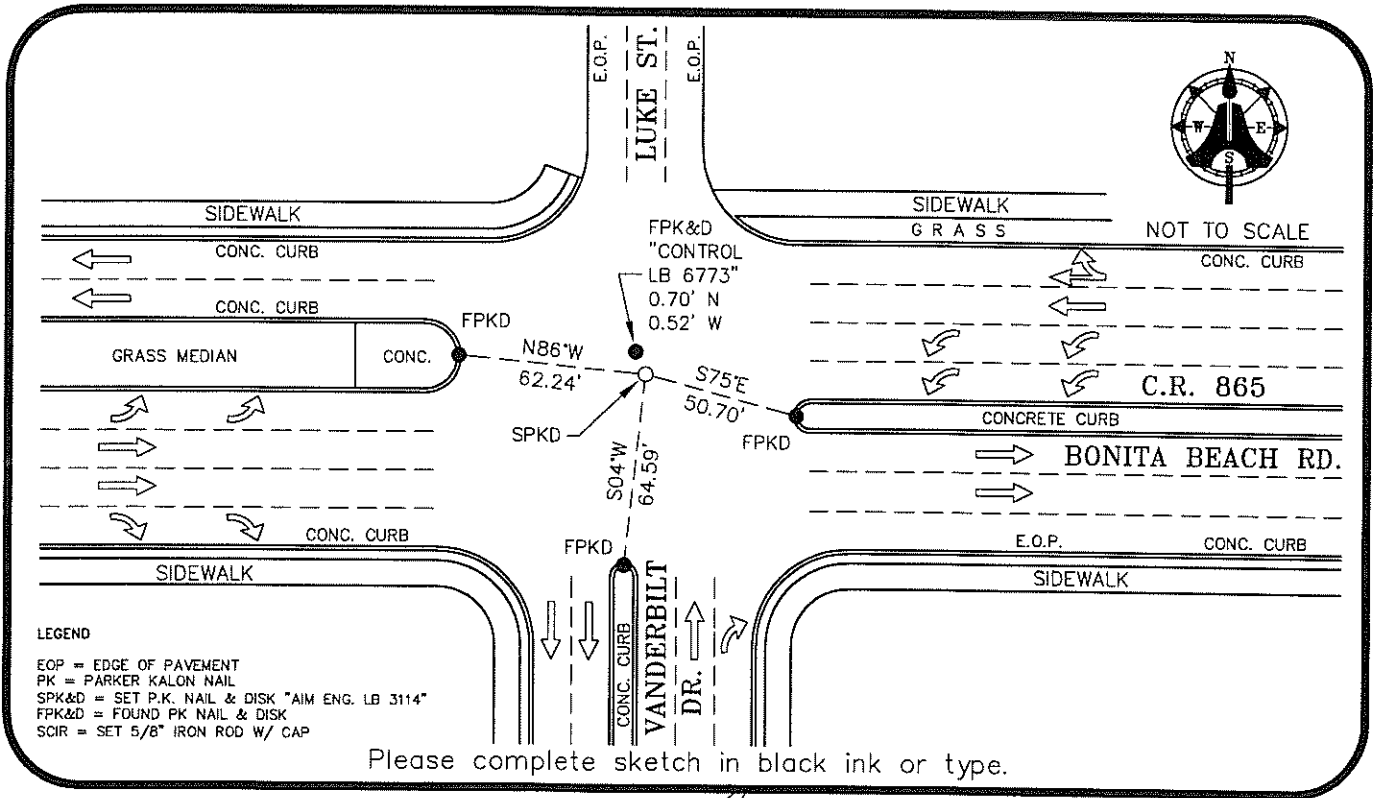

SURVEYORS CERTIFICATE:

I certify the monument and accessories indicated above were field located on AUGUST 25, 2008

 SIGNATURE
AIM ENGINEERING & SURVEYING, INC.
 FIRM OR AGENCY
5300 LEE BOULEVARD
 ADDRESS
LEHIGH ACRES, FLORIDA 33971-1026
 CITY STATE ZIP
(239) 332-4569 03-20-09
 PHONE NUMBER DATE

SEND ORIGINAL TO:
 Department of Environmental Protection
 Bureau of Surveying and Mapping
 3900 Commonwealth Boulevard
 Mail Station 105
 Tallahassee, Florida 32399

D.E.P. USE ONLY	
Processed: _____	_____
B.L.M. - I.D. _____	_____
QUAD - I.D. _____	_____

EMBOSSSED SEAL OVER SIGNATURE