

# FLORIDA DEPARTMENT OF ENVIRONMENTAL PROTECTION CERTIFIED CORNER RECORD

C-09

DOC. # \_\_\_\_\_

CORNER DESCRIPTION: MONUMENTATION DESCRIPTION (EVIDENCE FOUND OR METHOD TO SET)

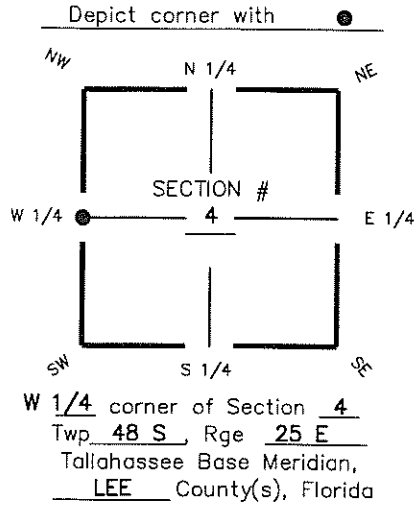

FOUND RAILROAD SPIKE  
IN CUT-OUT

HORIZONTAL POSITION INFORMATION ( if determined ):

Latitude 26° 19' 24.0554" N Longitude 81° 49' 08.6835" W  
 Y(NORTHING-Ft.) 723257.56 X(EASTING-Ft.) 715426.73 Zone FL W  
 Convergence 00° 04' 48.8" Scale factor 0.99994520  
 Coordinate determination (circle one): Field traverse GPS  
 Horizontal datum (circle one): NAD27 NAD83(1986) NAD83(1999) other (explain) \_\_\_\_\_  
 Accuracy (circle one): 1st 2nd 3rd other \_\_\_\_\_

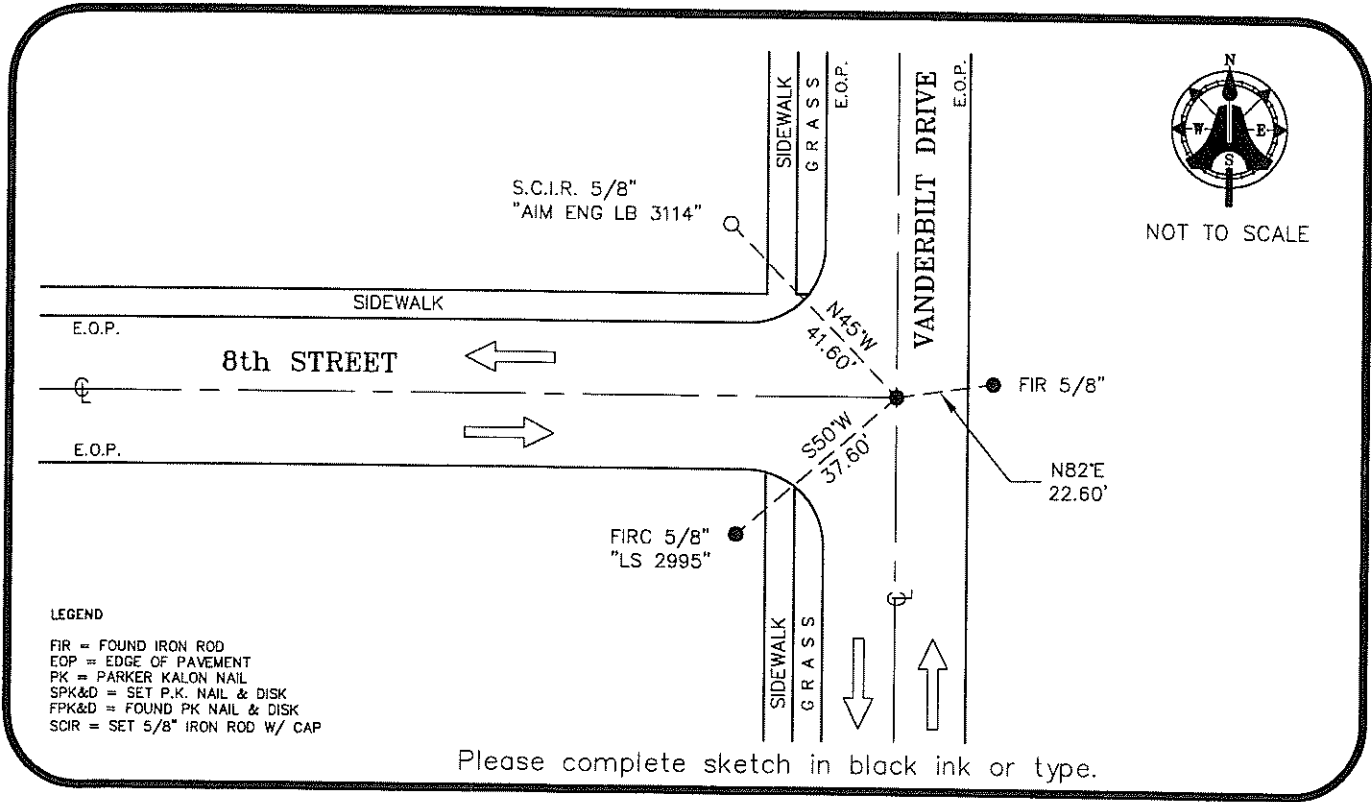

SURVEYORS CERTIFICATE:

I certify the monument and accessories indicated above were field located on MARCH 19, 2008

AIM ENGINEERING & SURVEYING, INC. 5688 PSM NO.  
 5300 LEE BOULEVARD LB NO. 3114  
 LEHIGH ACRES, FLORIDA 33971-1026  
 (239) 332-4569 03-20-09  
 PHONE NUMBER DATE

SEND ORIGINAL TO:  
 Department of Environmental Protection  
 Bureau of Surveying and Mapping  
 3900 Commonwealth Boulevard  
 Mail Station 105  
 Tallahassee, Florida 32399

D.E.P. USE ONLY	
Processed: _____	_____
B.L.M. - I.D. _____	_____
QUAD - I.D. _____	_____

EMBOSSER SEAL OVER SIGNATURE