

FLORIDA DEPARTMENT OF ENVIRONMENTAL PROTECTION CERTIFIED CORNER RECORD

081650

DOC. # _____

E-01

CORNER DESCRIPTION:

MONUMENTATION DESCRIPTION (EVIDENCE FOUND OR METHOD TO SET)

DEPICT CORNER WITH

FOUND 4" X 4" CONCRETE MONUMENT WITH BRASS DISK, 1.5' ABOVE GROUND, STAMPED

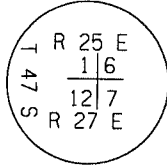
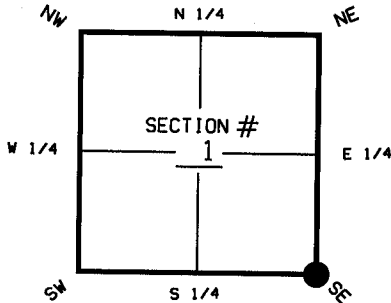

HORIZONTAL POSITION INFORMATION (IF DETERMINED):

LATITUDE 26° 24' 21.0992" N LONGITUDE 81° 45' 21.3333" W
 Y(NORTHING-FT.) 753282.76 X(EASTING-FT.) 736055.53 ZONE FL WEST
 CONVERGENCE 00° 06' 30.8" SCALE FACTOR 0.99994849

SE CORNER OF SECTION 1
 TWP 47 S, RGE 25 E
 TALLAHASSEE BASE MERIDIAN,
LEE COUNTY(S), FLORIDA

COORDINATE DETERMINATION (CIRCLE ONE): FIELD TRAVERSE GPS
 HORIZONTAL DATUM (CIRCLE ONE): NAD27 NAD83(1986) NAD83(1990) OTHER (EXPLAIN) _____
 ACCURACY (CIRCLE ONE): 1ST 2ND 3RD OTHER _____

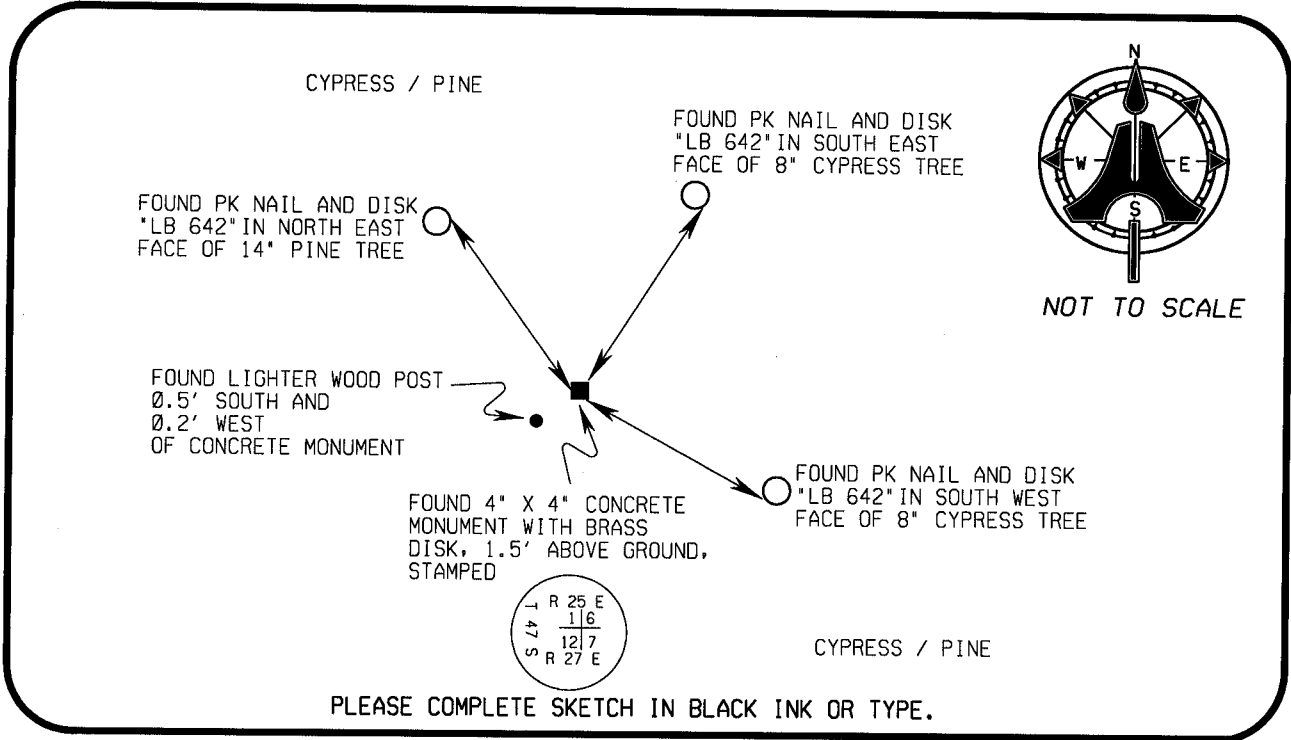

NOT TO SCALE

SURVEYORS CERTIFICATE:

I CERTIFY THE MONUMENT AND ACCESSORIES INDICATED ABOVE WERE FIELD LOCATED ON FEBRUARY 4, 2004

_____ 5688
SIGNATURE PSM NO.
 AJM ENGINEERING & SURVEYING, INC. LB 3114
FIRM OR AGENCY LB NO.
 5300 LEE BOULEVARD
ADDRESS
 LEHIGH ACRES, FLORIDA 33971-1026
CITY STATE ZIP
 (239) 332-4569 05/06/04
PHONE NUMBER DATE

SEND ORIGINAL TO:
 DEPARTMENT OF ENVIRONMENTAL PROTECTION
 BUREAU OF SURVEYING AND MAPPING
 3900 COMMONWEALTH BOULEVARD
 MAIL STATION 105
 TALLAHASSEE, FLORIDA 32399

D.E.P. USE ONLY

PROCESSED: 5-12-04
 B.L.M. - I.D. 700600
 QUAD - I.D. 2015 Estero

EMBOSSSED SEAL OVER SIGNATURE