

FLORIDA DEPARTMENT OF ENVIRONMENTAL PROTECTION CERTIFIED CORNER RECORD

DOC. # 081653

C-23

CORNER DESCRIPTION: MONUMENTATION DESCRIPTION (EVIDENCE FOUND OR METHOD TO SET)

DEPICT CORNER WITH SET 5/8" IRON ROD AND CAP "AIM ENG LB 3114 "

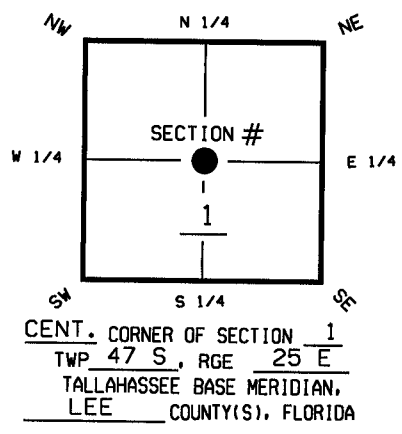

HORIZONTAL POSITION INFORMATION (IF DETERMINED):
 LATITUDE 26° 24' 47.3062" N LONGITUDE 81° 45' 50.9371" W
 Y(NORTHING-FT.) 755923.77 X(EASTING-FT.) 733359.08 ZONE FL WEST
 CONVERGENCE 00° 06' 17.7" SCALE FACTOR 0.99994801
 COORDINATE DETERMINATION (CIRCLE ONE): FIELD TRAVERSE GPS
 HORIZONTAL DATUM (CIRCLE ONE): NAD27 NAD83(1986) NAD83(1990) OTHER (EXPLAIN)
 ACCURACY (CIRCLE ONE): 1ST 2ND 3RD OTHER _____

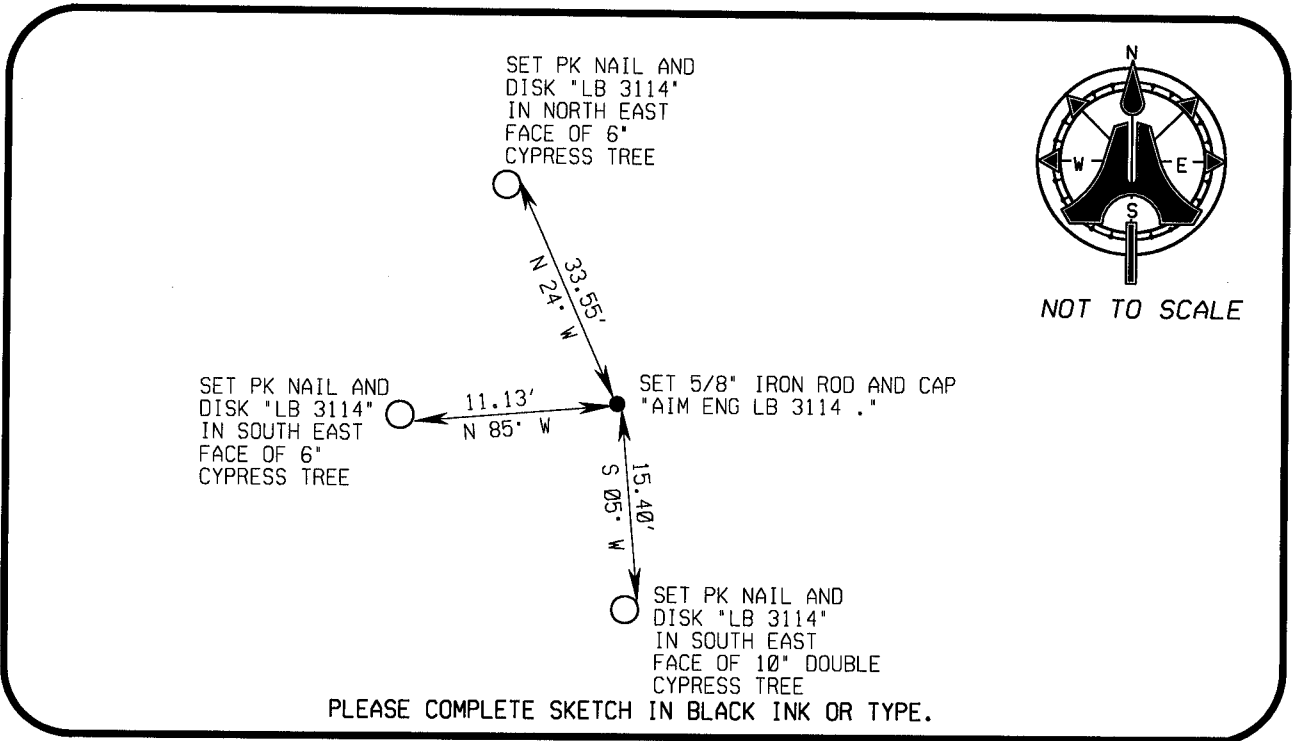

SURVEYORS CERTIFICATE:

I CERTIFY THE MONUMENT AND ACCESSORIES INDICATED ABOVE WERE FIELD LOCATED ON FEBRUARY 11, 2004

[Signature] 5688
 SIGNATURE PSM NO.
AIM ENGINEERING & SURVEYING, INC. LB 3114
 FIRM OR AGENCY LB NO.
5300 LEE BOULEVARD
 ADDRESS
LEHIGH ACRES, FLORIDA 33971-1026
 CITY STATE ZIP
(239) 332-4569 DATE 05/06/04
 PHONE NUMBER
 EMBOSSED SEAL OVER SIGNATURE

SEND ORIGINAL TO:
 DEPARTMENT OF ENVIRONMENTAL PROTECTION
 BUREAU OF SURVEYING AND MAPPING
 3900 COMMONWEALTH BOULEVARD
 MAIL STATION 105
 TALLAHASSEE, FLORIDA 32399

	D.E.P. USE ONLY
PROCESSED: <u>5-12-04</u>	
B.L.M. - I.D. <u>640640</u>	
QUAD - I.D. <u>2015 E5400</u>	