

# FLORIDA DEPARTMENT OF ENVIRONMENTAL PROTECTION CERTIFIED CORNER RECORD

DOC. # \_\_\_\_\_

X-19

CORNER DESCRIPTION: \_\_\_\_\_ MONUMENTATION DESCRIPTION (EVIDENCE FOUND OR METHOD TO SET) \_\_\_\_\_

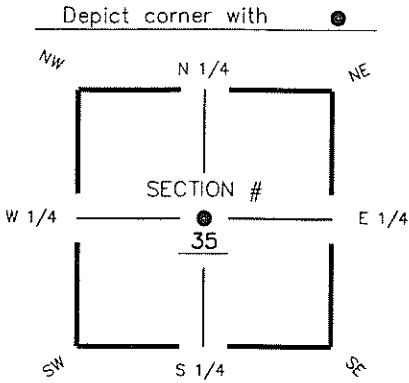

SET P.K. NAIL & DISK  
"AIM ENG. LB 3114"  
AT CENTER OF SECTION 35-47-25  
USING COORDINATE VALUES  
PER CCR # 084085

HORIZONTAL POSITION INFORMATION ( if determined ):

Latitude 26° 20' 18.2222" N Longitude 81° 46' 44.2005" W  
 Y(NORTHING-Ft.) 728746.96 X(EASTING-Ft.) 728563.20 Zone FL W  
 Convergence 00° 05' 53.1" Scale factor 0.99994719

CENTER corner of Section 35  
 Twp 47 S, Rge 25 E  
 Tallahassee Base Meridian,  
LEE County(s), Florida

Coordinate determination (circle one): Field traverse  GPS  
 Horizontal datum (circle one): NAD27 NAD83(1986)  NAD83(1999) other (explain) \_\_\_\_\_  
 Accuracy (circle one): 1st  2nd  3rd  other \_\_\_\_\_

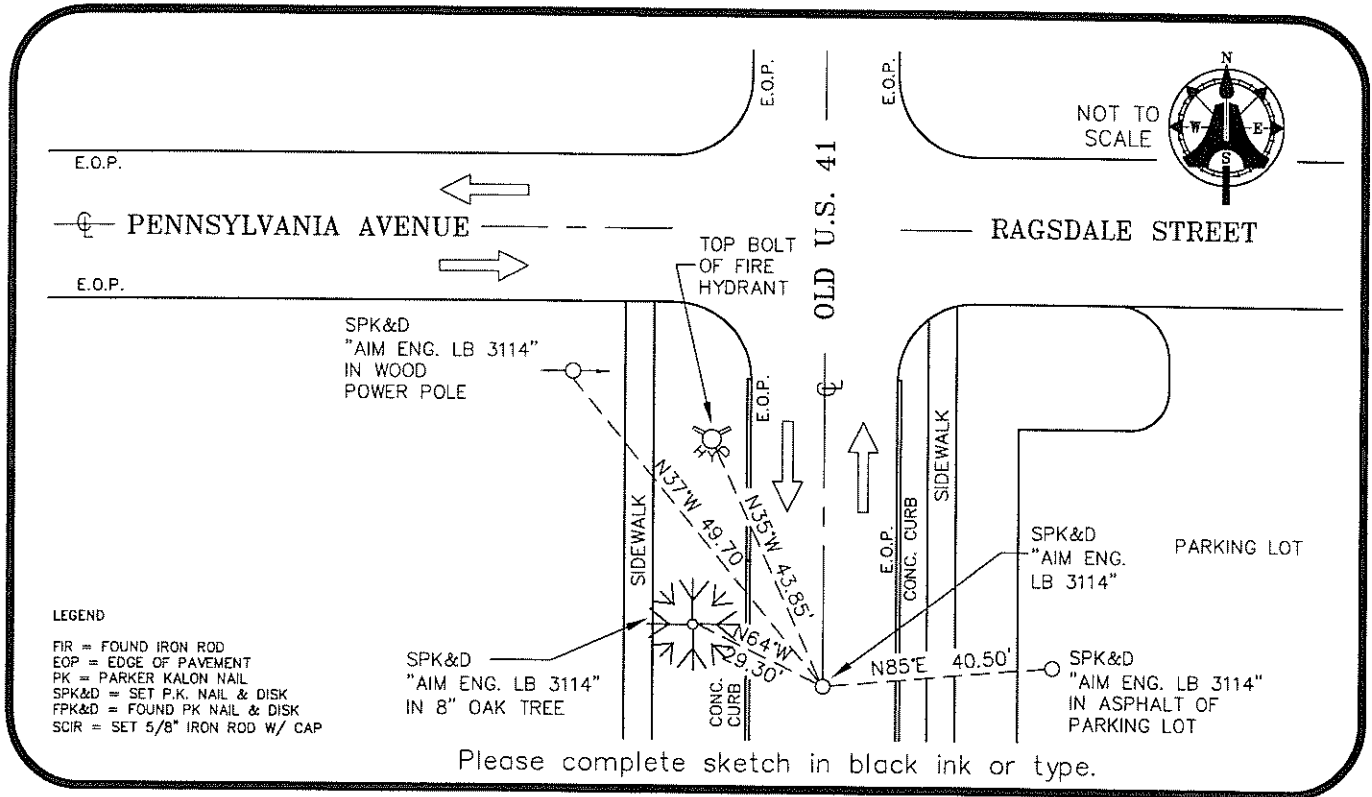

SURVEYORS CERTIFICATE:

I certify the monument and accessories indicated above were field located on MARCH 19, 2008

SIGNATURE \_\_\_\_\_ PSM NO. 5688  
 FIRM OR AGENCY AIM ENGINEERING & SURVEYING, INC. LB NO. LB 3114  
 ADDRESS 5300 LEE BOULEVARD  
LEHIGH ACRES, FLORIDA 33971-1026  
 CITY STATE ZIP  
(239) 332-4569 03-20-09  
 PHONE NUMBER DATE

SEND ORIGINAL TO:  
 Department of Environmental Protection  
 Bureau of Surveying and Mapping  
 3900 Commonwealth Boulevard  
 Mail Station 105  
 Tallahassee, Florida 32399

D.E.P. USE ONLY	
Processed: _____	_____
B.L.M. - I.D. _____	_____
QUAD - I.D. _____	_____

EMBOSSSED SEAL OVER SIGNATURE