

**FLORIDA DEPARTMENT OF ENVIRONMENTAL PROTECTION
CERTIFIED CORNER RECORD**

DOC. # 075319

CORNER DESCRIPTION: MONUMENTATION DESCRIPTION (EVIDENCE FOUND OR METHOD TO SET)

Depict corner with ●

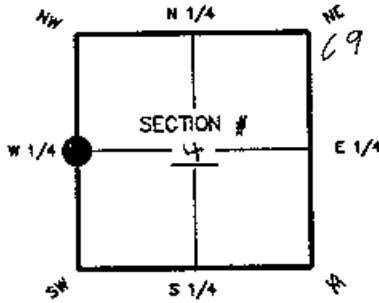

FOUND 4" x 4" C.M. W/PIN

HORIZONTAL POSITION INFORMATION (if determined):

Latitude 26°-30'-07.17164" Longitude 81°-55'-08.94038"
 Y(NORTHING-FL) 788157.057 X(EASTING-FL) 682607.959 Zone WEST
 Convergence 0°-02'-09.9" Scale factor 0.99994198
 Coordinate determination (circle one): Field traverse (GPS)
 Horizontal datum (circle one): NAD27 NAD83(1986) (NAD83(1990)) other (explain)
 Accuracy (circle one): 1st 2nd 3rd other 1:50,000

W 1/4 corner of Section 4
 Twp 46S, Rge 24E
 Tallahassee Base Meridian,
LEE County(s), Florida

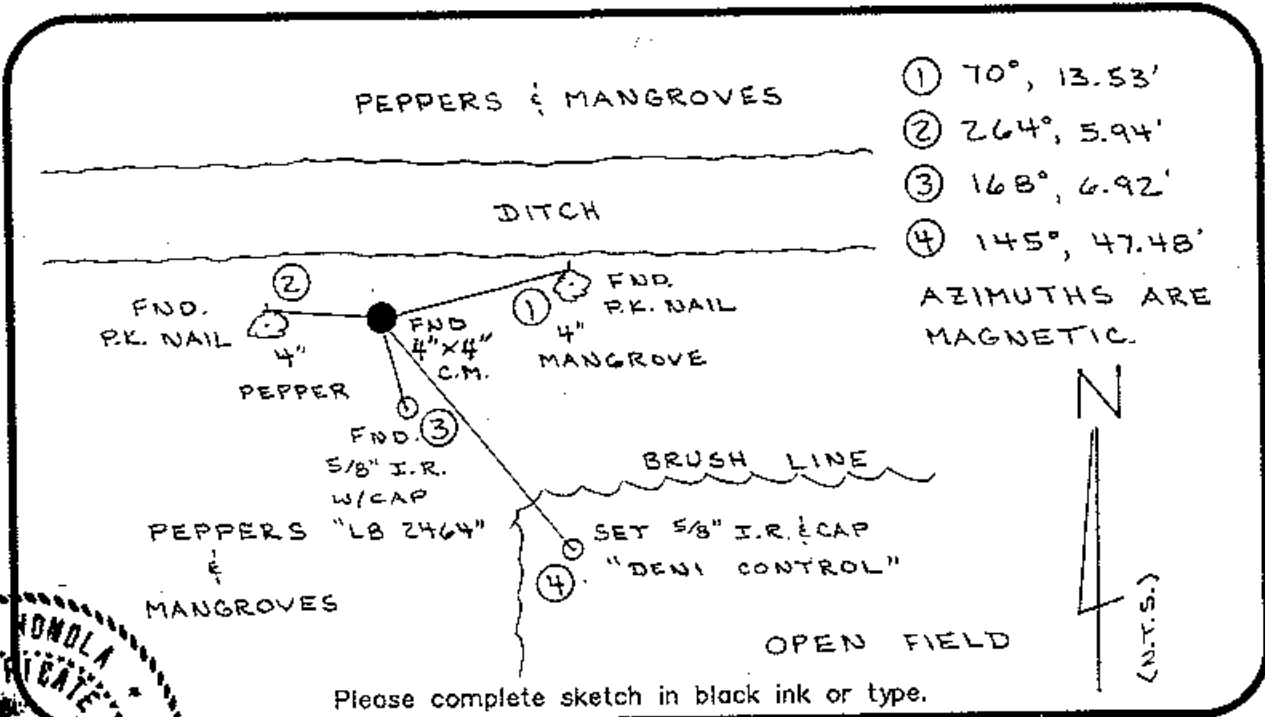

- ① 70°, 13.53'
- ② 264°, 5.94'
- ③ 168°, 6.92'
- ④ 145°, 47.48'

AZIMUTHS ARE MAGNETIC.



Please complete sketch in black ink or type.

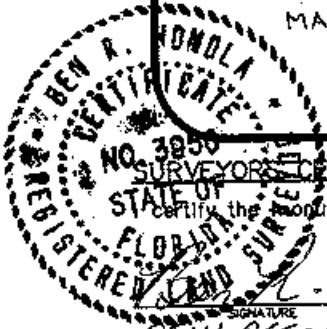

SURVEYOR'S CERTIFICATE:

certify the monument and accessories indicated above were field located on MARCH 2002

Ben R. Honola 3950
 SIGNATURE PSM NO.
DENI ASSOCIATES, INC 3542
 FIRM OR AGENCY LB NO.
6241 ARB WAY
 ADDRESS
FORT MYERS, FL 33912
 CITY STATE ZIP
(239) 275-8875 5-8-02
 PHONE NUMBER DATE

SEND ORIGINAL TO:
 Department of Environmental Protection
 Bureau of Surveying and Mapping
 3900 Commonwealth Boulevard
 Mail Station 105
 Tallahassee, Florida 32399

D.E.P. USE ONLY	
Processed:	<u>5-17-02</u> <u>CS</u>
B.L.M. - I.D.	<u>300640</u>
QUAD - I.D.	<u>403 Fort Myers SW</u>

EMBOSSSED SEAL OVER SIGNATURE