

FLORIDA DEPARTMENT OF ENVIRONMENTAL PROTECTION CERTIFIED CORNER RECORD

DOC. # 094491

CORNER DESCRIPTION: MONUMENTATION DESCRIPTION (EVIDENCE FOUND OR METHOD TO SET)

Depict corner with

FOUND 1/2" IRON ROD AND CAP (ILLEGIBLE)

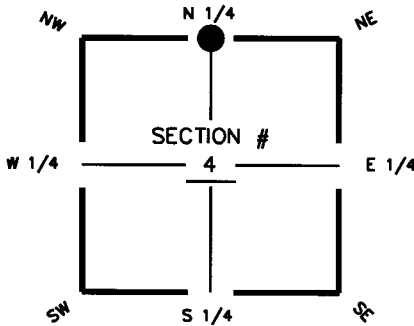

N 1/4 corner of Section 4
Twp 45 S, Rge 27 E
Tallahassee Base Meridian,
LEE County(s), Florida

HORIZONTAL POSITION INFORMATION (if determined):

Latitude 26° 35' 57.9000" N. Longitude 81° 37' 18.6011" W.
Y(NORTHING-Ft.) 823743.539 X(EASTING-Ft.) 779738.907 Zone WEST
Convergence 0° 10' 09.5735" Scale factor 0.999958684
Coordinate determination (circle one): Field traverse GPS
Horizontal datum (circle one): NAD27 NAD83(1986) NAD83(1999) other (explain)
Accuracy (circle one): 1st 2nd 3rd other 1:50,000

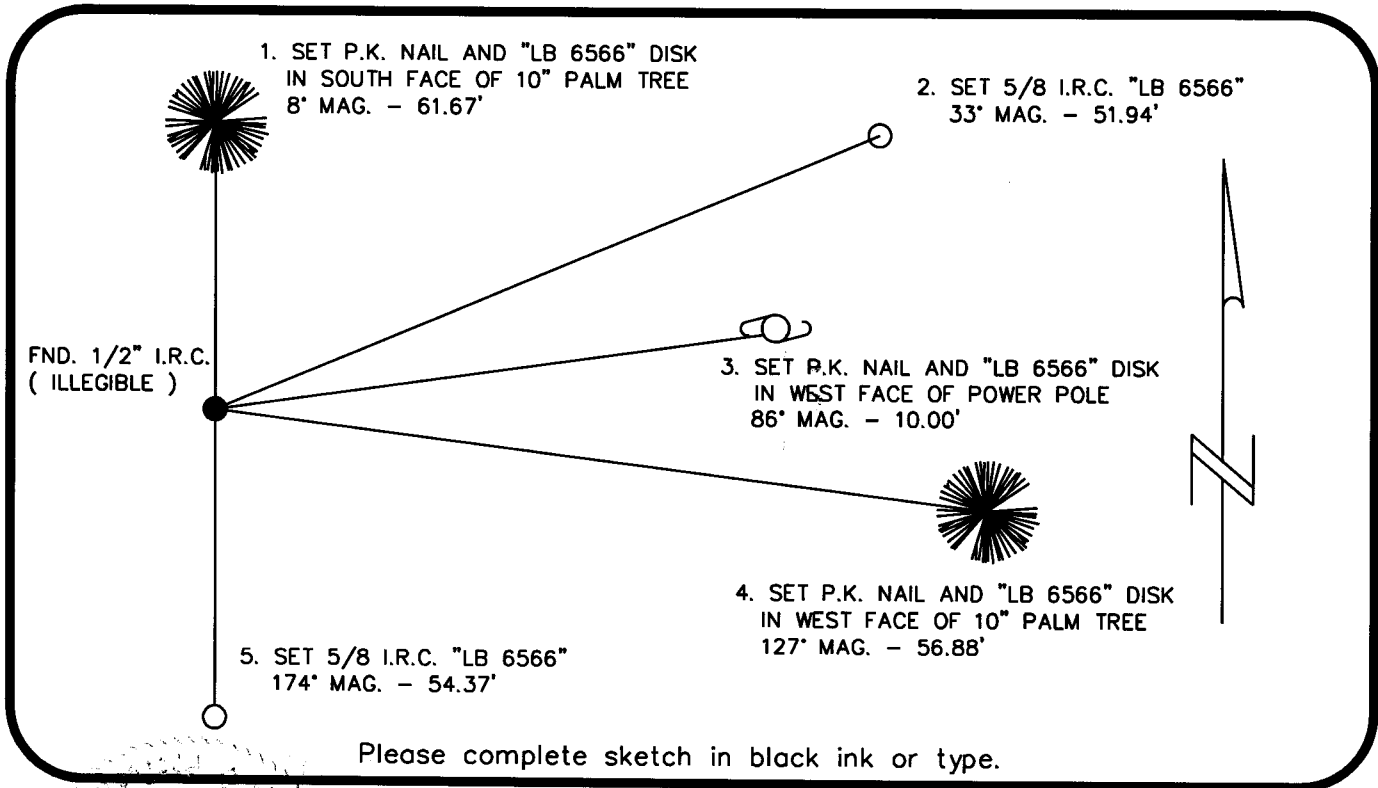

SURVEYORS CERTIFICATE:

I certify the monument and accessories indicated above were field located on 04/28/08

SIGNATURE 6541
McKIM & CREED, PA PSM NO.
FIRM OR AGENCY 6566
10970 S. CLEVELAND AVENUE, SUITE 401 LB NO.
ADDRESS
FORT MYERS FLORIDA 33907
CITY STATE ZIP
(239) 275-8875 5-22-2008
PHONE NUMBER DATE

SEND ORIGINAL TO:
Department of Environmental Protection
Bureau of Surveying and Mapping
3900 Commonwealth Boulevard
Mail Station 105
Tallahassee, Florida 32399

D.E.P. USE ONLY

Processed: 6-1-08 MB
B.L.M. - I.D. 340700
QUAD - I.D. 2113 Alva SE

EMBOSSSED SEAL OVER SIGNATURE