

**FLORIDA DEPARTMENT OF ENVIRONMENTAL PROTECTION  
CERTIFIED CORNER RECORD**

102136

DOC. # \_\_\_\_\_

**CORNER DESCRIPTION:**

Depict corner with \_\_\_\_\_

**MONUMENTATION DESCRIPTION (EVIDENCE FOUND OR METHOD TO SET)**

FOUND 5/8" IRON ROD AND CAP WITH NO IDENTIFICATION

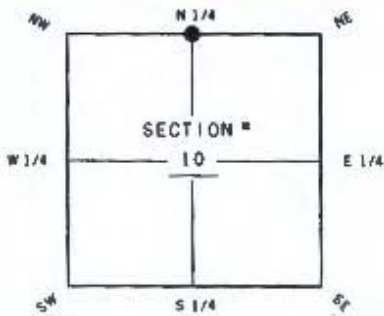

N 1/4 corner of Section 10  
TWP 45 S RGE 26 E  
Tallahassee Base Meridian,  
LEE County(s), Florida

**HORIZONTAL POSITION INFORMATION (if determined):**

Latitude 26° 35' 04.09959" N Longitude 81° 42' 07.61798" W  
Y(NORTHING-Ft.) 818242.062 X(EASTING-Ft.) 753517.734 Zone FL-WEST  
Convergence 0° 07' 59.9" Scale factor 0.999952043  
Coordinate determination (circle one): Field traverse GPS  
Horizontal datum (circle one): NAD27 NAD83(1983) NAD83(1999) other (explain) \_\_\_\_\_  
Accuracy (circle one): 1st 2nd 3rd other \_\_\_\_\_

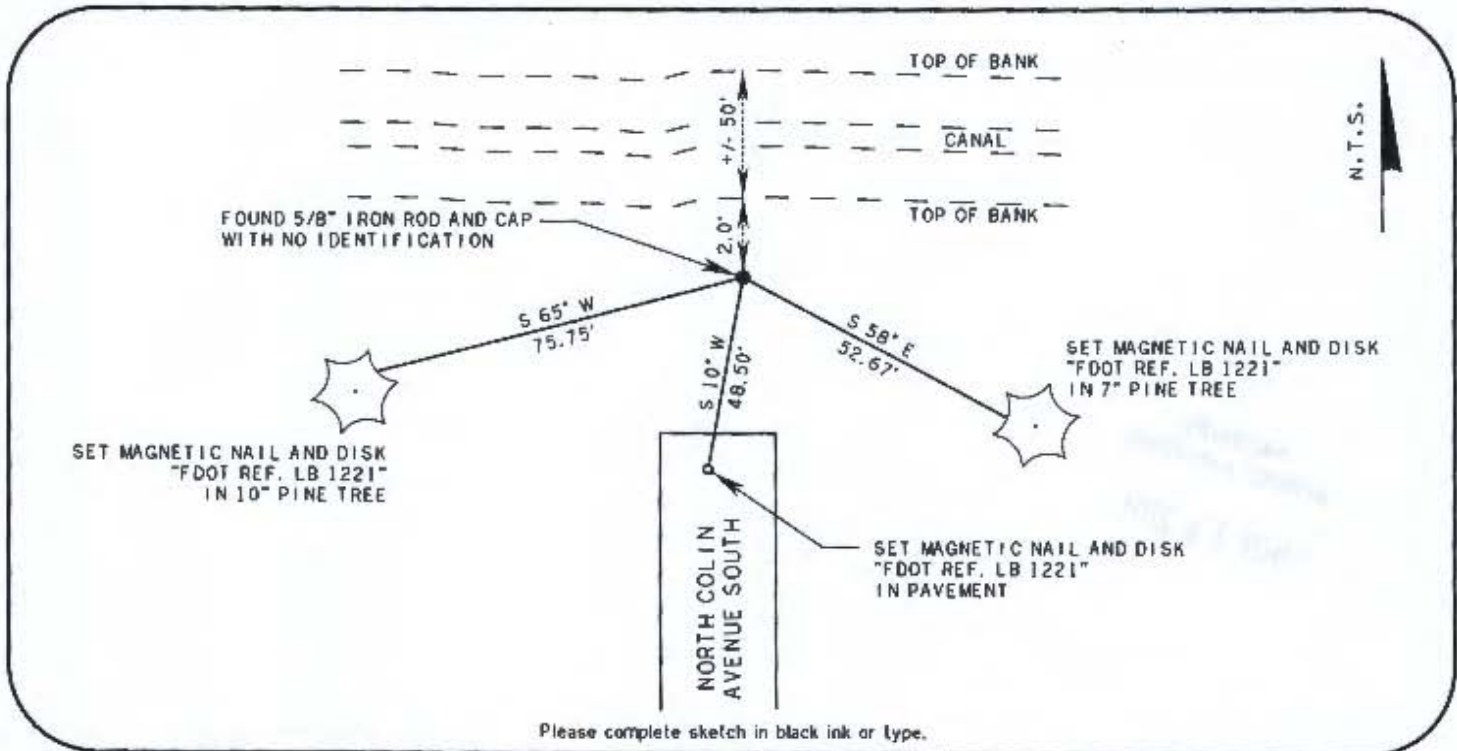

Please complete sketch in black ink or type.

**SURVEYORS CERTIFICATE:**

I certify the monument and accessories indicated above were field located on

NOVEMBER 2, 2011

*William P. Bower* 4633  
SIGNATURE PERM NO.  
BOWYER-SINGLETON & ASSOC. INC. 1221  
FIRM OR AGENCY LB NO.  
520 SOUTH MAGNOLIA AVE.  
ADDRESS  
ORLANDO FLORIDA 32801  
CITY STATE ZIP  
407-843-5120 NOVEMBER 11, 2011  
PHONE NUMBER DATE

**SEND ORIGINAL TO:**  
Department of Environmental Protection  
Bureau of Surveying and Mapping  
3900 Commonwealth Boulevard  
Mail Station 105  
Tallahassee, Florida 32399

D. E. P. USE ONLY

Processed 11-18-11 WCE  
B. L. M. - I. D. 440600  
QUAD - I. D. 2114 ALVA SW

**EMBOSSSED SEAL OVER SIGNATURE**