

**FLORIDA DEPARTMENT OF ENVIRONMENTAL PROTECTION
CERTIFIED CORNER RECORD**

083441

DOC. # _____

CORNER DESCRIPTION: **MONUMENTATION DESCRIPTION (EVIDENCE FOUND OR METHOD TO SET)**

Depict corner with ●

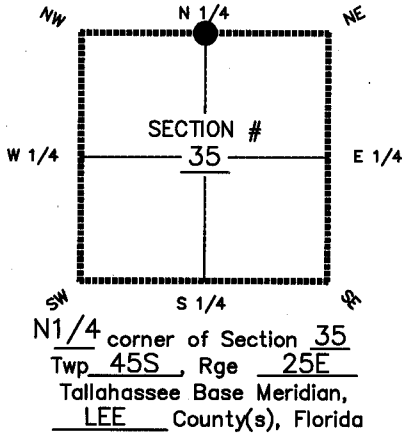

FOUND 3"X5" FORT MYERS DRAINAGE DISTRICT CONCRETE MONUMENT

HORIZONTAL POSITION INFORMATION (if determined):

Latitude 26° 31' 32.15655" Longitude 81° 46' 55.24430"
 Y(NORTHING-Ft.) 796789.966 X(EASTING-Ft.) 727443.264 Zone WEST
 Convergence 0° 05' 50.5" Scale factor 0.99994700
 Coordinate determination (circle one): Field traverse GPS
 Horizontal datum (circle one): NAD27 NAD83(1986) NAD83(1990) other (explain)
 Accuracy (circle one): 1st 2nd 3rd other 1:50,000

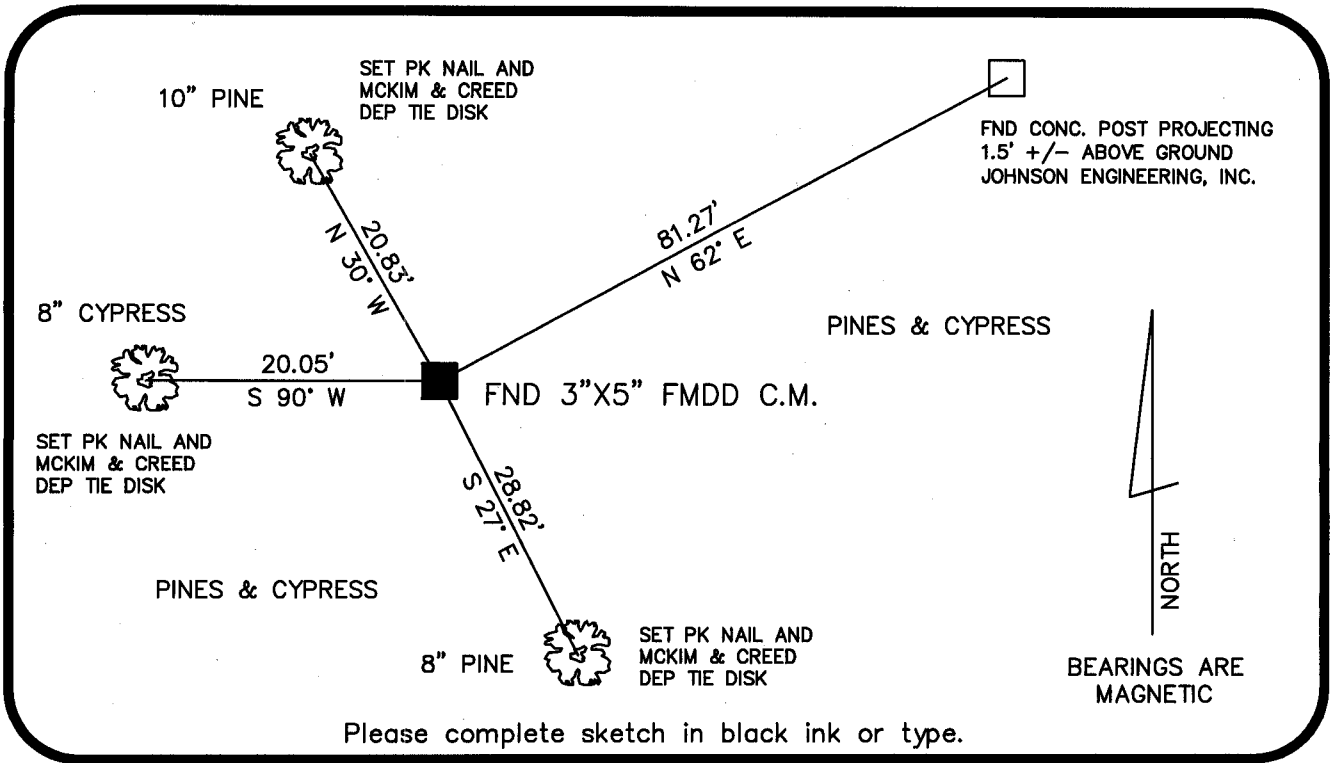

SURVEYORS CERTIFICATE:

I certify the monument and accessories indicated above were field located on 11-17-04

Jeffrey M. Stille
 SIGNATURE: _____ 6389
 MCKIM & CREED PSM NO. 6566
 FIRM OR AGENCY: _____ LB NO. _____
 6241 ARC WAY ADDRESS
 FORT MYERS FL 33912
 CITY STATE ZIP
 (239) 275-8875 OF 12-03-04
 PHONE NUMBER DATE

SEND ORIGINAL TO:
 Department of Environmental Protection
 Bureau of Surveying and Mapping
 3900 Commonwealth Boulevard
 Mall Station 105
 Tallahassee, Florida 32399

D.E.P. USE ONLY

Processed: 12-9-04 S.ym
 B.L.M. - I.D. 540200
 QUAD - I.D. 2115 Fort Meyers SE

EMBOSSSED SEAL OVER SIGNATURE