

**FLORIDA DEPARTMENT OF ENVIRONMENTAL PROTECTION
CERTIFIED CORNER RECORD**

Z-13

DOC. # 084397

CORNER DESCRIPTION: MONUMENTATION DESCRIPTION (EVIDENCE FOUND OR METHOD TO SET)

Depict corner with ●

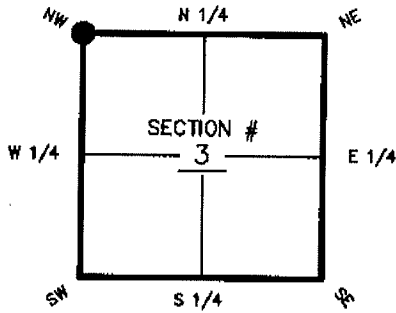

FOUND 3"X3" C.M. (NO I.D.)

HORIZONTAL POSITION INFORMATION (if determined):

Latitude 26°-35'-53.15112" Longitude 81°-48'-25.35522"
 Y(NORTHING-Ft.) 823128.991 X(EASTING-Ft.) 719219.102 Zone WEST
 Convergence 0°-05'-11.0" Scale factor 0.99994573
 Coordinate determination (circle one): Field traverse (GPS)
 Horizontal datum (circle one): NAD27 NAD83(1986) (NAD83(1990)) other (explain)
 Accuracy (circle one): 1st 2nd 3rd other 1:50,000

NW corner of Section 3
 Twp. 45S, Rge. 25E
 Tallahassee Base Meridian,
LEE County(s), Florida

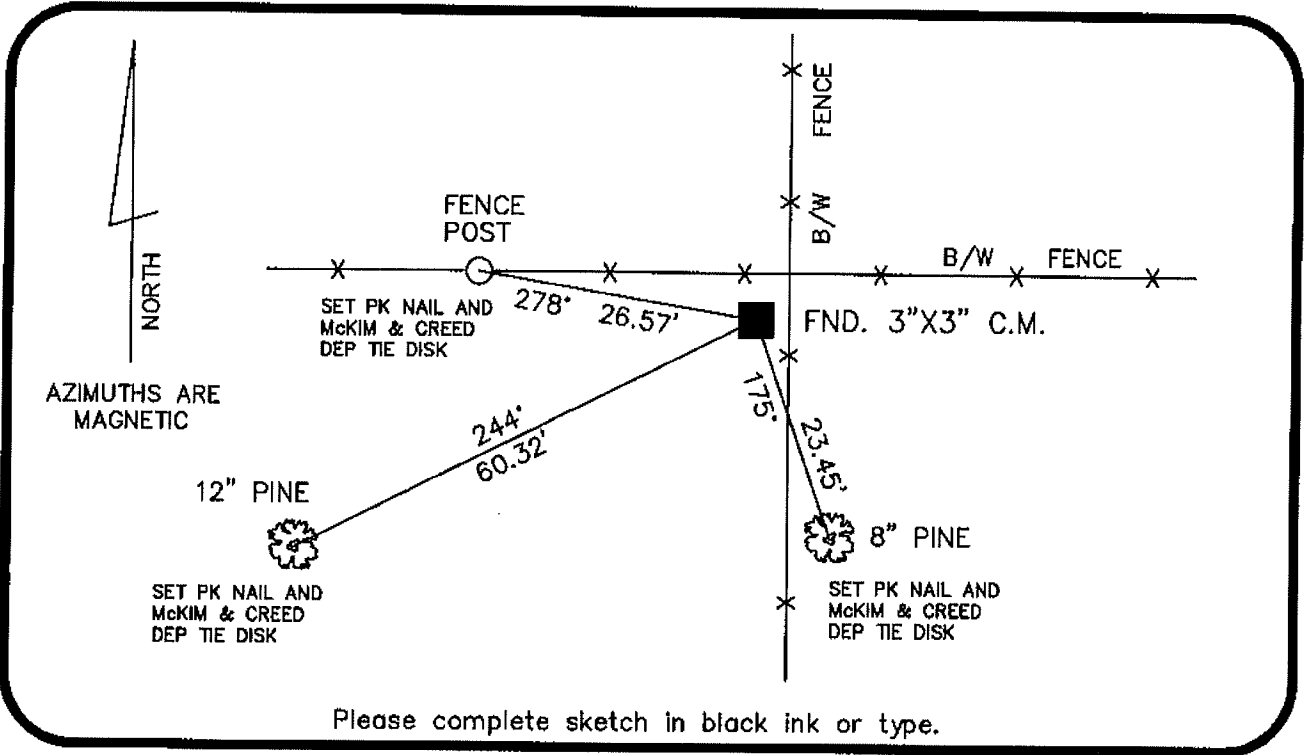

SURVEYORS CERTIFICATE:

I certify the monument and accessories indicated above were field located on 7-06-04

Jason D. Hill
 SIGNATURE
McKIM & CREED 6008 PSM NO. 6566
 FIRM OR AGENCY LB NO.
6241 ARC WAY ADDRESS
PORT MYERS FL 33912
 CITY STATE ZIP
(239) 275-8875 PHONE NUMBER 05-02-05 DATE

SEND ORIGINAL TO:
 Department of Environmental Protection
 Bureau of Surveying and Mapping
 3900 Commonwealth Boulevard
 Mail Station 105
 Tallahassee, Florida 32399

D.E.P. USE ONLY

Processed: 5-9-05 S.M.
 B.L.M. - I.D. 400700
 QUAD - I.D. 2115 Fort Myers SE

EMBOSSSED SEAL OVER SIGNATURE