

**FLORIDA DEPARTMENT OF ENVIRONMENTAL PROTECTION
CERTIFIED CORNER RECORD**

DOC. # 084401

CORNER DESCRIPTION: MONUMENTATION DESCRIPTION (EVIDENCE FOUND OR METHOD TO SET)

Depict corner with ●

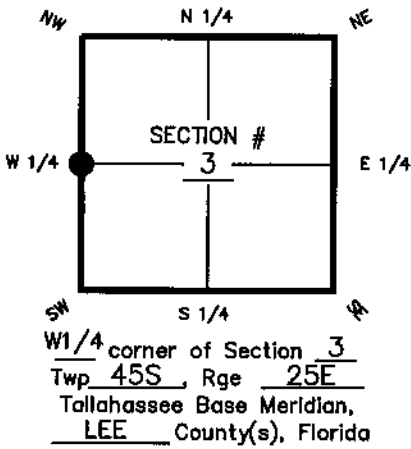

**FOUND TAPERED CONCRETE POST
PROJECTING 2'+/-
(SEE C.C.R. #3592)**

HORIZONTAL POSITION INFORMATION (if determined):

Latitude 26°-35'-27.07104" Longitude 81°-48'-25.02770"

Y(NORTHING-Ft.) 820495.767 X(EASTING-Ft.) 719252.803 Zone WEST

Convergence 0°-05'-11.1" Scale factor 0.99994574

Coordinate determination (circle one): Field traverse (GPS)

Horizontal datum (circle one): NAD27 NAD83(1986) (NAD83(1990)) other (explain)

Accuracy (circle one): 1st 2nd 3rd other 1:50,000

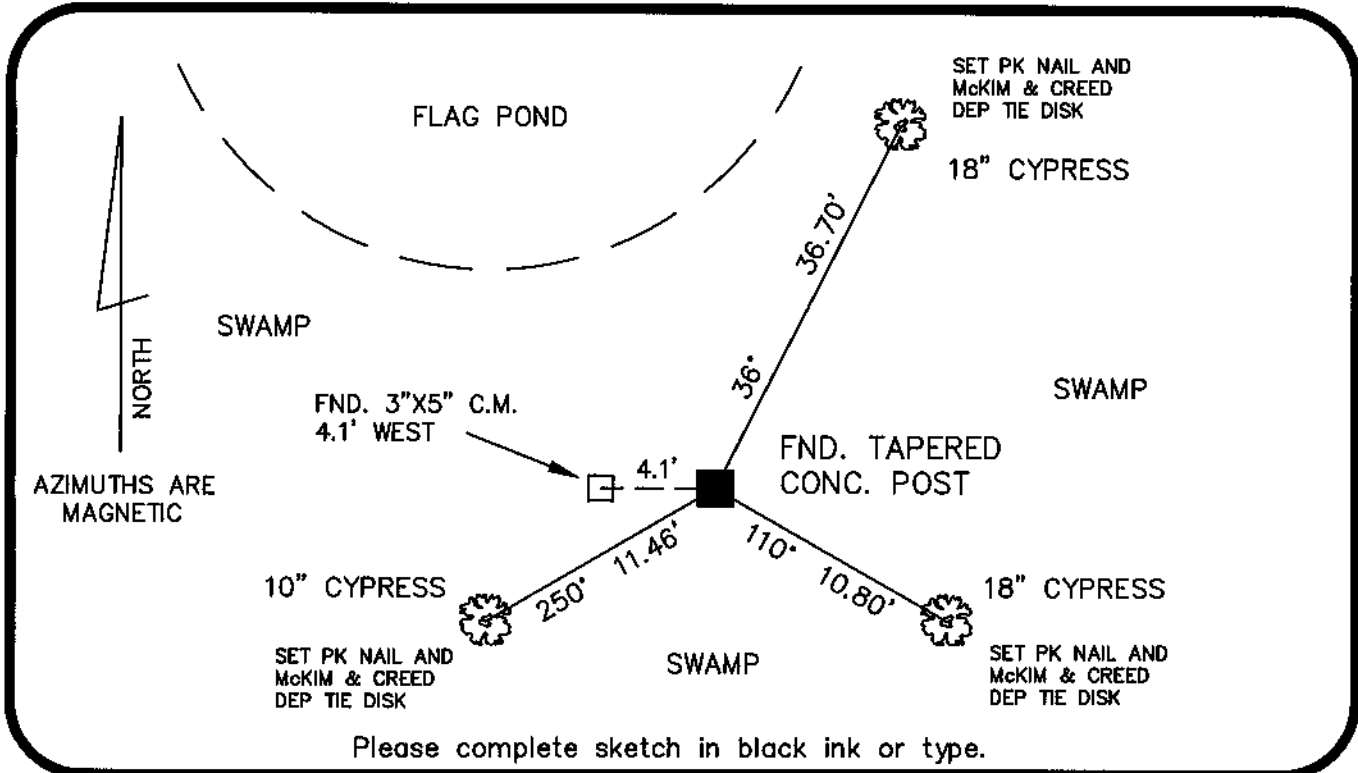

Please complete sketch in black ink or type.

SURVEYORS CERTIFICATE:

I certify the monument and accessories indicated above were field located on 7-06-04

(Signature)
 SIGNATURE
MCKIM & CREED
 FIRM OR AGENCY
6241 ARC-WAY
 ADDRESS
FORT MYERS FL 33912
 CITY STATE ZIP
(239) 275-8875 05-02-05
 PHONE NUMBER DATE

SEND ORIGINAL TO:
 Department of Environmental Protection
 Bureau of Surveying and Mapping
 3900 Commonwealth Boulevard
 Mail Station 105
 Tallahassee, Florida 32399

D.E.P. USE ONLY
 Processed: 5-9-05 S. um.
 B.L.M. - I.D. 400640
 QUAD - I.D. 2115 Fort Myers SE

EMBOSSSED SEAL OVER SIGNATURE