

FLORIDA DEPARTMENT OF ENVIRONMENTAL PROTECTION
CERTIFIED CORNER RECORD

DOC. # 087902

C-11

CORNER DESCRIPTION: MONUMENTATION DESCRIPTION (EVIDENCE FOUND OR METHOD TO SET)

Depict corner with 

FOUND 4"X4" CONCRETE MONUMENT (TOP BROKEN)

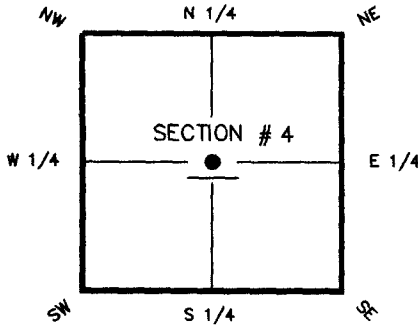

CNTR corner of Section 4
Twp 45 S, Rge 25 E
Tallahassee Base Meridian,
LEE County(s), Florida

HORIZONTAL POSITION INFORMATION (if determined):

Latitude 26° 35' 26.7030" N Longitude 81° 48' 54.2972" W

Y(NORTHING-Ft.) 820454.68 X(EASTING-Ft.) 716595.91 Zone FL W

Convergence ±00° 04' 58.0" Scale factor 0.999945363

Coordinate determination (circle one): Field traverse GPS

Horizontal datum (circle one): NAD27 NAD83(1986) NAD83(1990) other (explain)

Accuracy (circle one): 1st 2nd 3rd other

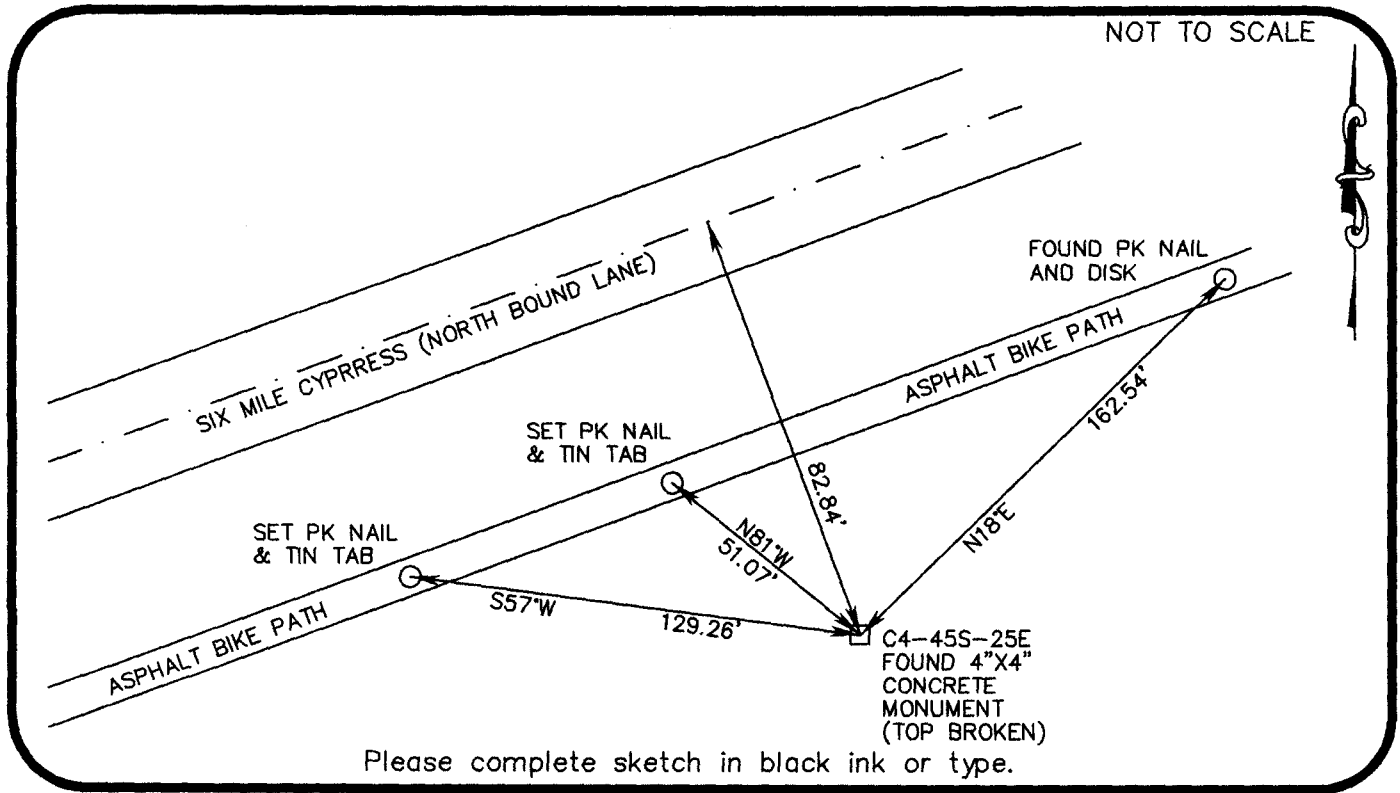

Please complete sketch in black ink or type.

SURVEYORS CERTIFICATE:

I certify the monument and accessories indicated above were field located on SEPTEMBER 22, 2005

Ken Pappalardo 6126
SIGNATURE PSM NO.
FIRM OR AGENCY LB NO.
2802 W CYPRESS AVE SE
ADDRESS
FT. MYERS FLORIDA 33905
CITY STATE ZIP
(239) 462-1901 3/10/06
PHONE NUMBER DATE

EMBOSSSED SEAL OVER SIGNATURE

SEND ORIGINAL TO:
Department of Environmental Protection
Bureau of Surveying and Mapping
3900 Commonwealth Boulevard
Mail Station 105
Tallahassee, Florida 32399

D.E.P. USE ONLY
Processed: W. J. ...
B.L.M. - I.D. 340640
QUAD - I.D. 215 Ft. Myers SE