

FLORIDA DEPARTMENT OF ENVIRONMENTAL PROTECTION
CERTIFIED CORNER RECORD

DOC. # 087912

J-9

CORNER DESCRIPTION: MONUMENTATION DESCRIPTION (EVIDENCE FOUND OR METHOD TO SET)

Depict corner with ●

FOUND CONCRETE MONUMENT 4"X4" WITH DISK STAMPED "STARNES & ASSOC. INC. PLS 2465"

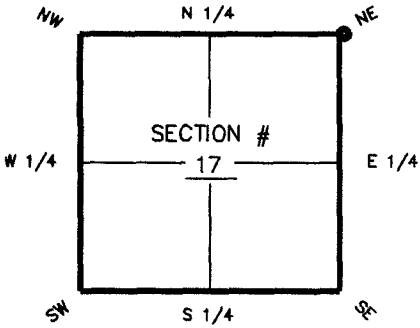

NE corner of Section 17
Twp 45 S, Rge 25 E
Tallahassee Base Meridian,
LEE County(s), Florida

HORIZONTAL POSITION INFORMATION (if determined):

Latitude 26° 34' 07.5787" N Longitude 81° 49' 21.7967" W
Y(NORTHING-Ft.) 812462.10 X(EASTING-Ft.) 714110.70 Zone FL W
Convergence ±00° 04' 45.5" Scale factor 0.99994503
Coordinate determination (circle one): Field traverse GPS
Horizontal datum (circle one): NAD27 NAD83(1986) NAD83(1990) other (explain)
Accuracy (circle one): 1st 2nd 3rd other _____

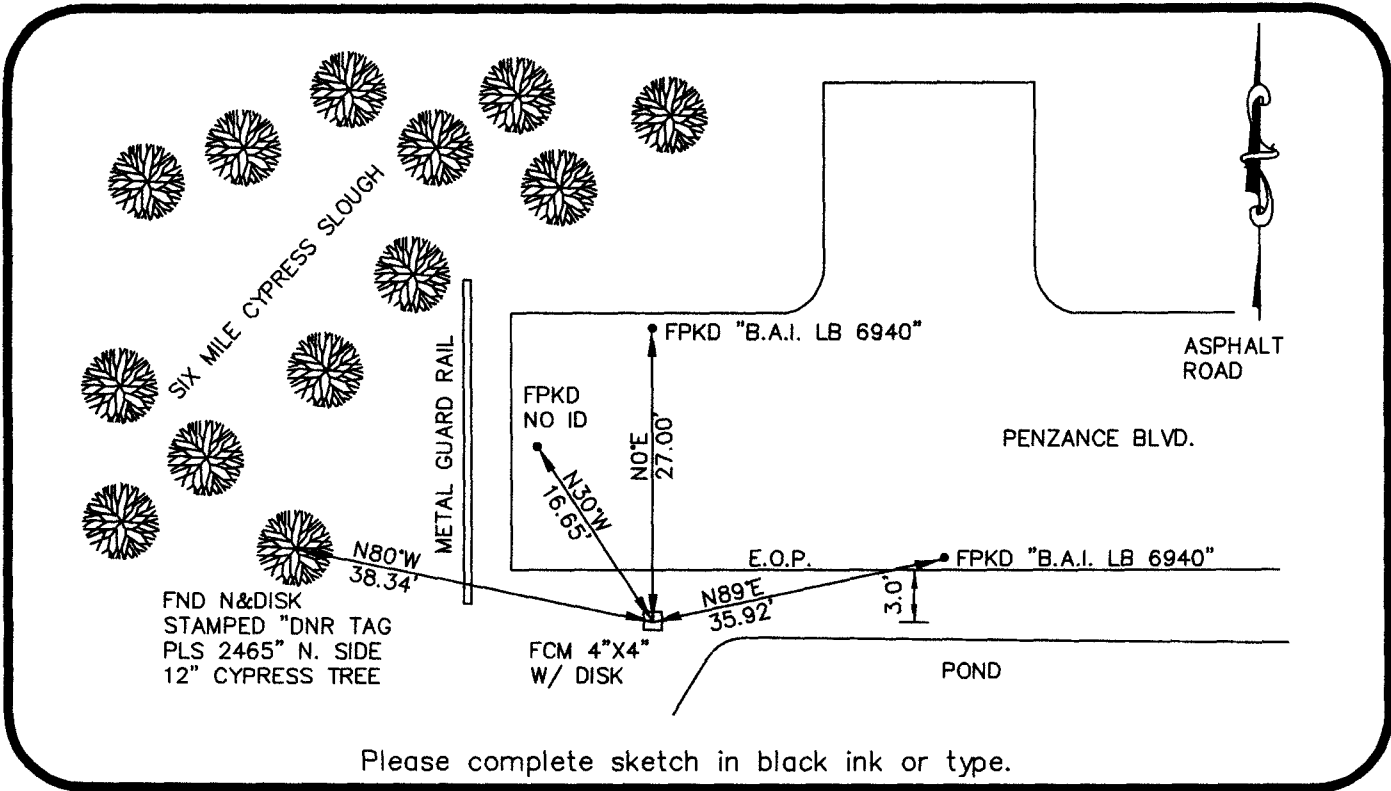

Please complete sketch in black ink or type.

SURVEYORS CERTIFICATE:

I certify the monument and accessories indicated above were field located on AUGUST 30, 2005

Kent Smith 6126
SIGNATURE PSM NO.
2802 W CYPRESS AVE SE LB NO.
ADDRESS
FT MYERS FLORIDA 33905
CITY STATE ZIP
(239) 462-1901 3/10/06
PHONE NUMBER DATE

SEND ORIGINAL TO:
Department of Environmental Protection
Bureau of Surveying and Mapping
3900 Commonwealth Boulevard
Mail Station 105
Tallahassee, Florida 32399

D.E.P. USE ONLY	
Processed:	<u>4720 WE</u>
B.L.M. - I.D.	<u>30500</u>
QUAD - I.D.	<u>25 10 10 05</u>

EMBOSSSED SEAL OVER SIGNATURE