

FLORIDA DEPARTMENT OF ENVIRONMENTAL PROTECTION
CERTIFIED CORNER RECORD

087923

DOC. # _____

P-3

CORNER DESCRIPTION: MONUMENTATION DESCRIPTION (EVIDENCE FOUND OR METHOD TO SET)

Depict corner with ●

FOUND P.K. AND DISK, NO IDENTIFICATION

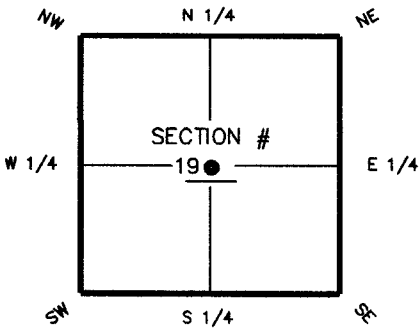

CTR corner of Section 19
Twp 45 S, Rge 25 E
Tallahassee Base Meridian,
LEE County(s), Florida

HORIZONTAL POSITION INFORMATION (if determined):

Latitude 26° 32' 47.6173" N Longitude 81° 50' 48.4051" W
Y(NORTHING-Ft.) 804378.42 X(EASTING-Ft.) 706256.95 Zone FL W
Convergence ±00° 04' 06.5" Scale factor 0.99994405
Coordinate determination (circle one): Field traverse (GPS)
Horizontal datum (circle one): NAD27 NAD83(1986) (NAD83(1990)) other (explain) _____
Accuracy (circle one): 1st (2nd) 3rd other _____

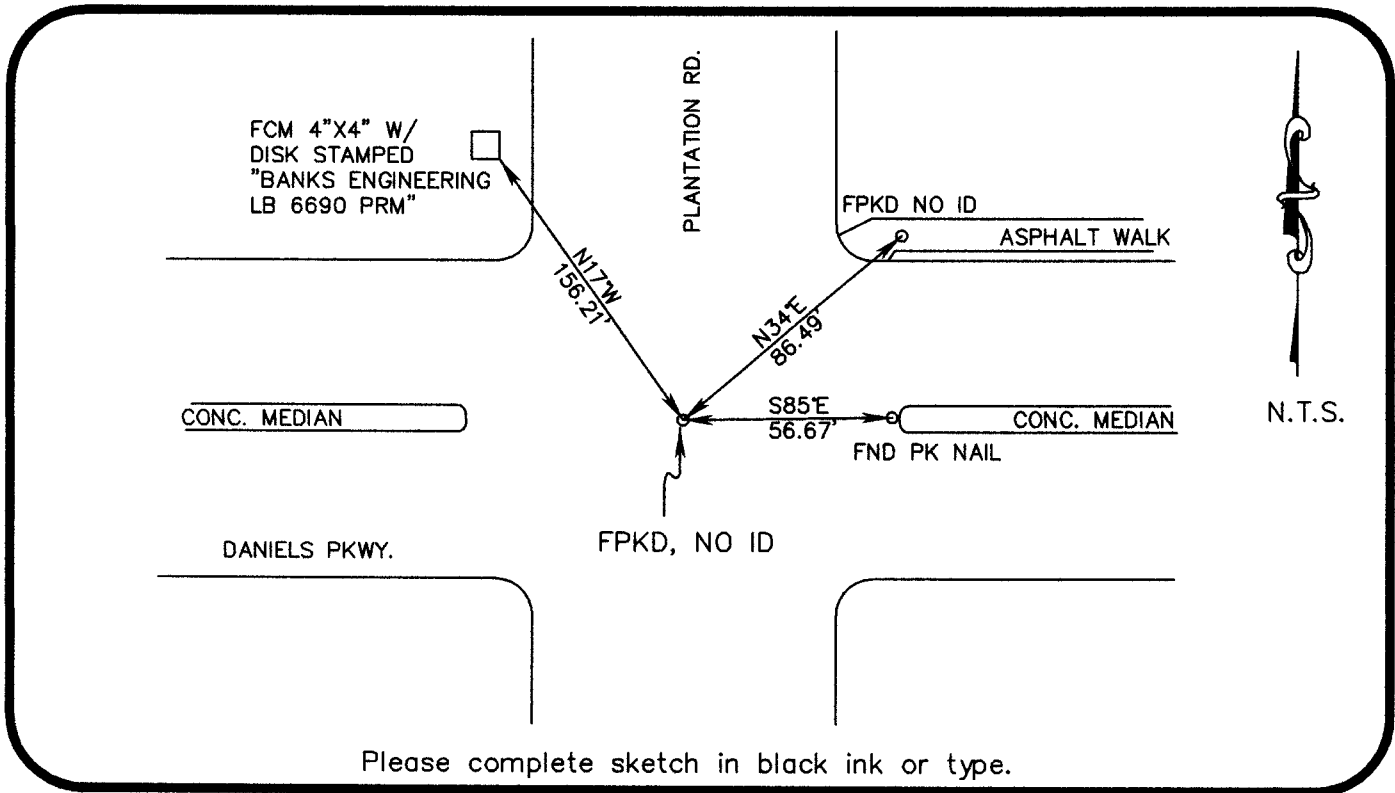

SURVEYORS CERTIFICATE:

I certify the monument and accessories indicated above were field located on SEPTEMBER 6, 2005

K. P. Pugh 6126
SIGNATURE PSM NO.
FIRM OR AGENCY LB NO.
2802 W. CYPRESS AVE SE
ADDRESS
FT. MYERS FL 33905
CITY STATE ZIP
(239) 462-1901 DATE 3/10/06
PHONE NUMBER

SEND ORIGINAL TO:
Department of Environmental Protection
Bureau of Surveying and Mapping
3900 Commonwealth Boulevard
Mail Station 105
Tallahassee, Florida 32399

D.E.P. USE ONLY	
Processed:	<u>6-1-06 DE</u>
B.L.M. - I.D.	<u>HU-40</u>
QUAD - I.D.	<u>33-40-11-10-2</u>

EMBOSSSED SEAL OVER SIGNATURE