

LAND CORNER RECORD

PUBLIC WORKS

LEE COUNTY, FLORIDA

Address - 1500 Monroe St., Ft. Myers, Fla. 33901

Phone : (239) 479-8900

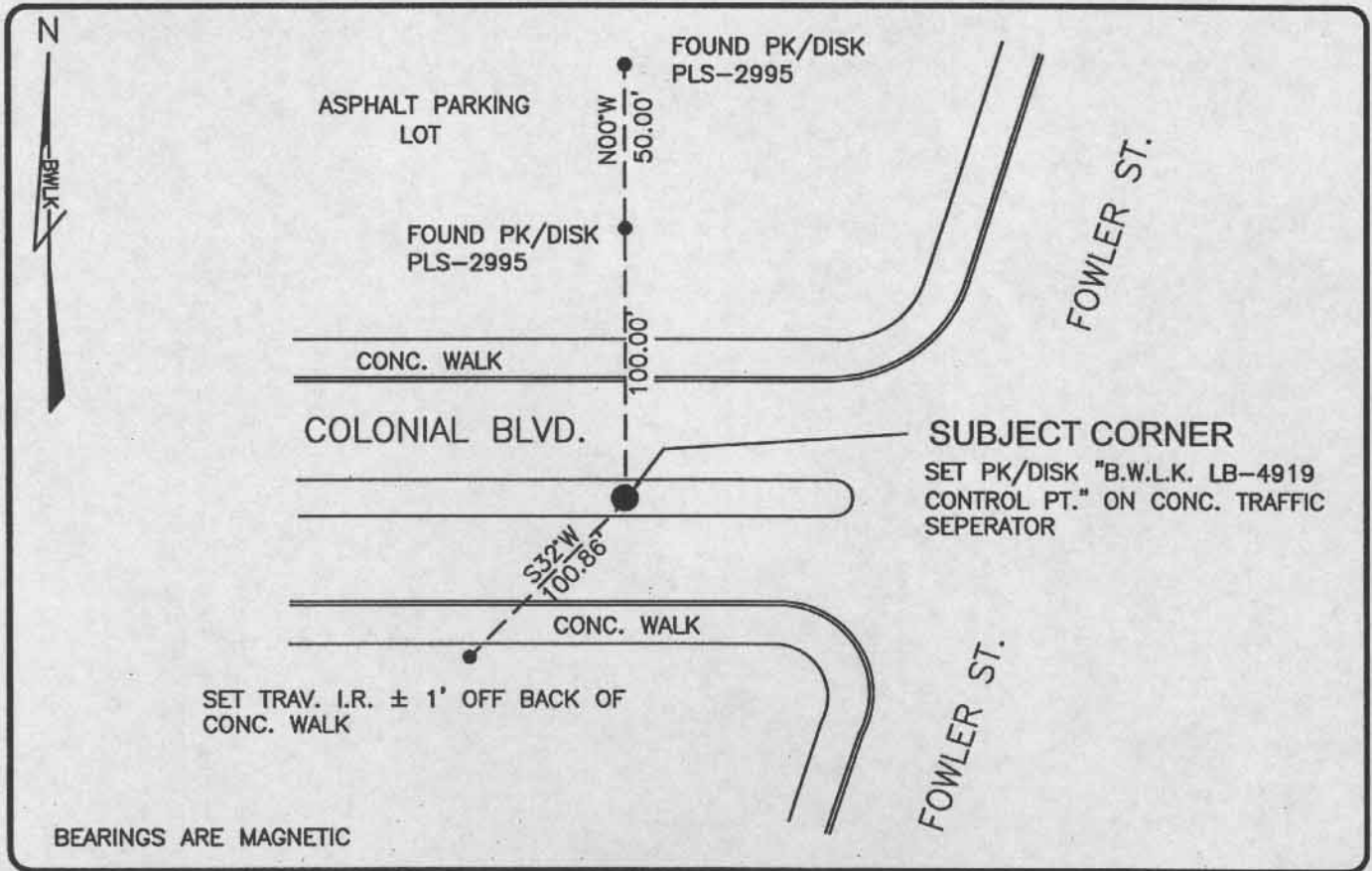

BEARINGS ARE MAGNETIC

COMMENTS:

RESET CORNER FROM REFERENCES RECOVERED IN FIELD.
MATCHED CO-ORDINATE VALUES ESTABLISHED IN CCR#37939.

CORNER DESCRIPTION

N1/4 Corner
Section 1
Township 45
Range 24

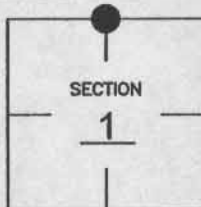

HORIZONTAL POSITION INFORMATION

Florida West Zone, NAD 1983(1990 Adjustment)

Northing(ft) 822759.38 Easting(ft) 700714.26

Latitude 26°35'49.72626" Longitude 81°51'49.22570"

Scale Factor 0.99994

EXISTING CERTIFIED CORNER RECORDS

Document No.	Date
<u>37939</u>	<u>1-24-91</u>
<u>38394</u>	<u>2-11-91</u>

The above documents are based on FDEP Bureau of Surveying and Mapping Record Information.

I hereby certify the monument and accessories shown above were field located on 1-09-04.

Scott C. Whitaker
SCOTT C. WHITAKER
Professional Surveyor and Mapper
Florida Certificate No. 4324
Date Signed 3-03-04

BEAN, WHITAKER, LUTZ & KAREH, INC. (LB 4919)
13041 McGregor Boulevard
Fort Myers, Florida 33919-5910
Phone: (239) 481-1331

POINT NO. 5011

BLM REFERENCE NO. T45SR24E640700