

# FLORIDA DEPARTMENT OF ENVIRONMENTAL PROTECTION

## CERTIFIED CORNER RECORD

DOC. # \_\_\_\_\_

P-23A

CORNER DESCRIPTION: \_\_\_\_\_ MONUMENTATION DESCRIPTION (EVIDENCE FOUND OR METHOD TO SET) \_\_\_\_\_

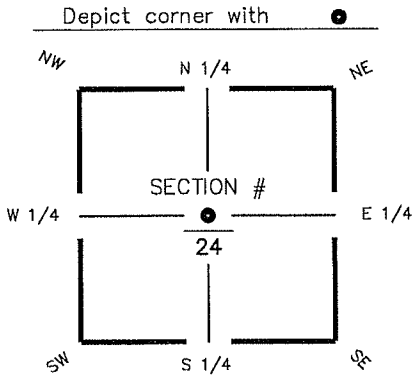

FOUND 60d NAIL  
NO ID  
IN CUT-OUT

HORIZONTAL POSITION INFORMATION ( if determined ):

Latitude 26° 32' 46.81439" N Longitude 81° 51' 47.95762" W  
 Y(NORTHING-Ft.) 804291.24 X(EASTING-Ft.) 700849.07 Zone FL W  
 Convergence 00° 03' 39.9" Scale factor 0.99994346

CENTER corner of Section 24  
 Twp 45 S, Rge 24 E  
 Tallahassee Base Meridian,  
LEE County(s), Florida

Coordinate determination (circle one): Field traverse  GPS  
 Horizontal datum (circle one): NAD27 NAD83(1986) NAD83(1990)  other (explain)  
 Accuracy (circle one): 1st  2nd 3rd other NAD83 (1999)

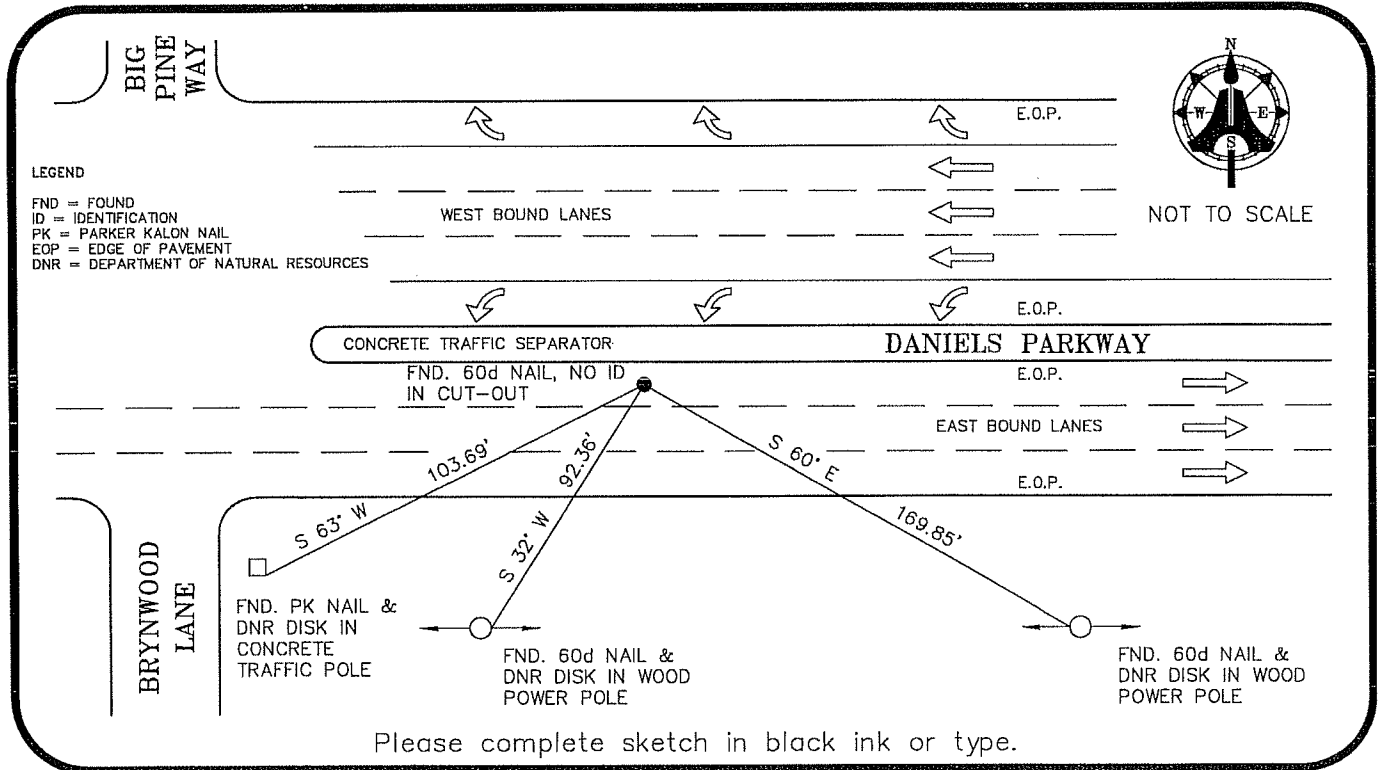

SURVEYORS CERTIFICATE:

I certify the monument and accessories indicated above were field located on MARCH 9, 2007

\_\_\_\_\_  
 SIGNATURE PSM NO. 5688  
AIM-ENGINEERING & SURVEYING, INC. LB NO. LB 3114  
 FIRM OR AGENCY LB NO.  
5300 LEE BOULEVARD  
 ADDRESS  
LEHIGH ACRES, FLORIDA 33971-1026  
 CITY STATE ZIP  
(239) 332-4569 3/29/07  
 PHONE NUMBER DATE

SEND ORIGINAL TO:  
 Department of Environmental Protection  
 Bureau of Surveying and Mapping  
 3900 Commonwealth Boulevard  
 Mail Station 105  
 Tallahassee, Florida 32399

D.E.P. USE ONLY	
Processed: _____	
B.L.M. - I.D. <u>640 340</u>	
QUAD - I.D. _____	

EMBOSSSED SEAL OVER SIGNATURE