

# FLORIDA DEPARTMENT OF ENVIRONMENTAL PROTECTION CERTIFIED CORNER RECORD

DOC. # 094489

**CORNER DESCRIPTION:**

**MONUMENTATION DESCRIPTION (EVIDENCE FOUND OR METHOD TO SET)**

Depict corner with

SET 5/8" IRON ROD WITH CAP "LB6566". POSITION DETERMINED BY SINGLE PROPORTION MEASUREMENT.

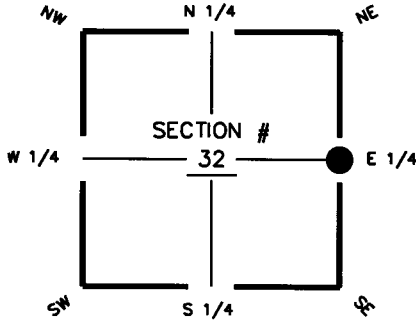

E 1/4 corner of Section 32  
Twp 44 S, Rge 27 E  
Tallahassee Base Meridian,  
LEE County(s), Florida

**HORIZONTAL POSITION INFORMATION ( if determined ):**

Latitude 26° 36' 24.2900" N. Longitude 81° 37' 47.7886" W.  
Y(NORTHING-Ft.) 826400.380 X(EASTING-Ft.) 777081.863 Zone WEST  
Convergence 0° 09' 56.6568" Scale factor 0.999957939  
Coordinate determination (circle one): Field traverse  GPS  
Horizontal datum (circle one): NAD27 NAD83(1986)  NAD83(1999) other (explain)  
Accuracy (circle one): 1st 2nd 3rd  other 1:50,000

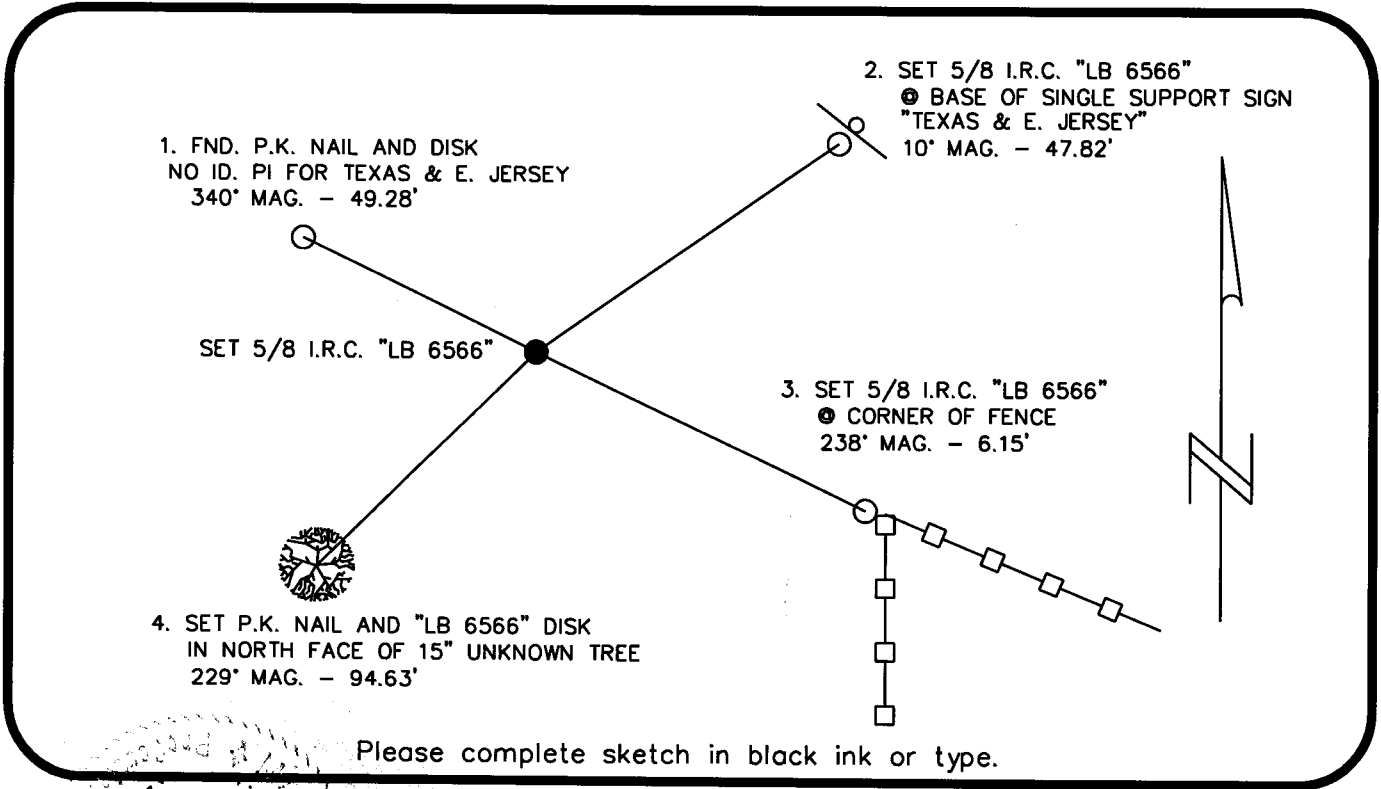

Please complete sketch in black ink or type.

**SURVEYORS CERTIFICATE:**

I certify the monument and accessories indicated above were field located on 04/29/08

SIGNATURE: [Signature] 6541  
 FIRM OR AGENCY: McKIM & CREED, PA PSM NO. 6566  
 ADDRESS: 10970 S. CLEVELAND AVENUE, SUITE 401 LB NO.  
 CITY: FORT MYERS STATE: FLORIDA ZIP: 33907  
 PHONE NUMBER: (239) 275-8875 DATE: 5-22-2008

SEND ORIGINAL TO:  
Department of Environmental Protection  
Bureau of Surveying and Mapping  
3900 Commonwealth Boulevard  
Mail Station 105  
Tallahassee, Florida 32399

D.E.P. USE ONLY  
 Processed: 6-1-08 MB  
 B.L.M. - I.D. 300140  
 QUAD - I.D. 2114 Alva SW

EMBOSSSED SEAL OVER SIGNATURE