

**FLORIDA DEPARTMENT OF ENVIRONMENTAL PROTECTION
CERTIFIED CORNER RECORD**

DOC. # 102116

CORNER DESCRIPTION:

Depict corner with 



S 1/4 corner of Section 31
TWP 44 S RGE 26 E
Tallahassee Base Meridian,
LEE County(s), Florida

MONUMENTATION DESCRIPTION (EVIDENCE FOUND OR METHOD TO SET)

SET 5/8" IRON ROD AND CAP "FDOT LB1221"

HORIZONTAL POSITION INFORMATION (if determined):

Latitude 26° 35' 55.22702" N Longitude 81° 45' 03.20115" W
Y(NORTHING-Ft.) 823370.286 X(EASTING-Ft.) 737568.143 Zone FL-WEST
Convergence 0° 06' 41.5" Scale factor 0.999948774
Coordinate determination (circle one): Field traverse GPS
Horizontal datum (circle one): NAD27 NAD83(1986) NAD83(1999) other (explain)
Accuracy (circle one): 1st 2nd 3rd other _____

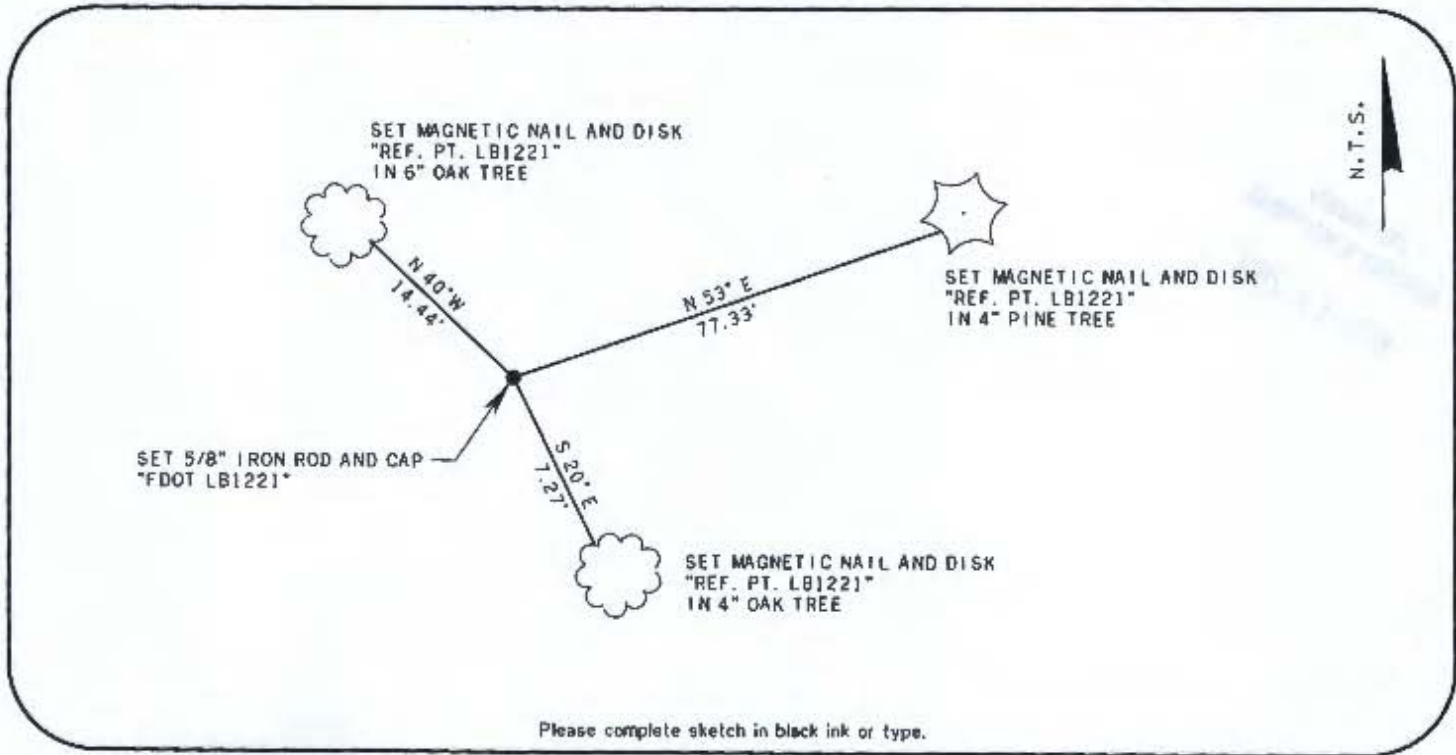

Please complete sketch in black ink or type.

SURVEYORS CERTIFICATE:

I certify the monument and accessories indicated above were field located on

OCTOBER 4, 2011

Signature: William R. Hinkle 4633
Firm or Agency: BOWYER-SINGLETON & ASSOC. INC. 1221
Address: 520 SOUTH MAGNOLIA AVE.
City: ORLANDO STATE: FLORIDA ZIP: 32801
Phone Number: 407-849-5120 DATE: NOVEMBER 11, 2011

SEND ORIGINAL TO:
Department of Environmental Protection
Bureau of Surveying and Mapping
3900 Commonwealth Boulevard
Mail Station 105
Tallahassee, Florida 32399

| | | |
|------------------|--------------------------------------|-------------|
| Processed: | D. E. P. USE ONLY <u>11-18-11</u> | <u>YILE</u> |
| B. L. M. - I. D. | <u>1A0100</u> | |
| QUAD - I. D. | <u>211A ALVA SW</u> | |

EMBOSSSED SEAL OVER SIGNATURE