

FLORIDA DEPARTMENT OF ENVIRONMENTAL PROTECTION CERTIFIED CORNER RECORD

DOC. # _____

G-15

CORNER DESCRIPTION: MONUMENTATION DESCRIPTION (EVIDENCE FOUND OR METHOD TO SET)

Depict corner with ●

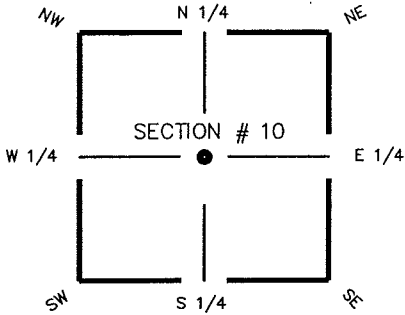

SIRC 5/8" "LB 3114, 0.8' BELOW GROUND.

HORIZONTAL POSITION INFORMATION (if determined):

Latitude 26° 39' 48.8933" N Longitude 81° 48' 00.4618" W
 Y(NORTHING-Ft.) 846935.20 X(EASTING-Ft.) 721442.71 Zone FL W
 Convergence 00° 05' 22.9009" Scale factor 0.99994606

CENTER corner of Section 10
 Twp 44S, Rge 25 E
 Tallahassee Base Meridian,
LEE County(s), Florida

Coordinate determination (circle one): Field traverse GPS
 Horizontal datum (circle one): NAD27 NAD83(1986) NAD83(1990) other (explain)
 Accuracy (circle one): 1st 2nd 3rd other _____

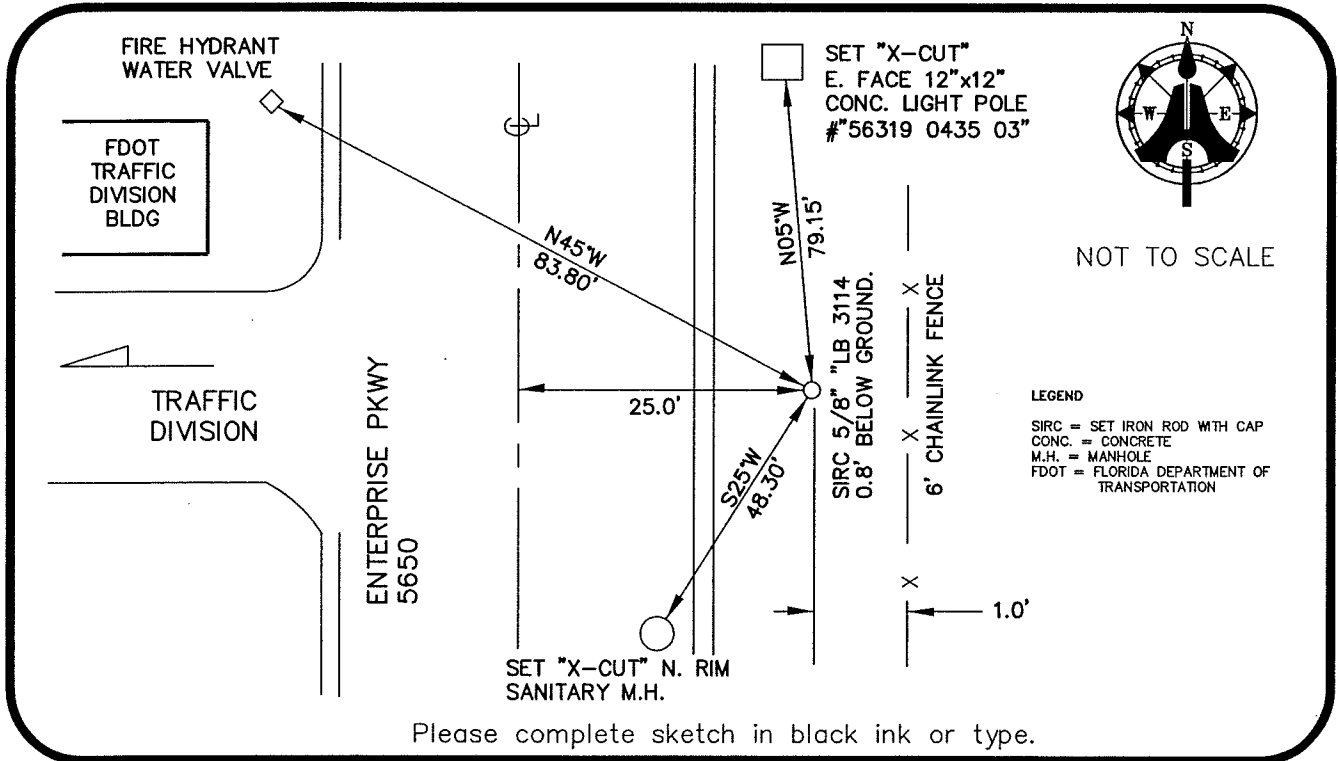

Please complete sketch in black ink or type.

SURVEYORS CERTIFICATE:

I certify the monument and accessories indicated above were field located on MAY 27, 2005

[Signature] 5688
 SIGNATURE PSM NO.
AIM ENGINEERING & SURVEYING, INC. LB 3114
 FIRM OR AGENCY LB NO.
5300 LEE BOULEVARD
 ADDRESS
LEHIGH ACRES, FLORIDA 33971-1026
 CITY STATE ZIP
(239) 332-4569 12/01/05
 PHONE NUMBER DATE

SEND ORIGINAL TO:
 Department of Environmental Protection
 Bureau of Surveying and Mapping
 3900 Commonwealth Boulevard
 Mail Station 105
 Tallahassee, Florida 32399

D.E.P. USE ONLY	
Processed:	_____
B.L.M. - I.D.	_____
QUAD - I.D.	_____

EMBOSSSED SEAL OVER SIGNATURE