

FLORIDA DEPARTMENT OF ENVIRONMENTAL PROTECTION CERTIFIED CORNER RECORD

DOC. # _____

G-7

CORNER DESCRIPTION: _____ MONUMENTATION DESCRIPTION (EVIDENCE FOUND OR METHOD TO SET) _____

Depict corner with

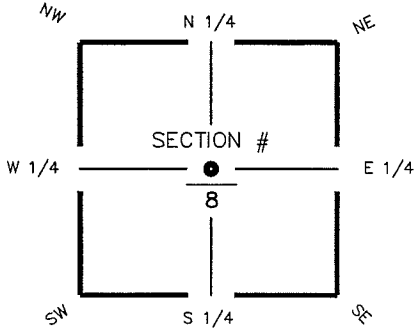

CENTER corner of Section 8
Twp 44 S, Rge 25 E
Tallahassee Base Meridian,
LEE County(s), Florida

CORNER FALLS IN MANHOLE
SET STRADDLE POINTS
AROUND MANHOLE
SET P.K. NAIL & DISK
"AIM ENG. LB 3114"

HORIZONTAL POSITION INFORMATION (if determined):

Latitude 26° 39' 47.0822" N Longitude 81° 49' 57.1108" W
Y(NORTHING-Ft.) 846737.05 X(EASTING-Ft.) 710859.55 Zone FL W
Convergence 00° 04' 30.5" Scale factor 0.99994461

Coordinate determination (circle one): Field traverse GPS
Horizontal datum (circle one): NAD27 NAD83(1986) NAD83(1990) other (explain) _____
Accuracy (circle one): 1st 2nd 3rd other _____

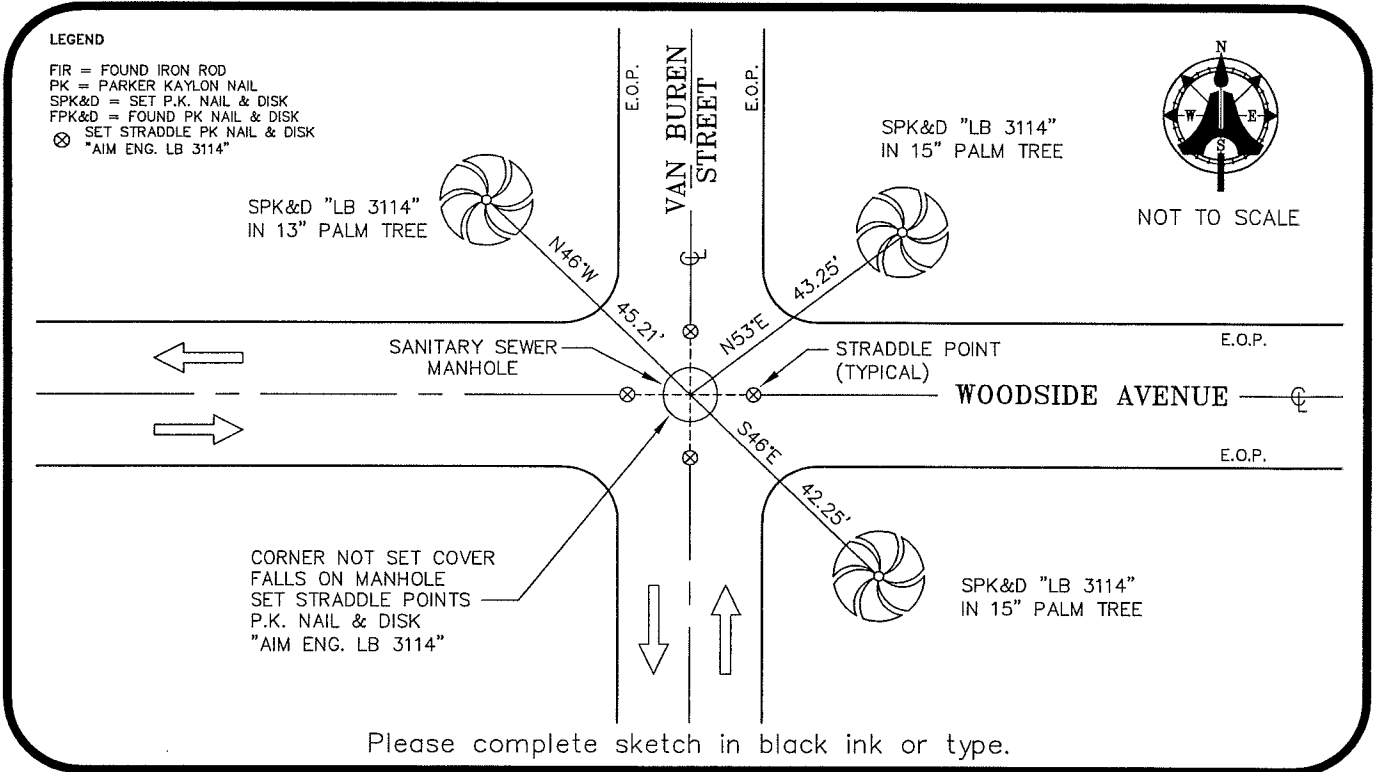

SURVEYORS CERTIFICATE:

I certify the monument and accessories indicated above were field located on AUGUST 21, 2006

SIGNATURE

5688
PSM NO.

AIM ENGINEERING & SURVEYING, INC. LB 3114
FIRM OR AGENCY LB NO.

5300 LEE BOULEVARD
ADDRESS

LEHIGH ACRES, FLORIDA 33971-1026
CITY STATE ZIP

(239) 332-4569 9/14/06
PHONE NUMBER DATE

SEND ORIGINAL TO:
Department of Environmental Protection
Bureau of Surveying and Mapping
3900 Commonwealth Boulevard
Mail Station 105
Tallahassee, Florida 32399

	D.E.P. USE ONLY
Processed: _____	
B.L.M. - I.D. <u>240 540</u>	
QUAD - I.D. _____	

EMBOSSSED SEAL OVER SIGNATURE