

FLORIDA DEPARTMENT OF ENVIRONMENTAL PROTECTION CERTIFIED CORNER RECORD

P-13

DOC. # 080948

CORNER DESCRIPTION: MONUMENTATION DESCRIPTION (EVIDENCE FOUND OR METHOD TO SET)

Depict corner with

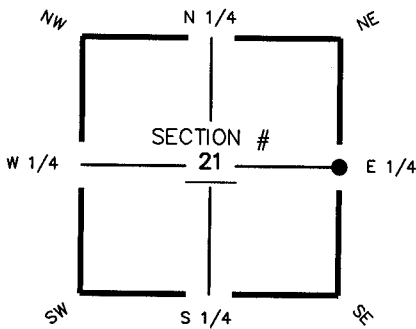

SET P.K. NAIL AND DISK
"LB 3114"
RESET PER PLAT BOOK 22,
PAGE 107

HORIZONTAL POSITION INFORMATION (if determined):

Latitude 26° 37' 49.5684" N Longitude 82° 00' 25.8618" W
 Y(NORTHING-Ft.) 834836.00 X(EASTING-Ft.) 653819.88 Zone FL W
 Convergence -00° 00' 11.6" Scale factor 0.99994118
 Coordinate determination (circle one): Field traverse GPS
 Horizontal datum (circle one): NAD27 NAD83(1986) NAD83(1990) other (explain)
 Accuracy (circle one): 1st 2nd 3rd other _____

E 1/4 corner of Section 21
Twp 44 S, Rge 23 E
Tallahassee Base Meridian,
LEE County(s), Florida

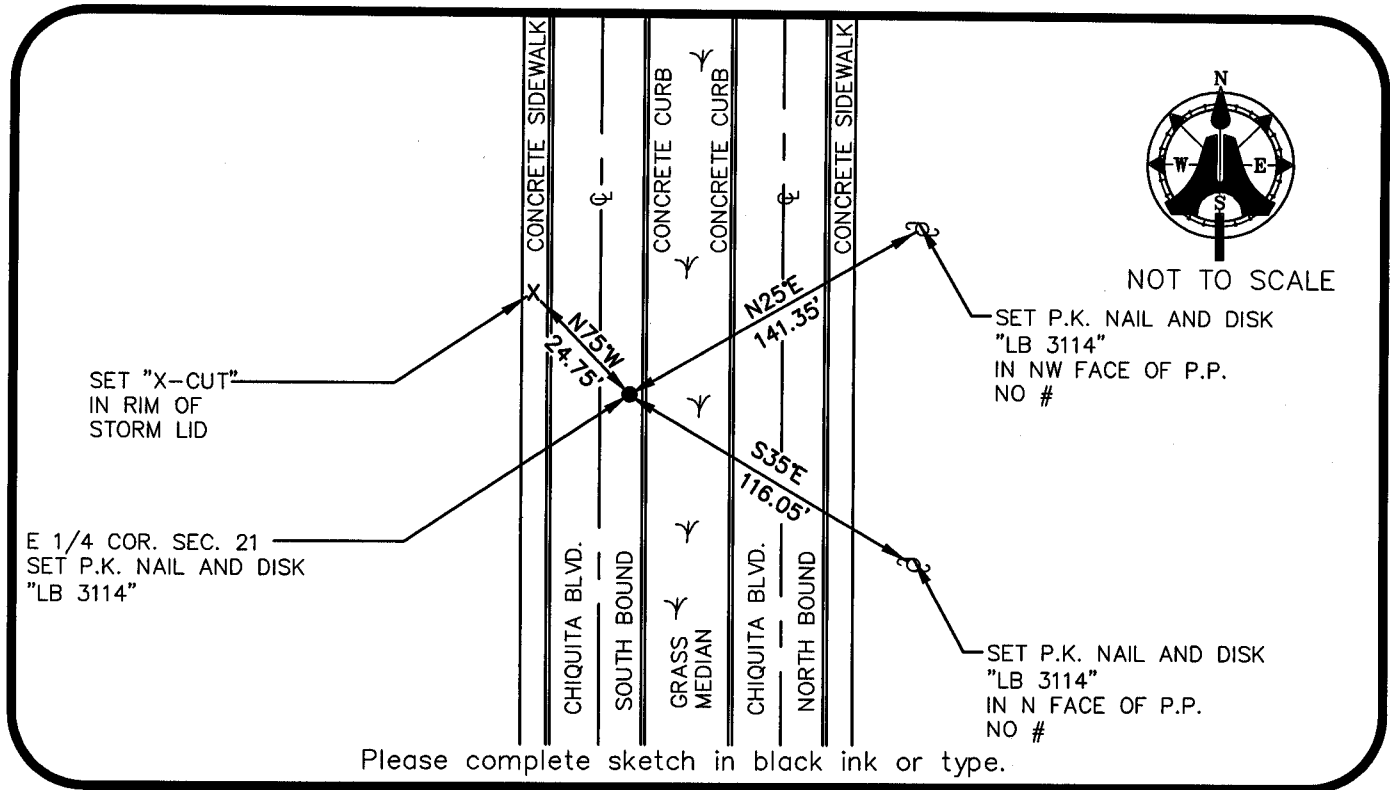

SURVEYORS CERTIFICATE:

I certify the monument and accessories indicated above were field located on JUNE 30, 2003

[Signature]
 SIGNATURE
AM ENGINEERING & SURVEYING, INC.
 FIRM OR AGENCY
 5300 LEE BOULEVARD
 ADDRESS
 LEHIGH ACRES, FLORIDA 33971-1026
 CITY STATE ZIP
 (239) 332-4569 12/20/2003
 PHONE NUMBER DATE

SEND ORIGINAL TO:
 Department of Environmental Protection
 Bureau of Surveying and Mapping
 3900 Commonwealth Boulevard
 Mail Station 105
 Tallahassee, Florida 32399

D.E.P. USE ONLY
 Processed: 12-31-2003 CH
 B.L.M. - I.D. 400 340
 QUAD - I.D. 2217 Matlacha

EMBOSSSED SEAL OVER SIGNATURE