

# FLORIDA DEPARTMENT OF ENVIRONMENTAL PROTECTION CERTIFIED CORNER RECORD

**080951**

R-9

DOC. # \_\_\_\_\_

CORNER DESCRIPTION:      MONUMENTATION DESCRIPTION (EVIDENCE FOUND OR METHOD TO SET)

Depict corner with

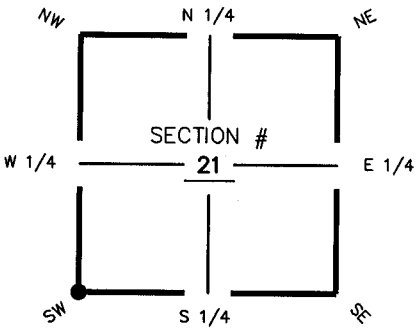

**FOUND 5/8" IRON ROD & CAP  
"LB 6611"**

HORIZONTAL POSITION INFORMATION ( if determined ):

Latitude 26° 37' 21.8804" N      Longitude 82° 01' 24.0245" W  
 Y(NORTHING-Ft.) 832041.01      X(EASTING-Ft.) 648541.46      Zone FL W  
 Convergence -00° 00' 37.7"      Scale factor 0.99994124  
 Coordinate determination (circle one):      Field traverse  GPS  
 Horizontal datum (circle one):      NAD27      NAD83(1986)       NAD83(1990)      other (explain) \_\_\_\_\_  
 Accuracy (circle one):      1st       2nd      3rd      other \_\_\_\_\_

SW corner of Section 21  
Twp 44 S, Rge 23 E  
 Tallahassee Base Meridian,  
LEE County(s), Florida

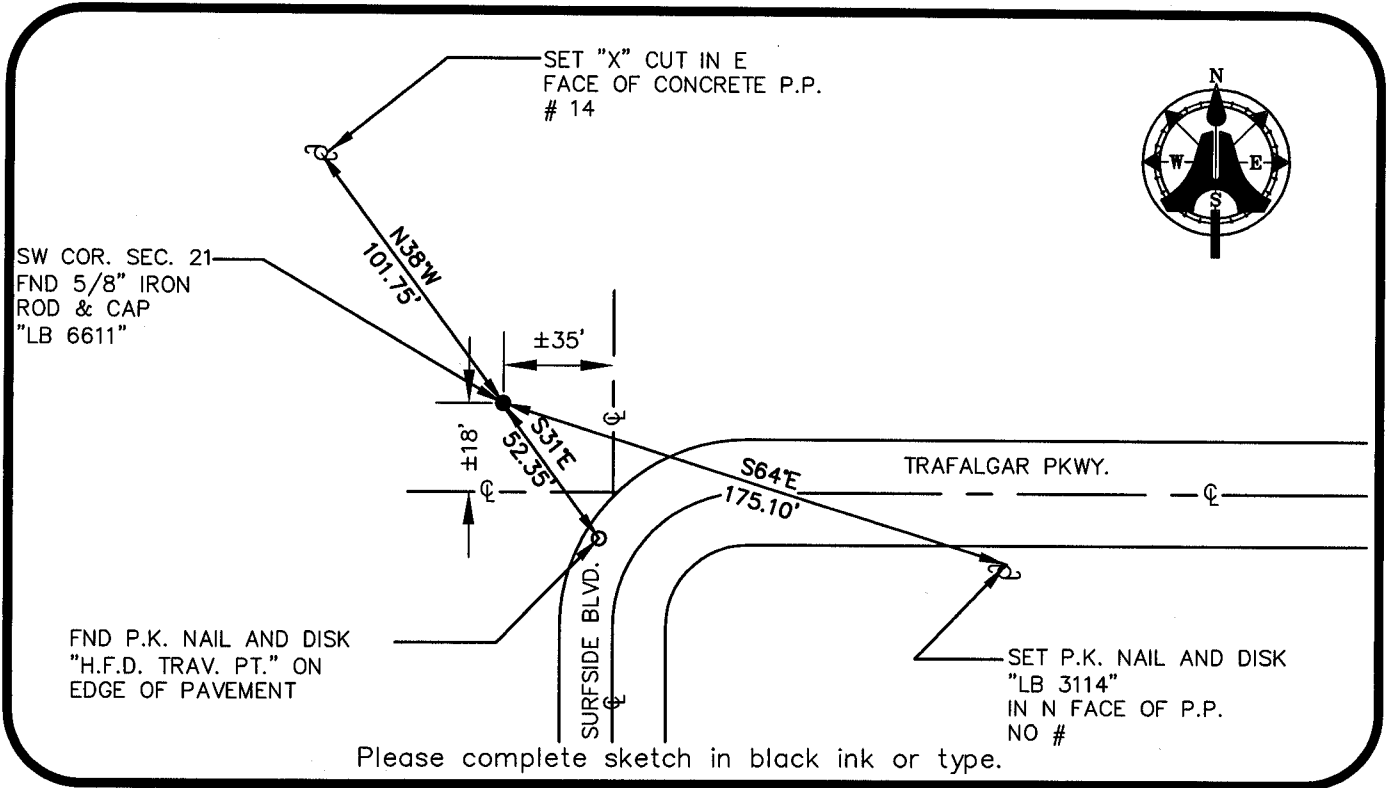

Please complete sketch in black ink or type.

SURVEYORS CERTIFICATE:

I certify the monument and accessories indicated above were field located on MAY 27, 2003

\_\_\_\_\_  
 SIGNATURE      **5688**      PSM NO.  
**AM ENGINEERING & SURVEYING, INC.**      **LB 3114**      LB NO.  
 FIRM OR AGENCY  
**5300 LEE BOULEVARD**      ADDRESS  
**LEHIGH ACRES, FLORIDA 33971-1026**  
 CITY      STATE      ZIP  
**(239) 332-4569**      12/20/2003  
 PHONE NUMBER      DATE

SEND ORIGINAL TO:  
 Department of Environmental Protection  
 Bureau of Surveying and Mapping  
 3900 Commonwealth Boulevard  
 Mail Station 105  
 Tallahassee, Florida 32399

D.E.P. USE ONLY

Processed: 12-31-2003 CH  
 B.L.M. - I.D. 300 300  
 QUAD - I.D. 2117 Pine Island Center

EMBOSSSED SEAL OVER SIGNATURE