

FLORIDA DEPARTMENT OF ENVIRONMENTAL PROTECTION CERTIFIED CORNER RECORD

N-1

DOC. # 080939

CORNER DESCRIPTION: MONUMENTATION DESCRIPTION (EVIDENCE FOUND OR METHOD TO SET)

Depict corner with

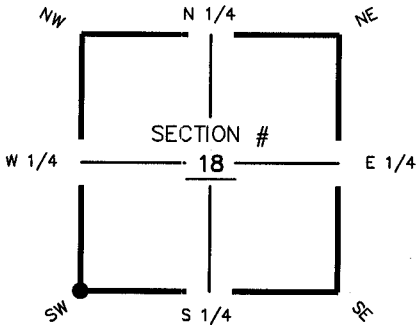

FOUND 1/2" IRON ROD & CAP,
"LB 3377"

HORIZONTAL POSITION INFORMATION (if determined):

Latitude 26° 38' 16.6701" N Longitude 82° 03' 21.4149" W
 Y(NORTHING-Ft.) 837576.36 X(EASTING-Ft.) 637890.73 Zone FL W
 Convergence -00° 01' 30.3" Scale factor 0.99994156
 Coordinate determination (circle one): Field traverse GPS
 Horizontal datum (circle one): NAD27 NAD83(1986) NAD83(1990) other (explain)
 Accuracy (circle one): 1st 2nd 3rd other

SW corner of Section 18
 Twp 44 S, Rge 23 E
 Tallahassee Base Meridian,
LEE County(s), Florida

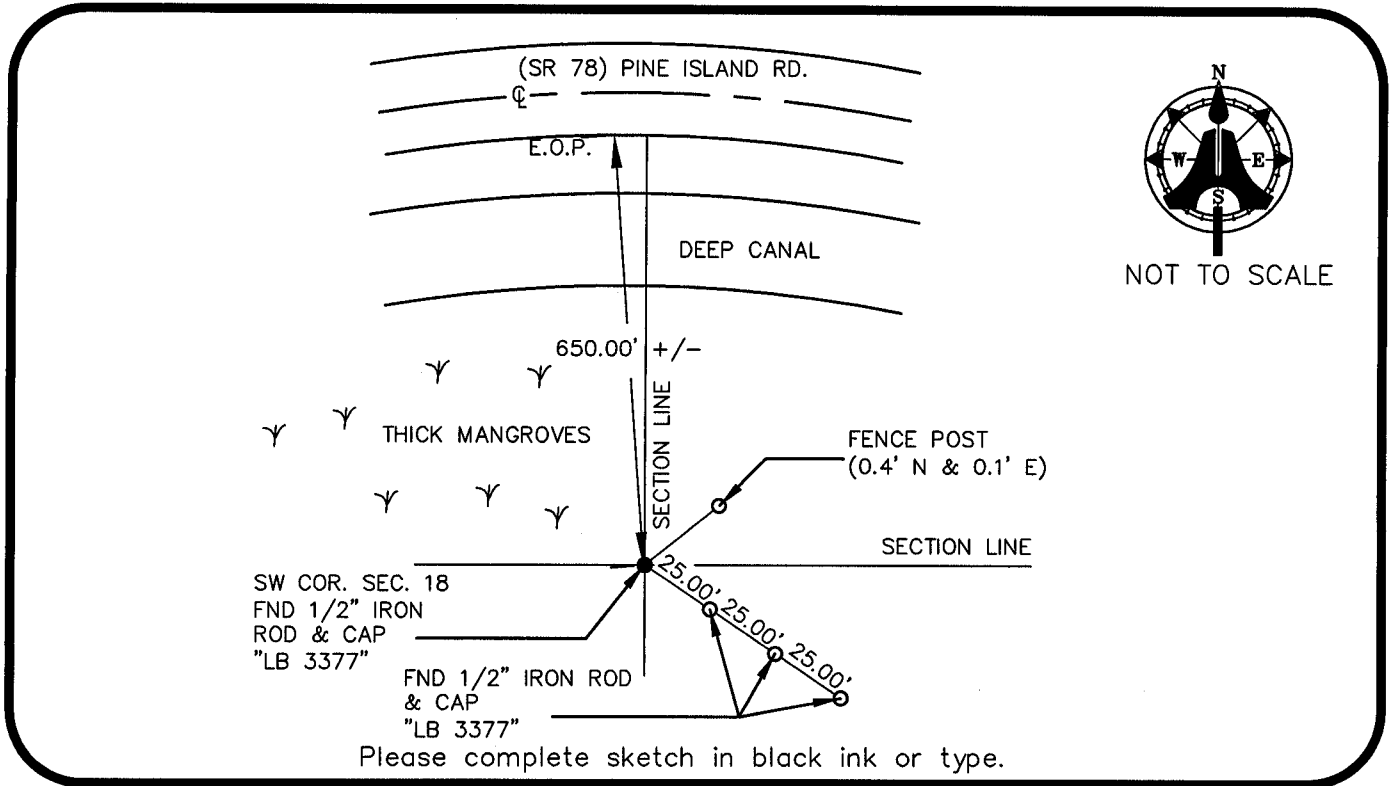

Please complete sketch in black ink or type.

SURVEYORS CERTIFICATE:

I certify the monument and accessories indicated above were field located on MAY 30, 2003

[Signature]
 SIGNATURE
AM ENGINEERING & SURVEYING, INC. PSM NO. **5688**
 FIRM OR AGENCY LB NO. **3114**
5300 LEE BOULEVARD
 ADDRESS
LEHIGH ACRES, FLORIDA 33971-1026
 CITY STATE ZIP
(239) 332-4569 DATE **12/20/2003**
 PHONE NUMBER

SEND ORIGINAL TO:
 Department of Environmental Protection
 Bureau of Surveying and Mapping
 3900 Commonwealth Boulevard
 Mail Station 105
 Tallahassee, Florida 32399

D.E.P. USE ONLY
 Processed: 12-31-2003 CH
 B.L.M. - I.D. 100400
 QUAD - I.D. 2217 Matlacha

EMBOSSSED SEAL OVER SIGNATURE