

# FLORIDA DEPARTMENT OF ENVIRONMENTAL PROTECTION

## CERTIFIED CORNER RECORD

11

DOC. # \_\_\_\_\_  
 BLM. # T43SR26E400140

**CORNER DESCRIPTION:** MONUMENTATION DESCRIPTION (EVIDENCE FOUND OR METHOD TO SET)

Depict corner with

SET 5/8" IRON ROD WITH CAP AIM ENG LB 3114  
 USING COORDINATE VALUES PER CCR DOC #083357  
 ADJUSTING VALUES FROM 1990 TO 2007

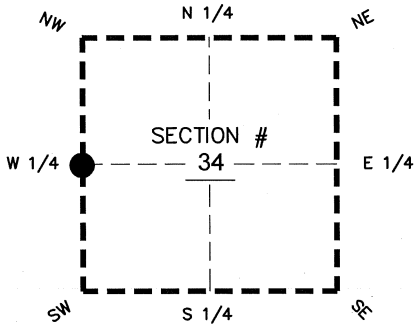

W 1/4 corner of Section 34  
 Twp 43 S, Rge 26 E  
 Tallahassee Base Meridian,  
LEE County(s), Florida

**PRIOR CCR'S:**

DOC. # 083357

**HORIZONTAL POSITION INFORMATION ( if determined ):**

Latitude 26°41'35.4173" N Longitude 81°42'43.6642" W  
 Y(NORTHING-Ft.) 857745.78 X(EASTING-Ft.) 750156.42 Zone WEST  
 Convergence 00°07'45.5" Scale factor 0.99995130  
 Coordinate determination: GPS  
 Horizontal datum: NAD83(NSRS2007)  
 Accuracy (circle one): 1st 2nd 3rd other 1:35,000

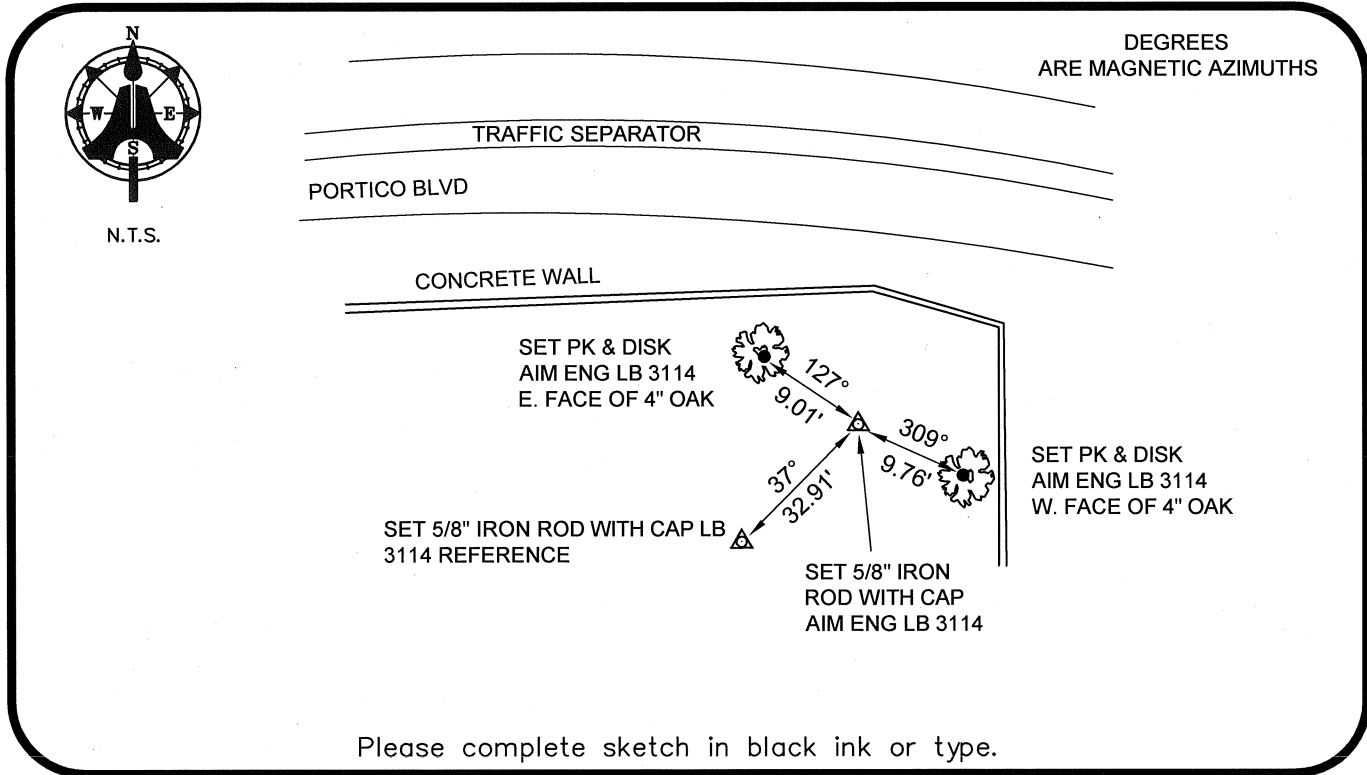

Please complete sketch in black ink or type.

**SURVEYORS CERTIFICATE:**

I certify the monument and accessories indicated above were field located on 03-18-2008

BEN R. HOMOLA

*Ben R. Homola* 3950  
 SIGNATURE PSM NO.  
 AIM ENGINEERING & SURVEYING, INC. 3114  
 FIRM OR AGENCY LB NO.

5300 LEE BOULEVARD  
 LEHIGH ACRES ADDRESS FL 33971  
 CITY STATE ZIP  
 (239)332-4569 07/30/2008  
 PHONE NUMBER DATE

EMBOSSSED SEAL OVER SIGNATURE

SEND ORIGINAL TO:  
 Department of Environmental Protection  
 Bureau of Surveying and Mapping  
 3900 Commonwealth Boulevard  
 Mail Station 105  
 Tallahassee, Florida 32399

<b>D.E.P. USE ONLY</b>
Processed: _____
B.L.M. - I.D. _____
QUAD - I.D. _____