

FLORIDA DEPARTMENT OF ENVIRONMENTAL PROTECTION
CERTIFIED CORNER RECORD

DOC. # _____
BLM. # T43SR26E140400

CORNER DESCRIPTION: MONUMENTATION DESCRIPTION (EVIDENCE FOUND OR METHOD TO SET)

Depict corner with  FOUND 4"x4" CONCRETE MONUMENT, NO ID, 1.5' BELOW GROUND

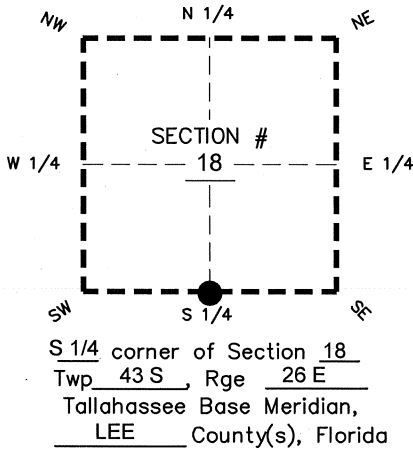

PRIOR CCR'S:

DOC. # 035202

HORIZONTAL POSITION INFORMATION (if determined):

Latitude 26°43'31.8938" N Longitude 81°45'11.5797" W
 Y(NORTHING-Ft.) 869478.35 X(EASTING-Ft.) 736718.51 Zone WEST
 Convergence 00°06'39.5" Scale factor 0.99994862
 Coordinate determination: GPS
 Horizontal datum: NAD83(NSRS2007)
 Accuracy (circle one): 1st 2nd 3rd other 1:35,000

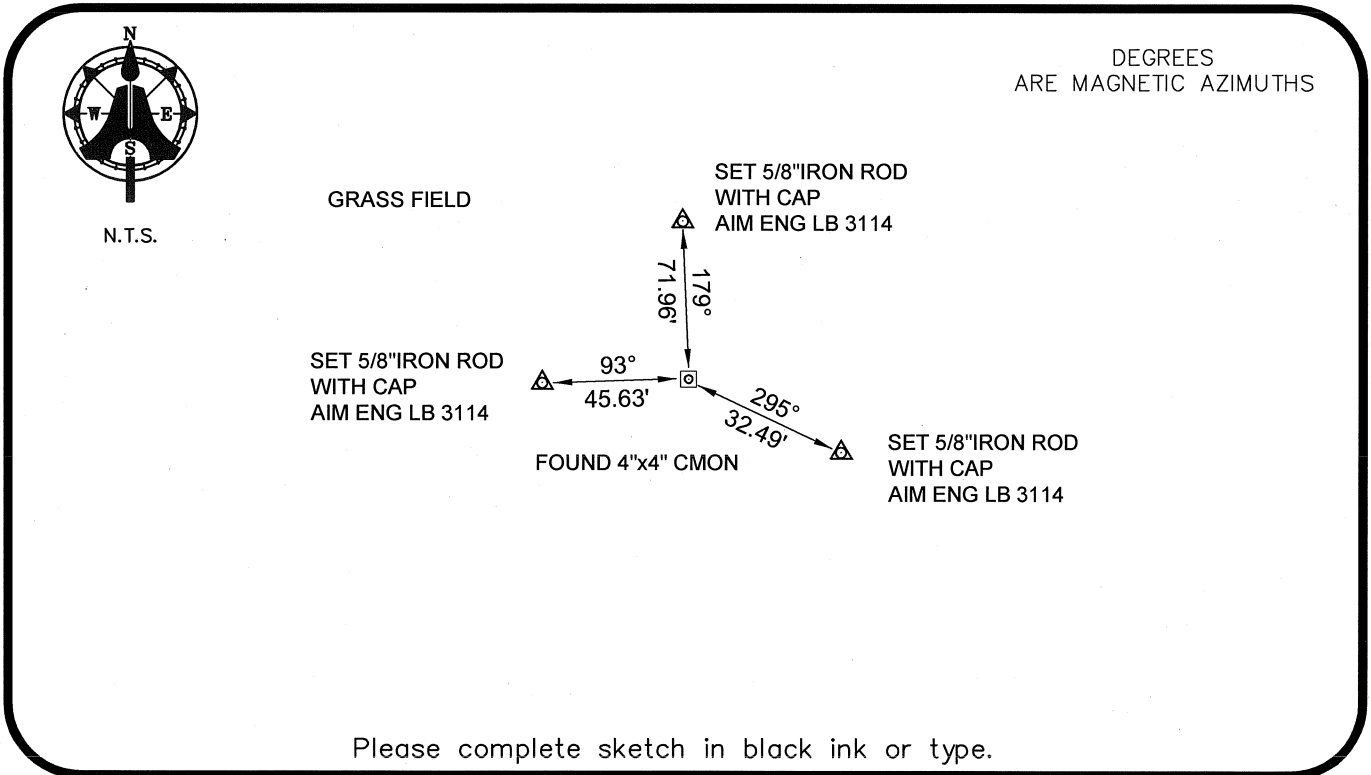

SURVEYORS CERTIFICATE:

I certify the monument and accessories indicated above were field located on 07-16-2008

BEN R. HOMOLA

Ben R. Homola 3950
SIGNATURE PSM NO.

AIM ENGINEERING & SURVEYING, INC. 3114
FIRM OR AGENCY LB NO.

5300 LEE BOULEVARD
LEHIGH ACRES ADDRESS FL 33971

(239)332-4569 07/30/2008
PHONE NUMBER DATE

EMBOSSSED SEAL OVER SIGNATURE

SEND ORIGINAL TO:
Department of Environmental Protection
Bureau of Surveying and Mapping
3900 Commonwealth Boulevard
Mail Station 105
Tallahassee, Florida 32399

D.E.P. USE ONLY	
Processed:	_____
B.L.M. - I.D.	_____
QUAD - I.D.	_____