

**FLORIDA DEPARTMENT OF ENVIRONMENTAL PROTECTION
CERTIFIED CORNER RECORD**

074762

DOC. # _____

CORNER DESCRIPTION: **MONUMENTATION DESCRIPTION (EVIDENCE FOUND OR METHOD TO SET)**

Depict corner with 

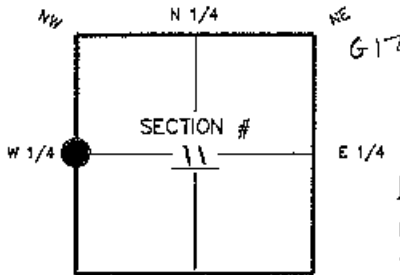

FOUND 4" x 4" C.M.
WITH CAP "L.B. 697"

HORIZONTAL POSITION INFORMATION (if determined):

Latitude 26°44'53.00064" Longitude 81°53'29.06878"
 Y(NORTHING-Ft.) 977604.830 X(EASTING-Ft.) 691604.825 Zone WEST
 Convergence 0°02'55.9" Scale factor 0.99994262
 Coordinate determination (circle one): Field traverse **GPS**
 Horizontal datum (circle one): NAD27 NAD83(1986) **NAD83(1990)** other (explain)
 Accuracy (circle one): 1st 2nd 3rd other 1:50,000

W 1/4 corner of Section 11
 Twp. 43 S, Rge 24 E
 Tallahassee Base Meridian,
 LEE County(s), Florida

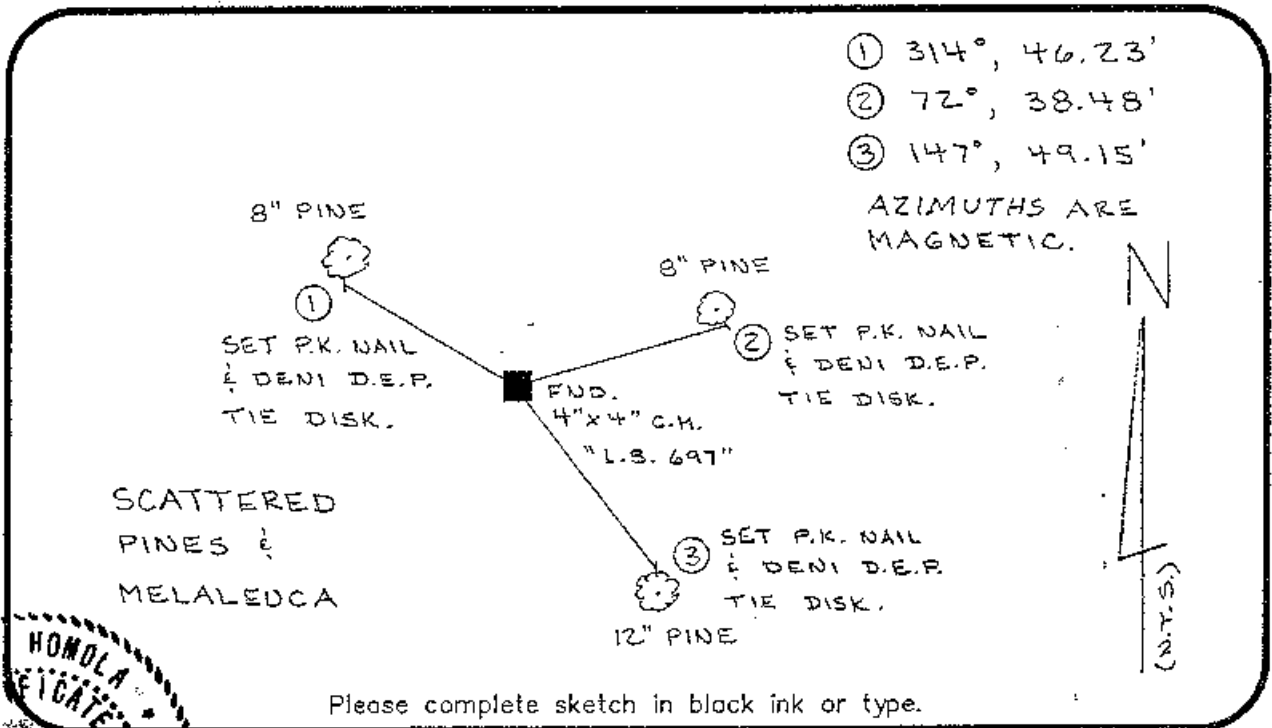

Please complete sketch in black ink or type.

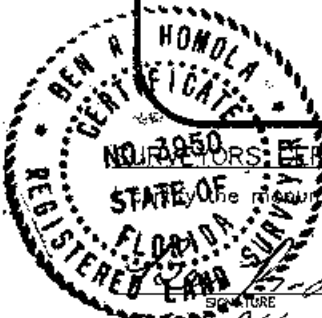

REGISTERED LAND SURVEYORS: CERTIFICATE:

The monument and accessories indicated above were field located on 12-18-01

DENT ASSOCIATES, INC. PSM NO. 3950
6241 ARC WAY LB NO. 3542
 ADDRESS
FORT MYERS FL 33912
 CITY STATE ZIP
(941) 275-8875 DATE 2-20-02
 PHONE NUMBER DATE

EMBOSSSED SEAL OVER SIGNATURE

SEND ORIGINAL TO:
 Department of Environmental Protection
 Bureau of Surveying and Mapping
 3900 Commonwealth Boulevard
 Mail Station 105
 Tallahassee, Florida 32399

D.E.P. USE ONLY	
Processed: <u>3-8-02</u>	<u>CS</u>
B.L.M. - I.D. <u>500540</u>	
QUAD - I.D. <u>437 Fort Myers NW</u>	