

**FLORIDA DEPARTMENT OF ENVIRONMENTAL PROTECTION
CERTIFIED CORNER RECORD**

089054

DOC. # _____

CORNER DESCRIPTION:

Depict corner with 

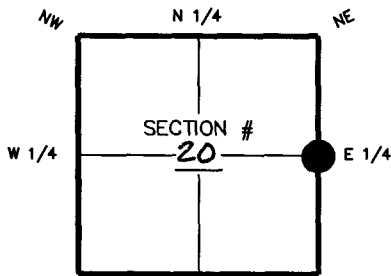

E 1/4 corner of Section 20
Twp 43S, Rge 23E
Tallahassee Base Meridian,
LEE County(s), Florida

MONUMENTATION DESCRIPTION (EVIDENCE FOUND OR METHOD TO SET)

*FOUND IRON RE-BAR AND CAP "ZN 1/2 S LB 2230"
REPLACED WITH 4" X 4" CONCRETE MONUMENT
WITH HOLE MONTES "LB 1772" 2" ALUMINUM
DISK.*

HORIZONTAL POSITION INFORMATION (if determined):

Latitude 26° 43' 08.300" Longitude -82° 01' 22.555"
Y(NORTHING-Ft.) 867018.72 X(EASTING-Ft.) 648681.09 Zone W
Convergence -0° 06' 37.1" Scale factor 0.99994124
Coordinate determination (circle one): Field traverse (GPS)
Horizontal datum (circle one): NAD27 NAD83(1986) (NAD83(1990)) other (explain)
Accuracy (circle one): 1st 2nd 3rd other 1:50,000

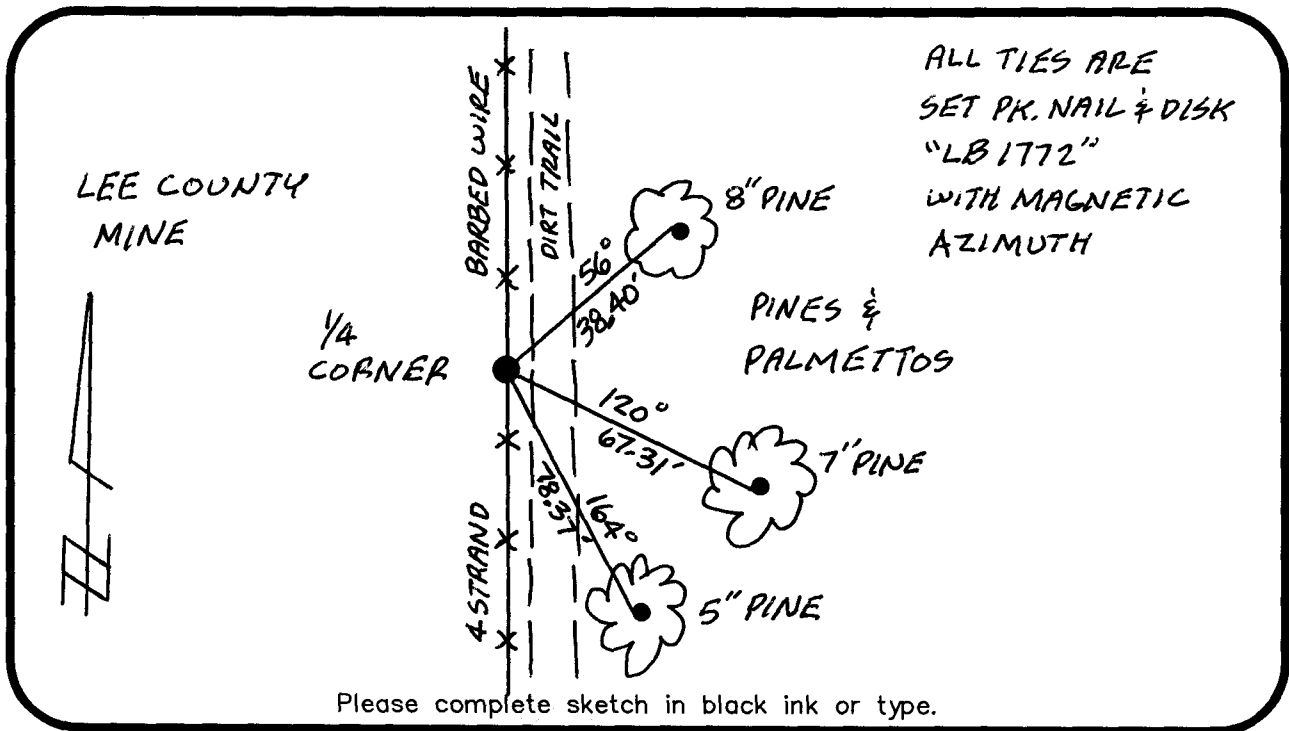

Please complete sketch in black ink or type.

SURVEYORS CERTIFICATE:

I certify the monument and accessories indicated above were field located on 6-19-06

BEN R. HOMOLA
Bern R. Homola
SIGNATURE
HOLE MONTES
FIRM OR AGENCY
6200 WHISKEY CREEK DRIVE
ADDRESS
FORT MYERS, FL 33919
CITY STATE ZIP
239-985-1200 6-26-06
PHONE NUMBER DATE

SEND ORIGINAL TO:
Department of Environmental Protection
Bureau of Surveying and Mapping
3900 Commonwealth Boulevard
Mail Station 105
Tallahassee, Florida 32399

Processed: 8-1-06 YMB D.E.P. USE ONLY
B.L.M. - I.D. 300340
QUAD - I.D. 2217 Matacha

EMBOSSSED SEAL OVER SIGNATURE