

**FLORIDA DEPARTMENT OF ENVIRONMENTAL PROTECTION
CERTIFIED CORNER RECORD**

DOC. # 087687

CORNER DESCRIPTION: MONUMENTATION DESCRIPTION (EVIDENCE FOUND OR METHOD TO SET)

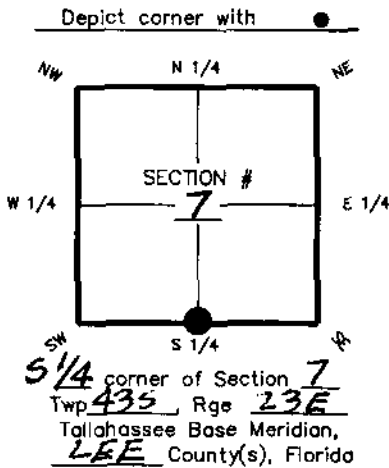

*FOUND 3 1/2" x 3 1/2" CONC. MON.
WITH CAP "LB697"*

HORIZONTAL POSITION INFORMATION (if determined):

Latitude 26°44'27.6636" Longitude 82°02'49.2801"
Y(NORTHING-Ft.) 875034.25 X(EASTING-Ft.) 640820.38 Zone W
Convergence -0°01'16.17" Scale factor 0.99994145
Coordinate determination (circle one): Field traverse (GPS)
Horizontal datum (circle one): NAD27 NAD83(1986) NAD83(1998) other (explain) 3
Accuracy (circle one): 1st 2nd 3rd other 1:50,000

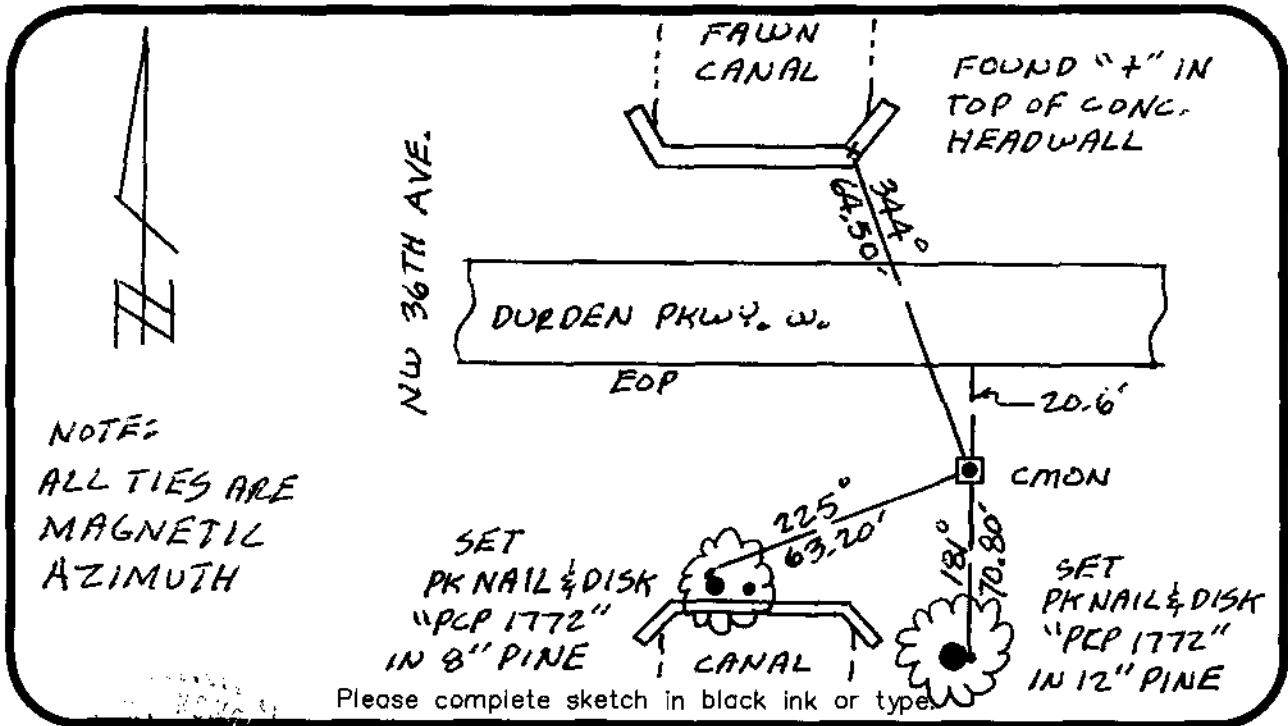

SURVEYORS CERTIFICATE:

I certify the monument and accessories indicated above were field located on 3-16-06

NO. 3950
Ben A. Amole 3950
SIGNATURE FSN NO.
HOE MONTE'S 1772
FIRM OR AGENCY LB NO.
6200 WINSKEY CREEK DR.
ADDRESS
FORT MYERS FL 33919
CITY STATE ZIP
234-985-1200 3-27-06
PHONE NUMBER DATE

SEND ORIGINAL TO:
Department of Environmental Protection
Bureau of Surveying and Mapping
3900 Commonwealth Boulevard
Mail Station 105
Tallahassee, Florida 32399

Processed: 11/17/06 MB MB
B.L.M. - I.D. 140500
QUAD - I.D. 2217 Matlacha

EMBOSSSED SEAL OVER SIGNATURE