

**FLORIDA DEPARTMENT OF ENVIRONMENTAL PROTECTION
CERTIFIED CORNER RECORD**

DOC. # 089391

CORNER DESCRIPTION: MONUMENTATION DESCRIPTION (EVIDENCE FOUND OR METHOD TO SET)

Depict corner with ● Z-17

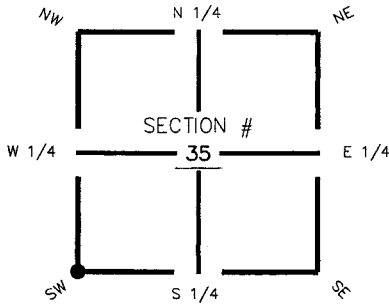

Found 4"x4"
Concrete Monument

HORIZONTAL POSITION INFORMATION (if determined):

Latitude 26° 46' 09.71077" N Longitude 81° 35' 54.55646" W
 Y(NORTHING-Ft.) 885541.93 X(EASTING-Ft.) 787173.18 Zone FL83-WF
 Convergence 0° 10' 51.03671" Scale factor 0.999960854
 Coordinate determination (circle one): Field traverse (GPS)
 Horizontal datum (circle one): NAD27 NAD83(1986) (NAD83(1999)) other (explain)
 Accuracy (circle one): 1st (2nd) 3rd other _____

SW corner of Section 35
Twp.42 South , Rge 27 East
 Tallahassee Base Meridian,
Charlotte County(s), Florida

1. 10' 65.53'. Found 4"x4" Concrete Monument with Brass Disc Charlotte Co. stamped Ref. Mon. 4227.34Z17.

2. 190' 10.00'. Set PK Nail and Trav. Pt. Disc (LB 642) in W. face of Pepper Berry tree clump.

3. 283' 11.82'. Set PK Nail and Trav. Pt. Disc (LB 642) in S. face of fence post.

S.W. Cor. Sec.35, Twp.42S., Rge.27E.
 Found 4"x4" Concrete Monument Post
 0.5'S. of E.-W. fence line.

Field Book: LB-31, Page 46

SURVEYORS CERTIFICATE:

I certify the monument and accessories indicated above were field located on August 31, 2005

[Signature]
 SIGNATURE _____ PSM NO. 4912
Johnson Engineering, Inc. _____ LB NO. 642
 FIRM OR AGENCY _____
251 West Hickory _____ ADDRESS
La Belle _____ CITY STATE ZIP
FLORIDA _____
(863) 612-0594 _____ PHONE NUMBER DATE
November 1, 2005

SEND ORIGINAL TO:
 Department of Environmental Protection
 Bureau of Surveying and Mapping
 3900 Commonwealth Boulevard
 Mail Station 105
 Tallahassee, Florida 32399

D.E.P. USE ONLY

Processed: 11-13-06 MB
 B.L.M. - I.D. 500100
 QUAD - I.D. 2313 Telegraph Swamp SE

EMBOSSSED SEAL OVER SIGNATURE