

LEE COUNTY SURVEY MARK DESCRIPTION



SURVEY CONTROL BY:
DENI ASSOCIATES, INC.
FORT MYERS, FLORIDA

MAPPING BY:
WOOLPERT CONSULTANTS

DESIGNATION GPS PL-6 RESET (9075) COUNTY LEE STATE FL
 LOCATED IN SEC 16 TWP 45 S. RGE 26 E. USGS QUAD MAP ALVA SW.
 TO REACH SURVEY MARK FROM THE INTERSECTION OF I-75 AND S.R. 82 GO SE.
4.7 MILES PLUS OR MINUS TO GRAVEL RD. (SW); THENCE SOUTH SW 0.9
MILES PLUS OR MINUS TO POWERLINE; THENCE SOUTH SE. 2.35 MILES PLUS
OR MINUS TO MARK.

TYPE OF 3" DIAMETER ALUMINUM DISC IN CONCRETE
 MARK "LEE COUNTY DENI ASSOCIATES 1990" DATE SET 1990

HORIZONTAL CONTROL ORIGINATED ON 1st ORDER HORIZONTAL CONTROL ORIGINATED ON _____ ORDER
 CONTROL BASED ON FLORIDA HIGH PRECISION GPS NETWORK, CONTROL BY _____
 ON NORTH AMERICAN DATUM OF 1983, 1990 ADJUSTMENT ON _____ DATUM
 COORDINATES (FT), 1st ORDER COORDINATES (FT), _____ ORDER
 NORTHING (Y) 808,281,481 NORTHING (Y) _____
 EASTING (X) 746,330,670 EASTING (X) _____

GRID FLORIDA TRANSVERSE MERCATOR RECOVERED BY _____
 ZONE WEST SCALE FACTOR .999950 DATE, CONDITION _____
 FIELD BOOK _____ PAGE _____

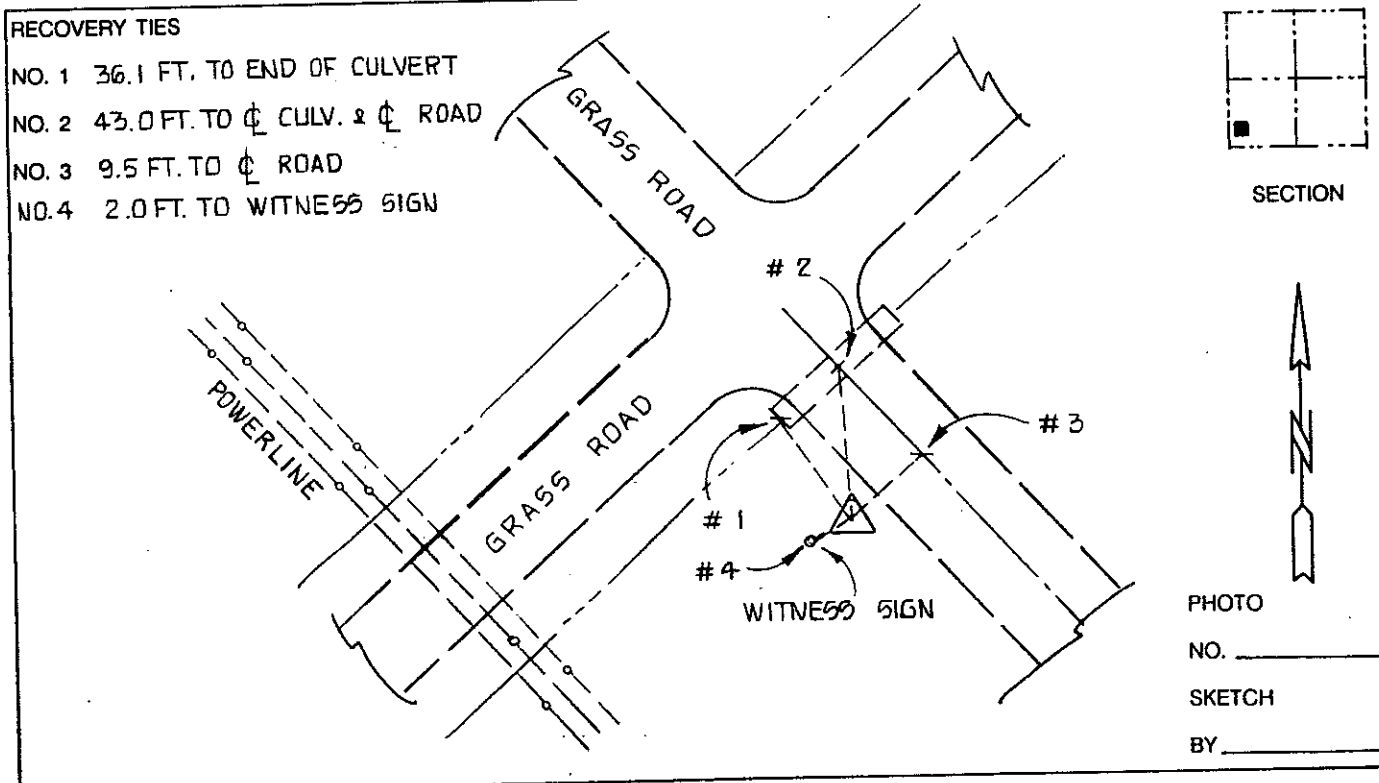

VERTICAL CONTROL ORIGINATED ON 2nd ORDER CONTROL ESTABLISHED BY N. G. S. AND F. D. O. T.
 ON NATIONAL GEODETIC VERTICAL DATUM OF 1929.
 ELEVATION (FT) _____ 3rd ORDER LEVEL BOOK _____ PAGE _____