

# LEE COUNTY SURVEY MARK DESCRIPTION



SURVEY CONTROL BY:  
DENI ASSOCIATES, INC.  
FORT MYERS, FLORIDA

MAPPING BY:  
WOOLPERT CONSULTANTS

DESIGNATION 1-09-46-27 (<sup>GPS</sup>9073) COUNTY LEE STATE FL  
 LOCATED IN SEC 09 TWP 46S RGE 7E USGS QUAD MAP CORKSCREW  
 TO REACH SURVEY MARK FROM THE INTERSECTION OF BELL BLVD & IMMOKALEE RD  
(SR 82) ; GO NORTHWESTERLY 0.55 mi ± ON IMMOKALEE RD ;  
THENCE SOUTH 2.5 mi ± TO MARK.

TYPE OF 3" DIAMETER ALUMINUM DISK IN CONCRETE 0.3 FT BELOW GROUND;  
 MARK "LEE COUNTY DENI ASSOCIATES 1990" DATE SET 1990

HORIZONTAL CONTROL ORIGINATED ON 1st ORDER HORIZONTAL CONTROL ORIGINATED ON \_\_\_\_\_ ORDER  
 CONTROL BASED ON FLORIDA HIGH PRECISION GPS NETWORK, CONTROL BY \_\_\_\_\_  
 ON NORTH AMERICAN DATUM OF 1983, 1990 ADJUSTMENT ON \_\_\_\_\_ DATUM  
 COORDINATES (FT), 1st ORDER COORDINATES (FT), \_\_\_\_\_ ORDER  
 NORTHING (Y) 785,822.403 NORTHING (Y) \_\_\_\_\_  
 EASTING (X) 781,707.164 EASTING (X) \_\_\_\_\_

GRID FLORIDA TRANSVERSE MERCATOR RECOVERED BY \_\_\_\_\_  
 ZONE WEST SCALE FACTOR .999959 DATE, CONDITION \_\_\_\_\_  
 FIELD BOOK \_\_\_\_\_ PAGE \_\_\_\_\_

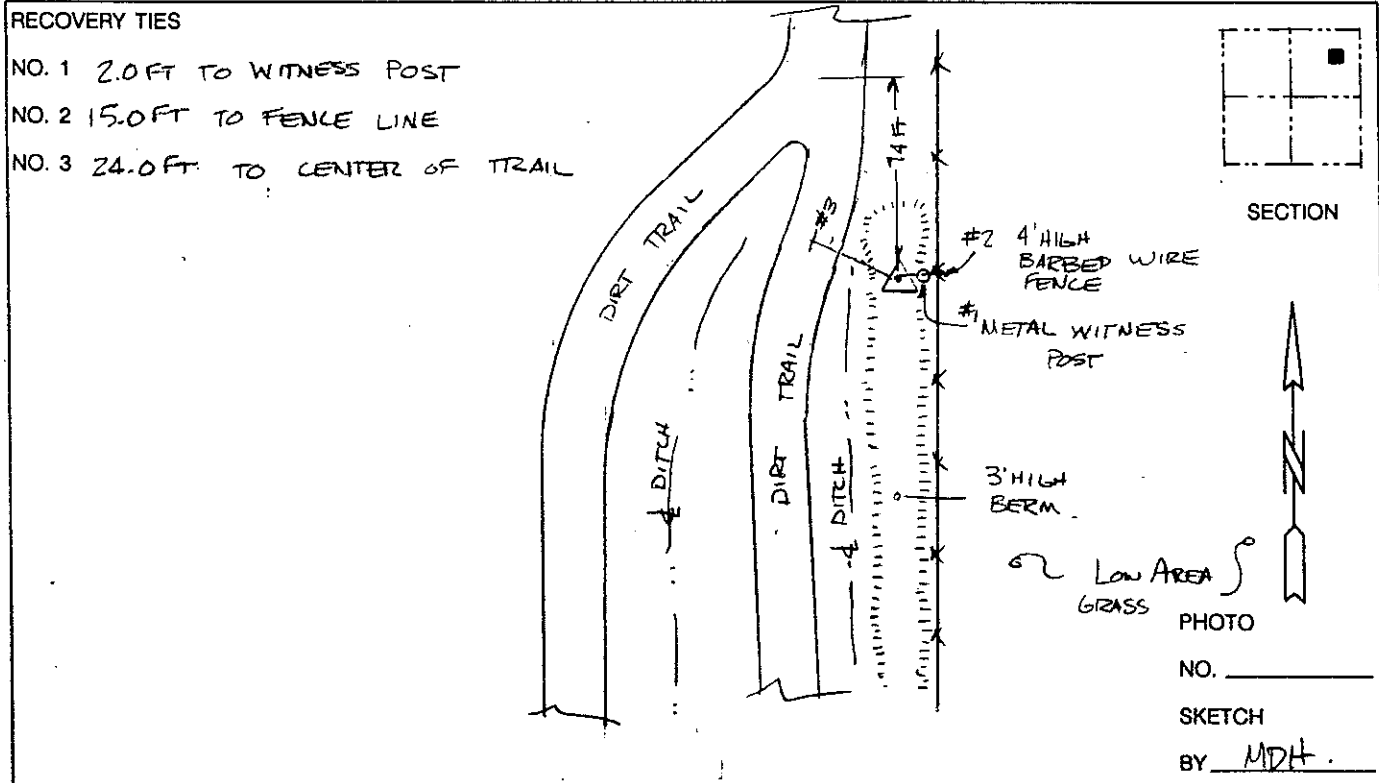

VERTICAL CONTROL ORIGINATED ON 2nd ORDER CONTROL ESTABLISHED BY \_\_\_\_\_ N. G. S. AND F. D. O. T.  
 ON NATIONAL GEODETIC VERTICAL DATUM OF 1929.  
 ELEVATION (FT) \_\_\_\_\_, 3rd ORDER LEVEL BOOK \_\_\_\_\_ PAGE \_\_\_\_\_