

# LEE COUNTY SURVEY MARK DESCRIPTION



SURVEY CONTROL BY:  
DENI ASSOCIATES, INC.  
FORT MYERS, FLORIDA

MAPPING BY:  
WOOLPERT CONSULTANTS

DESIGNATION 1-12-47-26 <sup>GPS</sup> (9068) COUNTY LEE STATE FL  
 LOCATED IN SEC 12 TWP 47S RGE 26E USGS QUAD MAP CORKSCREW NW  
 TO REACH SURVEY MARK FROM THE INTERSECTION OF SIX L'S FARM RD &  
CORKSCREW RD ; GO SOUTH ON SIX L'S FARM RD 3.2 MI ±  
TO MARK.

TYPE OF 3" DIAMETER ALUMINUM DISK IN CONCRETE ; "LEE COUNTY DENI  
 MARK ASSOCIATES 1990" DATE SET 1990

HORIZONTAL CONTROL ORIGINATED ON 1st ORDER HORIZONTAL CONTROL ORIGINATED ON \_\_\_\_\_ ORDER  
 CONTROL BASED ON FLORIDA HIGH PRECISION GPS NETWORK, CONTROL BY \_\_\_\_\_  
 ON NORTH AMERICAN DATUM OF 1983, 1990 ADJUSTMENT ON \_\_\_\_\_ DATUM  
 COORDINATES (FT), 1st ORDER COORDINATES (FT), \_\_\_\_\_ ORDER  
 NORTHING (Y) 752,882,799 NORTHING (Y) \_\_\_\_\_  
 EASTING (X) 767,678,934 EASTING (X) \_\_\_\_\_

GRID FLORIDA TRANSVERSE MERCATOR RECOVERED BY \_\_\_\_\_  
 ZONE WEST SCALE FACTOR .999955 DATE, CONDITION \_\_\_\_\_

FIELD BOOK \_\_\_\_\_ PAGE \_\_\_\_\_

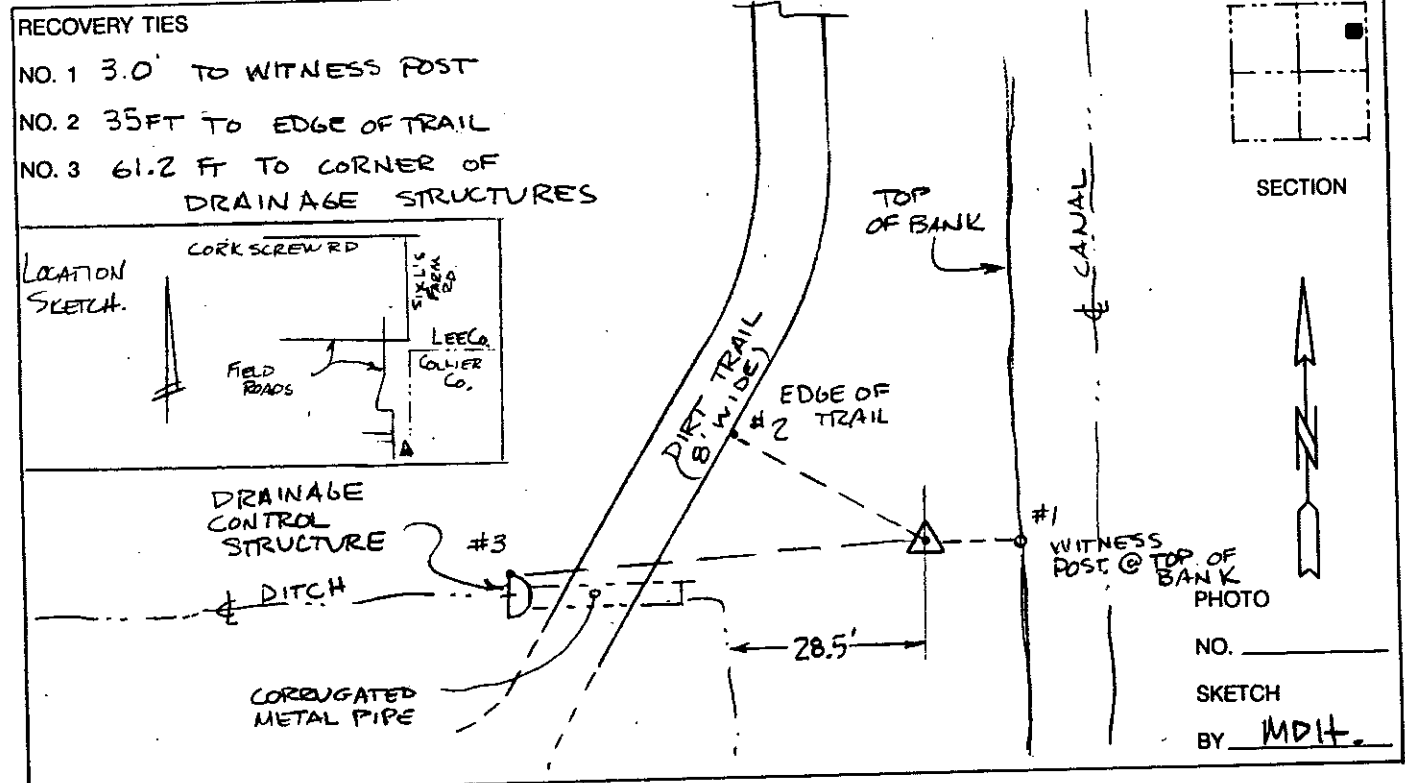

VERTICAL CONTROL ORIGINATED ON 2nd ORDER CONTROL ESTABLISHED BY \_\_\_\_\_ N. G. S. AND F. D. O. T.

ON NATIONAL GEODETIC VERTICAL DATUM OF 1929.  
 ELEVATION (FT) \_\_\_\_\_ 3rd ORDER LEVEL BOOK \_\_\_\_\_ PAGE \_\_\_\_\_