

LEE COUNTY SURVEY MARK DESCRIPTION



SURVEY CONTROL BY:
DENI ASSOCIATES, INC.
FORT MYERS, FLORIDA

MAPPING BY:
WOOLPERT CONSULTANTS

DESIGNATION (JEI) 44-23-17-01 (GPS 9061) COUNTY LEE STATE FL
 LOCATED IN SEC 17 TWP 44S RGE 23E USGS QUAD MAP MATLACHA
 TO REACH SURVEY MARK FROM _____

 AT THE INTERSECTION OF PINE ISLAND ROAD AND BURNT
 STORE MARINA ROAD IN WESTERN CAPE CORAL.

TYPE OF 4"x4" CONCRETE MONUMENT WITH BRASS DISK; "LEE COUNTY GPS
 MARK LB 642", SET BY J.E.I. DATE SET 1990

HORIZONTAL CONTROL ORIGINATED ON 1st ORDER HORIZONTAL CONTROL ORIGINATED ON _____ ORDER
 CONTROL BASED ON FLORIDA HIGH PRECISION GPS NETWORK, CONTROL BY _____
 ON NORTH AMERICAN DATUM OF 1983, 1990 ADJUSTMENT ON _____ DATUM
 COORDINATES (FT), 1st ORDER COORDINATES (FT), _____ ORDER
 NORTHING (Y) 837,582,099 NORTHING (Y) _____
 EASTING (X) 643,202,643 EASTING (X) _____

GRID FLORIDA TRANSVERSE MERCATOR RECOVERED BY DENI ASSOCIATES
 ZONE WEST SCALE FACTOR .999941 DATE, CONDITION 2-91
 FIELD BOOK _____ PAGE _____ GOOD

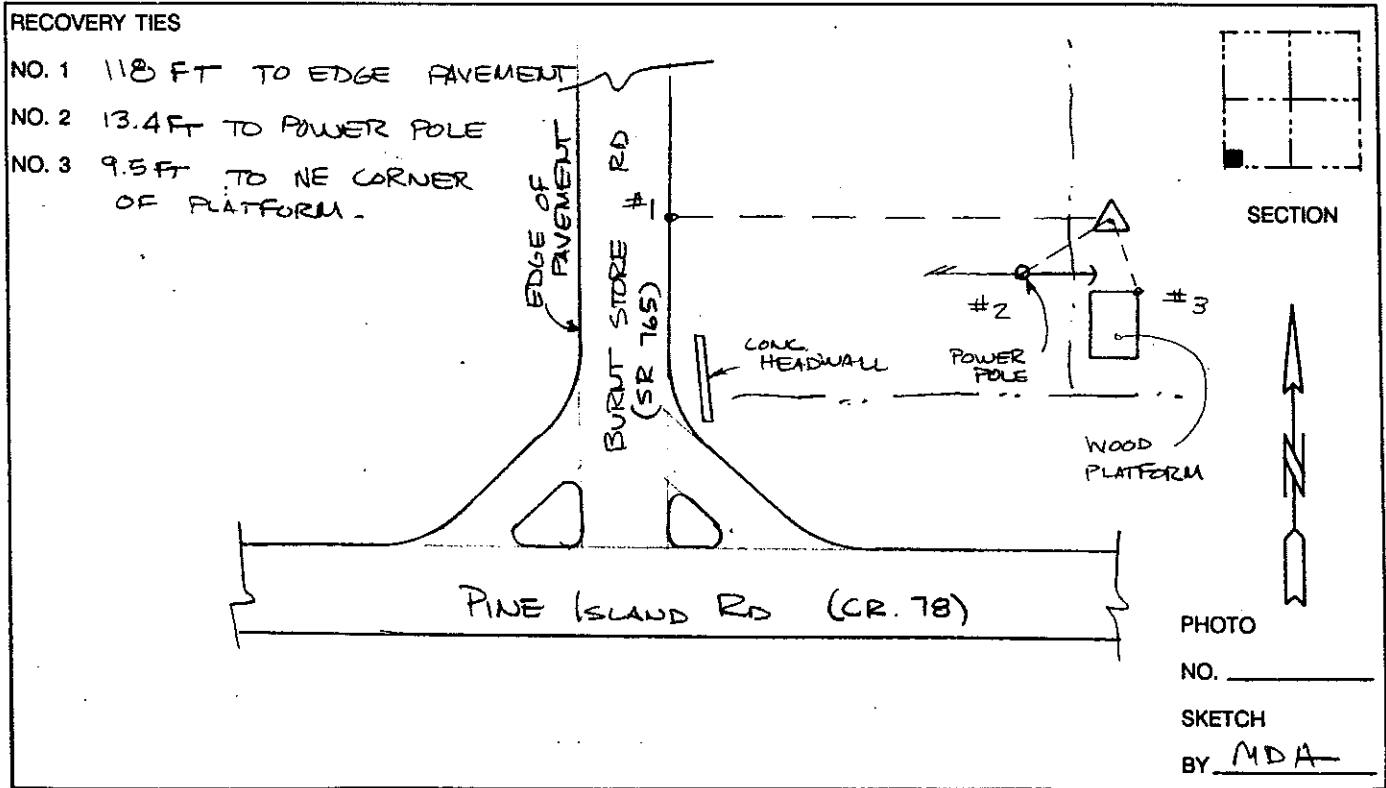

VERTICAL CONTROL ORIGINATED ON 2nd ORDER CONTROL ESTABLISHED BY N. G. S. AND F. D. O. T.
 ON NATIONAL GEODETIC VERTICAL DATUM OF 1929.
 ELEVATION (FT) _____, 3rd ORDER LEVEL BOOK _____ PAGE _____