

# LEE COUNTY SURVEY MARK DESCRIPTION



SURVEY CONTROL BY:  
DENI ASSOCIATES, INC.  
FORT MYERS, FLORIDA

MAPPING BY:  
WOOLPERT CONSULTANTS

DESIGNATION 1-02 48 26 <sup>GPS</sup> (9051) COUNTY LEE STATE FL  
 LOCATED IN SEC 2 TWP 48 RGE 26 USGS QUAD MAP CORKSCREW SW  
 TO REACH SURVEY MARK FROM I75 & BONITA BEACH RD./CARREL RD.: GO E.  
0.75 MI; THENCE ALONG FARM RDS: S. 0.35 MI; THENCE  
W. 0.3 MI; THENCE S. 0.1 MI.; THENCE W. 0.1 MI.  
TO MARK  
 TYPE OF 3" DIA ALUM. DISK IN CONC., 5" BLW. GRD., "LEE COUNTY  
 MARK DENI ASSOCIATES 1990" DATE SET JAN 1991  
 HORIZONTAL CONTROL ORIGINATED ON 1st ORDER HORIZONTAL CONTROL ORIGINATED ON \_\_\_\_\_ ORDER  
 CONTROL BASED ON FLORIDA HIGH PRECISION GPS NETWORK, CONTROL BY \_\_\_\_\_  
 ON NORTH AMERICAN DATUM OF 1983, 1990 ADJUSTMENT ON \_\_\_\_\_ DATUM  
 COORDINATES (FT), 1st ORDER COORDINATES (FT), \_\_\_\_\_ ORDER  
 NORTHING (Y) 723,790,399 NORTHING (Y) \_\_\_\_\_  
 EASTING (X) 758,417,755 EASTING (X) \_\_\_\_\_  
 GRID FLORIDA TRANSVERSE MERCATOR RECOVERED BY \_\_\_\_\_  
 ZONE WEST SCALE FACTOR .999953 DATE, CONDITION \_\_\_\_\_  
 FIELD BOOK \_\_\_\_\_ PAGE \_\_\_\_\_

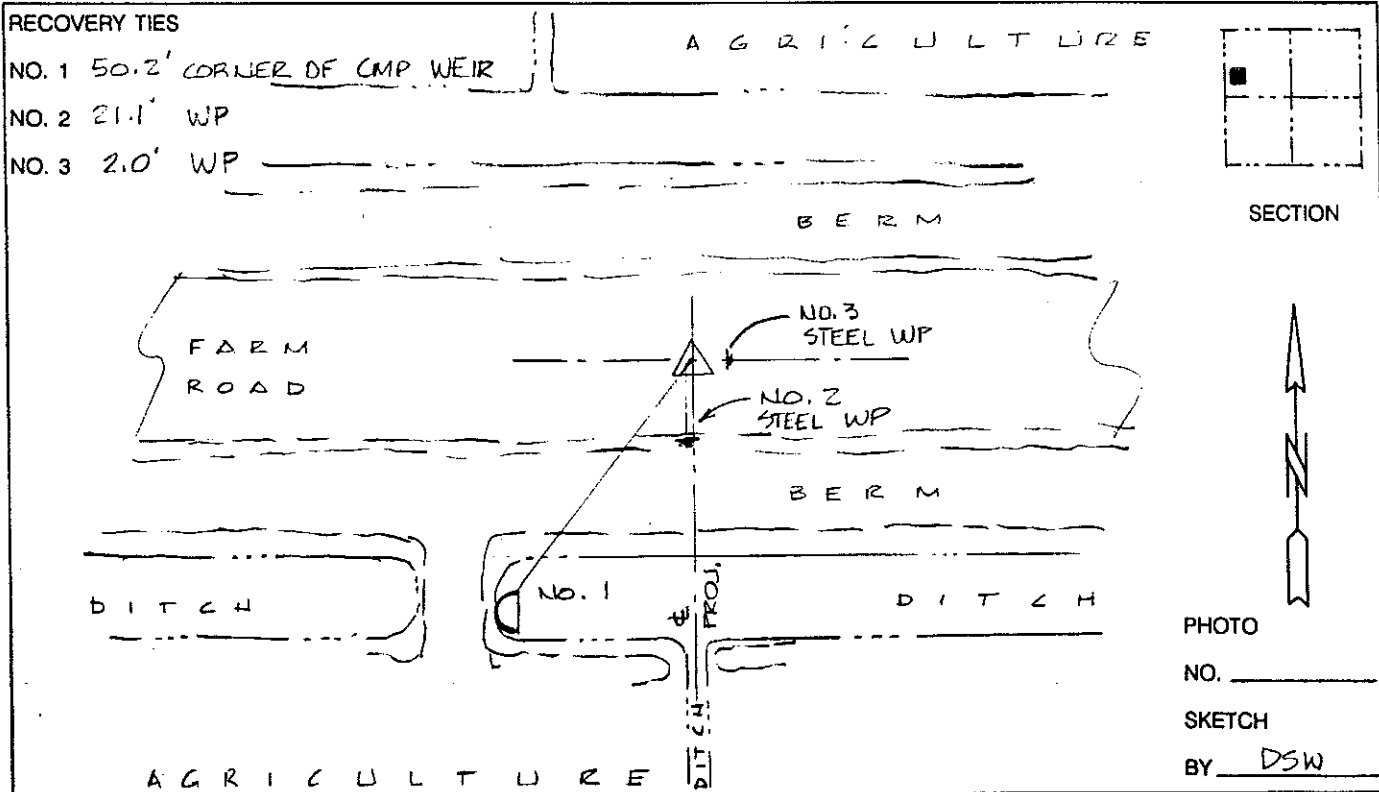

VERTICAL CONTROL ORIGINATED ON 2nd ORDER CONTROL ESTABLISHED BY N. G. S. AND F. D. O. T.  
 ON NATIONAL GEODETIC VERTICAL DATUM OF 1929.  
 ELEVATION (FT) \_\_\_\_\_ 3rd ORDER LEVEL BOOK \_\_\_\_\_ PAGE \_\_\_\_\_