

LEE COUNTY SURVEY MARK DESCRIPTION



SURVEY CONTROL BY:
DENI ASSOCIATES, INC.
FORT MYERS, FLORIDA

MAPPING BY:
WOOLPERT CONSULTANTS

DESIGNATION F.D.O.T. 12 88 A30 ^{GPS} (9032) COUNTY LEE STATE FL
 LOCATED IN SEC 31 TWP 43S. RGE 28E USGS QUAD MAP MATLACHA
 TO REACH SURVEY MARK FROM INTERSECTION OF PINE ISLAND ROAD (CR 78)
& BURNT STORE ROAD (CR 765) ; GO NORTH ON BURNT STORE
ROAD (CR 765) 3.2 MI ± ; 0.15 MI. N. OF GULFSTREAM PKWY.

TYPE OF 4x4" CONCRETE MONUMENT WITH BRASS DISK & "FLA DOT." -
 MARK EXISTING DATE SET ^{GPS} 1990

HORIZONTAL CONTROL ORIGINATED ON 1st ORDER HORIZONTAL CONTROL ORIGINATED ON _____ ORDER
 CONTROL BASED ON FLORIDA HIGH PRECISION GPS NETWORK, CONTROL BY _____
 ON NORTH AMERICAN DATUM OF 1983, 1990 ADJUSTMENT ON _____ DATUM
 COORDINATES (FT), 1st ORDER COORDINATES (FT), _____ ORDER
 NORTHING (Y) 854,422.483 NORTHING (Y) _____
 EASTING (X) 643,300.507 EASTING (X) _____

GRID FLORIDA TRANSVERSE MERCATOR MARK RECOVERED BY DENI ASSOC., INC.
 ZONE WEST SCALE FACTOR .999941 DATE, CONDITION MAR. 1990 ; GOOD
 FIELD BOOK _____ PAGE _____

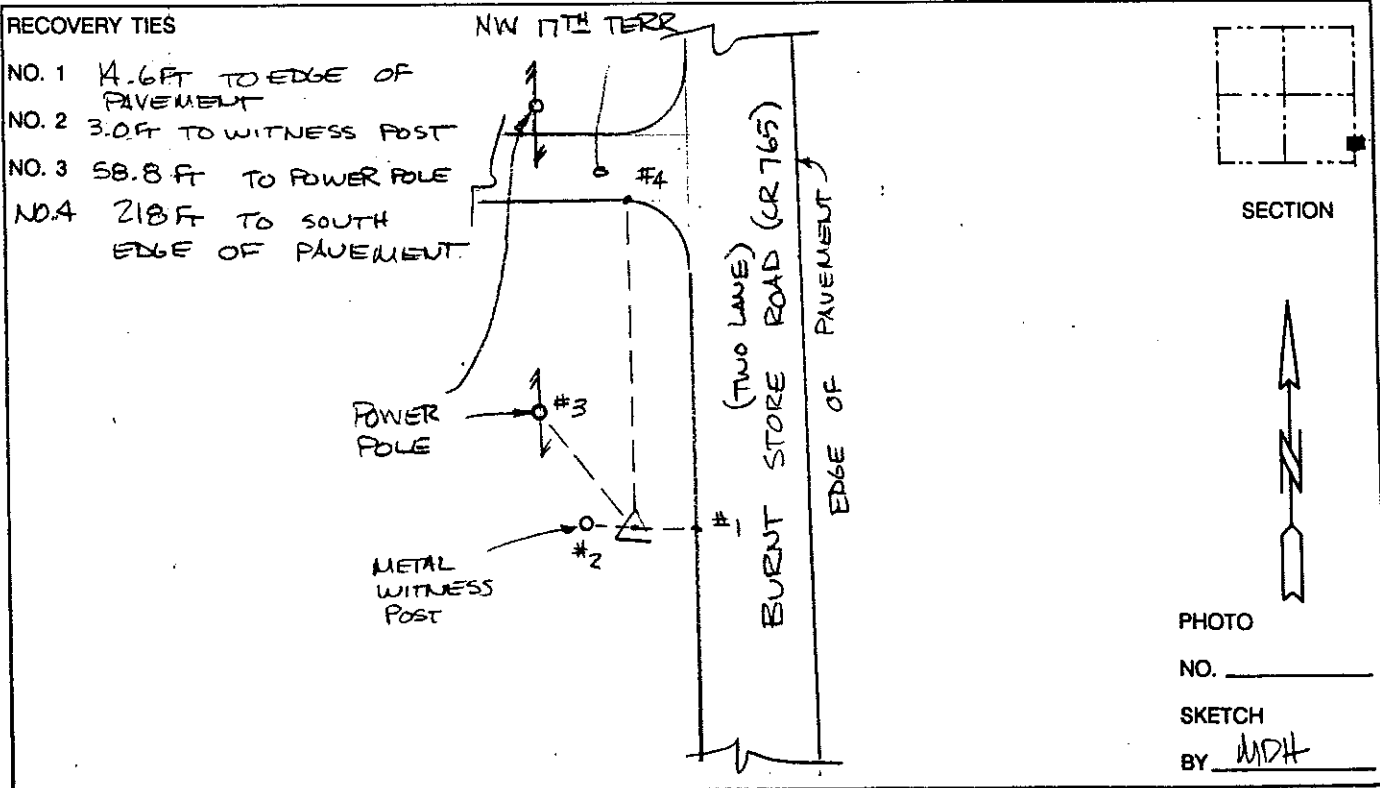

VERTICAL CONTROL ORIGINATED ON 2nd ORDER CONTROL ESTABLISHED BY N. G. S. AND F. D. O. T.
 ON NATIONAL GEODETIC VERTICAL DATUM OF 1929.
 ELEVATION (FT) _____, 3rd ORDER LEVEL BOOK _____ PAGE _____