

# LEE COUNTY SURVEY MARK DESCRIPTION



SURVEY CONTROL BY:  
DENI ASSOCIATES, INC.  
FORT MYERS, FLORIDA

MAPPING BY:  
WOOLPERT CONSULTANTS

DESIGNATION ELCV-53 <sup>GPS</sup> (9029) COUNTY LEE STATE FL  
 LOCATED IN SEC 18 TWP 45S RGE 27E USGS QUAD MAP ALVA S.W.  
 TO REACH SURVEY MARK FROM THE INTERSECTION OF ALABAMA ROAD &  
IMMOKALEE RD (SR 82) : GO NORTH 0.7 MI± TO THE  
NORTHEAST CORNER OF SECTION 18.

TYPE OF 5/8" REBAR IN 4" X 4" CONCRETE MONUMENT 1.0' BELOW  
 MARK GROUND - EXISTING DATE SET <sup>GPS</sup> 1990

HORIZONTAL CONTROL ORIGINATED ON 1st ORDER HORIZONTAL CONTROL ORIGINATED ON \_\_\_\_\_ ORDER  
 CONTROL BASED ON FLORIDA HIGH PRECISION GPS NETWORK, CONTROL BY \_\_\_\_\_  
 ON NORTH AMERICAN DATUM OF 1983, 1990 ADJUSTMENT ON \_\_\_\_\_ DATUM  
 COORDINATES (FT), 1st ORDER COORDINATES (FT), \_\_\_\_\_ ORDER  
 NORTHING (Y) 812,994,719 NORTHING (Y) \_\_\_\_\_  
 EASTING (X) 766,727,116 EASTING (X) \_\_\_\_\_

GRID FLORIDA TRANSVERSE MERCATOR RECOVERED BY \_\_\_\_\_  
 ZONE WEST SCALE FACTOR .999955 DATE, CONDITION \_\_\_\_\_  
 FIELD BOOK \_\_\_\_\_ PAGE \_\_\_\_\_

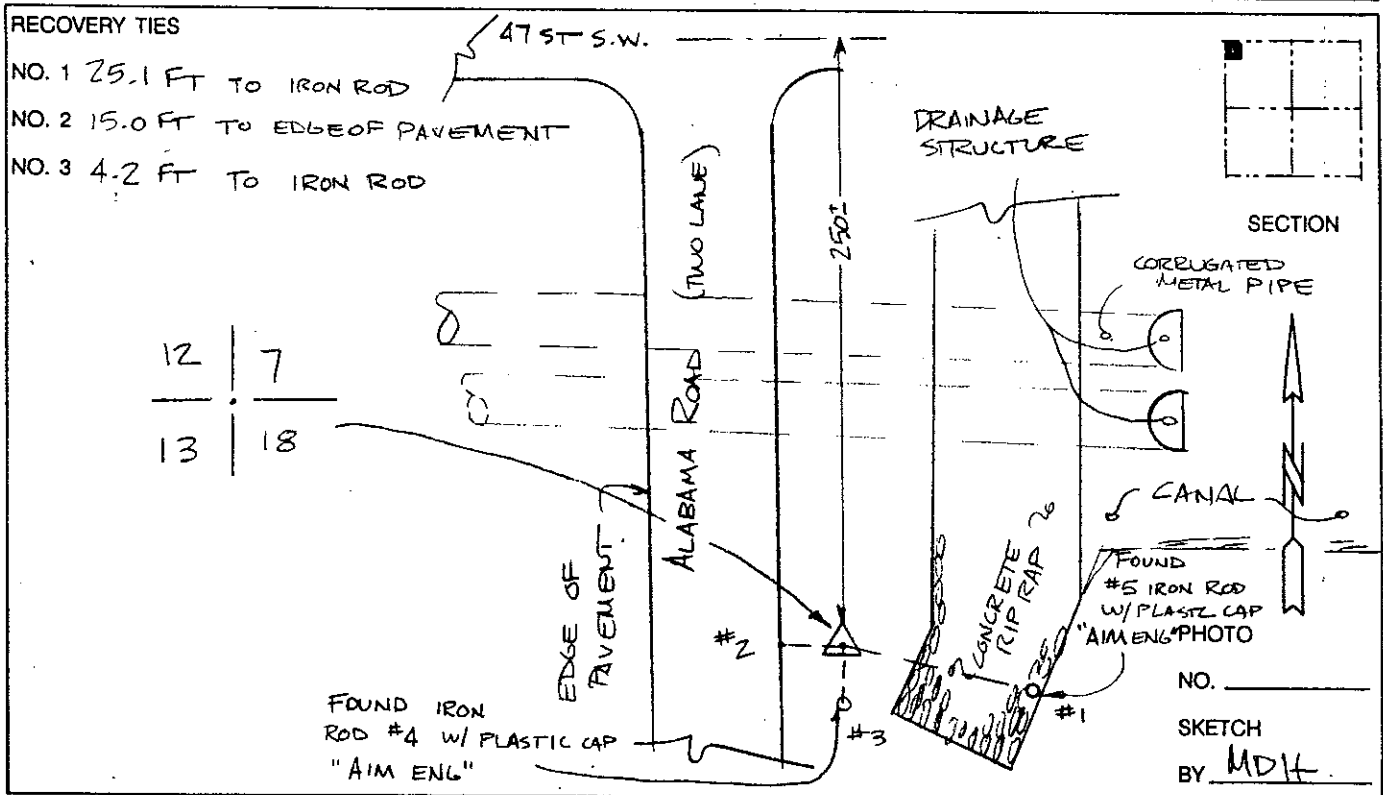

VERTICAL CONTROL ORIGINATED ON 2nd ORDER CONTROL ESTABLISHED BY N. G. S. AND F. D. O. T.  
 ON NATIONAL GEODETIC VERTICAL DATUM OF 1929.  
 ELEVATION (FT) \_\_\_\_\_ 3rd ORDER LEVEL BOOK \_\_\_\_\_ PAGE \_\_\_\_\_