

LEE COUNTY SURVEY MARK DESCRIPTION



SURVEY CONTROL BY:
DENI ASSOCIATES, INC.
FORT MYERS, FLORIDA

MAPPING BY:
WOOLPERT CONSULTANTS

DESIGNATION GPS MUSSER AZIMUTH (9008) COUNTY LEE STATE FL
 LOCATED IN SEC 10 TWP 46 S. RGE 24 E. USGS QUAD MAP FORT MYERS BEACH
 TO REACH SURVEY MARK FROM INTERSECTION OF SUMMERLIN RD (C.R. 869) AND
WINKLER ROAD GO SOUTH 1.8± MILES TO MARK

TYPE OF 3" DIAMETER ALUMINUM DISC IN CONCRETE 0.4 FT. BELOW GROUND
 MARK "LEE COUNTY DENI ASSOCIATES 1990" DATE SET 1990

HORIZONTAL CONTROL ORIGINATED ON 1st ORDER HORIZONTAL CONTROL ORIGINATED ON _____ ORDER
 CONTROL BASED ON FLORIDA HIGH PRECISION GPS NETWORK, CONTROL BY _____
 ON NORTH AMERICAN DATUM OF 1983, 1990 ADJUSTMENT ON _____ DATUM
 COORDINATES (FT), 1st ORDER COORDINATES (FT), _____ ORDER
 NORTHING (Y) 782,818.937 NORTHING (Y) _____
 EASTING (X) 689,366.451 EASTING (X) _____

GRID FLORIDA TRANSVERSE MERCATOR RECOVERED BY _____
 ZONE WEST SCALE FACTOR .999942 DATE, CONDITION _____
 FIELD BOOK _____ PAGE _____

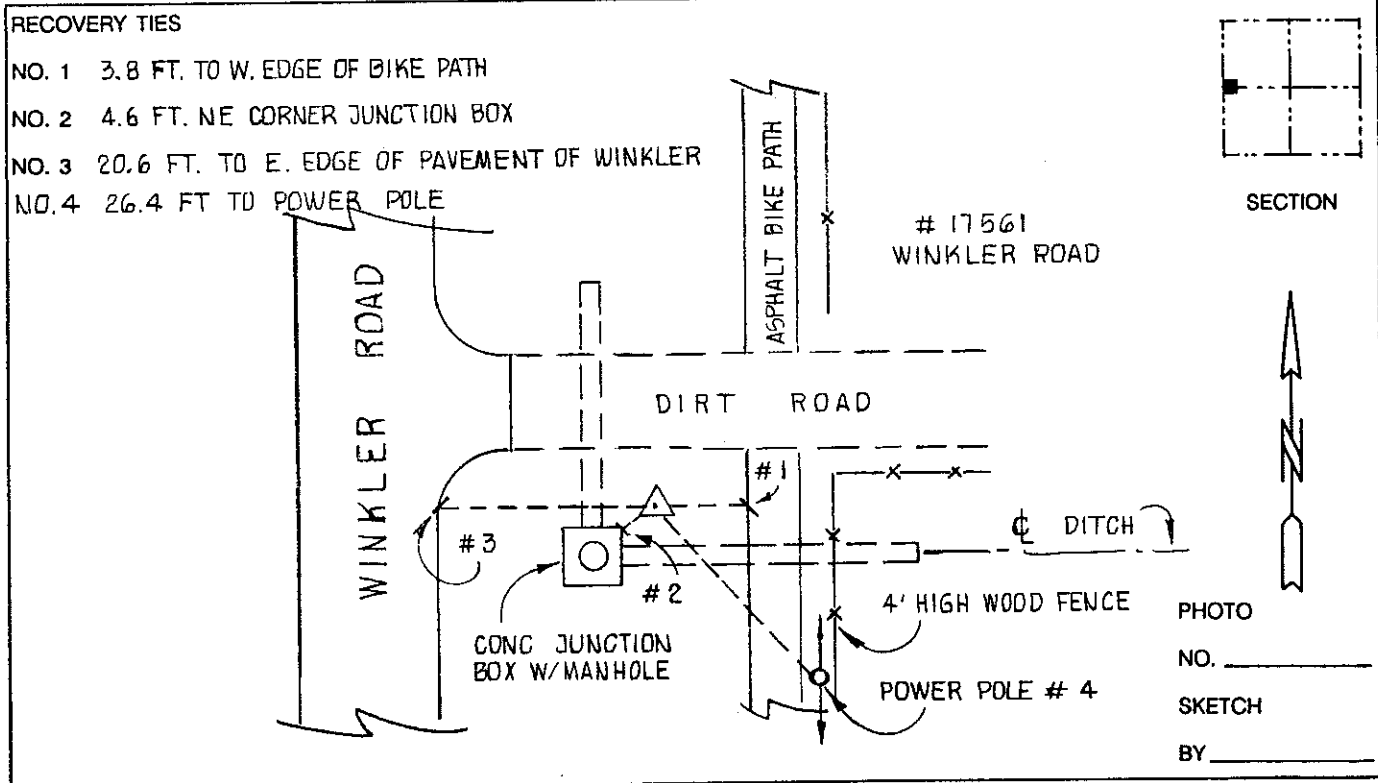

VERTICAL CONTROL ORIGINATED ON 2nd ORDER CONTROL ESTABLISHED BY N. G. S. AND F. D. O. T.
 ON NATIONAL GEODETIC VERTICAL DATUM OF 1929.
 ELEVATION (FT) _____, 3rd ORDER LEVEL BOOK _____ PAGE _____