

# LEE COUNTY SURVEY MARK DESCRIPTION



SURVEY CONTROL BY:  
DENI ASSOCIATES, INC.  
FORT MYERS, FLORIDA

MAPPING BY:  
WOOLPERT CONSULTANTS

DESIGNATION GPS BEAN AZIMUTH<sup>GPS</sup> (9005) COUNTY LEE STATE FL  
 LOCATED IN SEC 25 TWP 45 S. RGE 24 E. USGS QUAD MAP FORT MYERS SE  
 TO REACH SURVEY MARK FROM U.S. 41 AND SIX MILE PARKWAY; GO EASTERLY ALONG SIX MILE PARKWAY FOR 0.3 MILES TO THE MARK AT THE CROSSOVER.

TYPE OF 3" DIAMETER ALUMINUM DISC IN CONCRETE, 0.1 FT. BELOW GROUND  
 MARK "LEE COUNTY DENI ASSOCIATES 1990" DATE SET 1990

HORIZONTAL CONTROL ORIGINATED ON 1st ORDER HORIZONTAL CONTROL ORIGINATED ON \_\_\_\_\_ ORDER  
 CONTROL BASED ON FLORIDA HIGH PRECISION GPS NETWORK, CONTROL BY \_\_\_\_\_  
 ON NORTH AMERICAN DATUM OF 1983, 1990 ADJUSTMENT ON \_\_\_\_\_ DATUM  
 COORDINATES (FT), 1st ORDER COORDINATES (FT), \_\_\_\_\_ ORDER  
 NORTHING (Y) 797,627.552 NORTHING (Y) \_\_\_\_\_  
 EASTING (X) 700,080.009 EASTING (X) \_\_\_\_\_

GRID FLORIDA TRANSVERSE MERCATOR RECOVERED BY \_\_\_\_\_  
 ZONE WEST SCALE FACTOR 999943 DATE, CONDITION \_\_\_\_\_  
 FIELD BOOK \_\_\_\_\_ PAGE \_\_\_\_\_

**RECOVERY TIES**

- NO. 1 17.0 FT TO END GRASS MEDIAN
- NO. 2 10.7 FT. TO S. EDGE GRASS MEDIAN
- NO. 3 58.8 FT TO  $\phi$  DRIVE

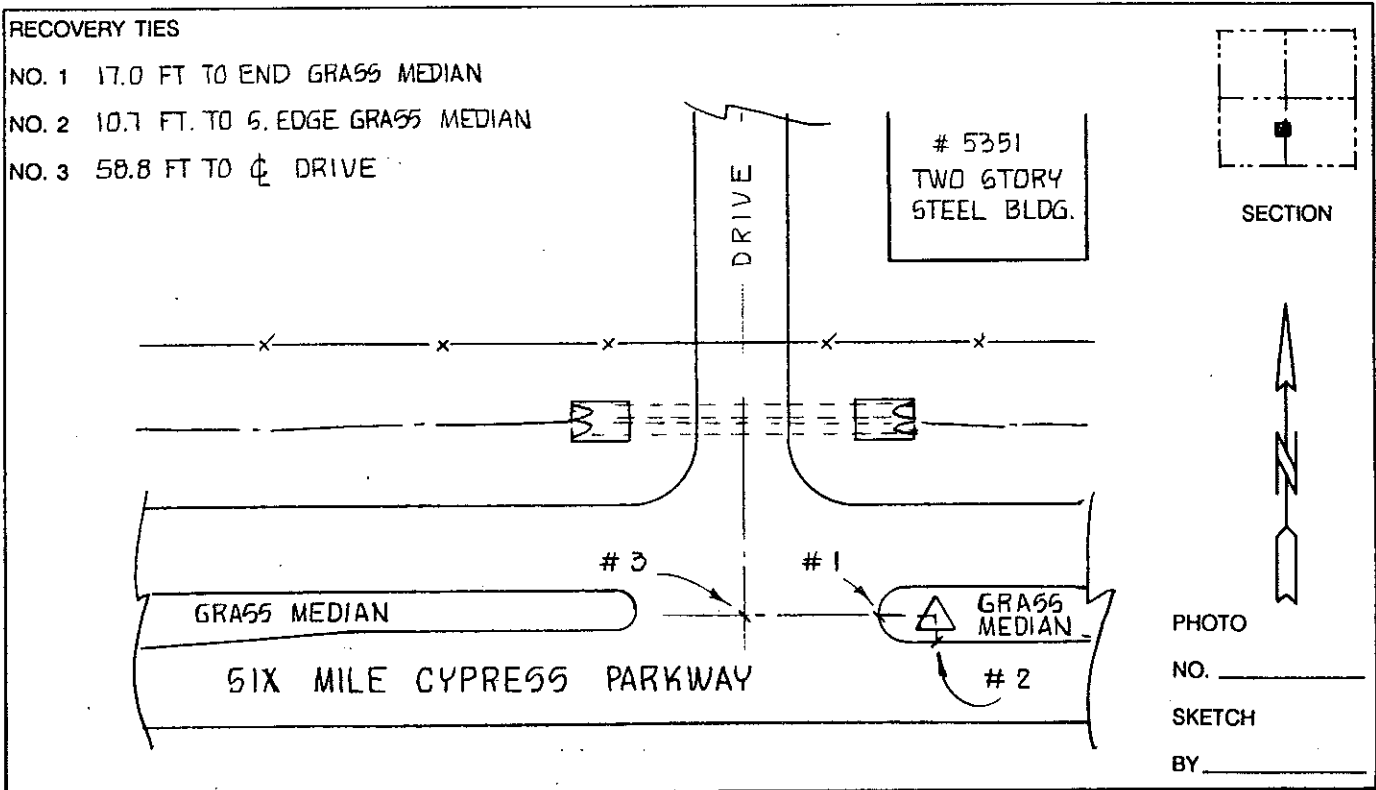

VERTICAL CONTROL ORIGINATED ON 2nd ORDER CONTROL ESTABLISHED BY N. G. S. AND F. D. O. T.  
 ON NATIONAL GEODETIC VERTICAL DATUM OF 1929.  
 ELEVATION (FT) \_\_\_\_\_, 3rd ORDER LEVEL BOOK \_\_\_\_\_ PAGE \_\_\_\_\_