

DEPARTMENT OF HOMELAND SECURITY

Federal Emergency Management Agency

ELEVATION CERTIFICATE

IMPORTANT: FOLLOW THE INSTRUCTIONS ON PAGES 9-16

OMB Control Number: 1660-0008

Expiration: 11/30/2018

Copy all pages of this Elevation Certificate and all attachments for (1) community official, (2) insurance agent/company, and (3) building owner.

SECTION A - PROPERTY INFORMATION

A1. Building Owner's Name
D R HORTON, INC.

A2. Building Street Address (including Apt., Unit, Suite, and/or Bldg. No.) or P.O. Route and Box No.
3231 BANYON HOLLOW LOOP

City NORTH FORT MYERSState FLZip Code 33903

A3. Property Description (Lot and Block Numbers, Tax Parcel Number, Legal Description, etc.)
LOT 127, MOODY RIVER ESTATES UNIT FIVE

A4. Building Use (e.g., Residential, Non-Residential, Addition, Accessory, etc.)RESIDENTIAL

A5. Latitude/Longitude: Lat. 26°38'50.2" NLong.81°54'12.7"WHorizontal Datum: ☐ NAD 1927☒ NAD 1983

A6. Attach at least 2 photographs of the building if the Certificate is being used to obtain flood insurance.

A7. Building Diagram Number 1A

A8. For a building with a crawlspace or enclosure(s):

a) Square footage of crawlspace or enclosure(s)N/Asq ft

b) Number of permanent flood openings in the crawlspace or enclosure(s) within 1.0 foot above adjacent gradeN/A

c) Total net area of flood openings in A8.bN/Asq in

d) Engineered flood openings?☐ Yes☒ No

A9. For a building with an attached garage:

a) Square footage of attached garage797sq ft

b) Number of permanent flood openings in the attached garage within 1.0 foot above adjacent grade0

c) Total net area of flood openings in A9.b0sq in

d) Engineered flood openings?☐ Yes☒ No

SECTION B - FLOOD INSURANCE RATE MAP (FIRM) INFORMATION

B1. NFIP Community Name & Community Number
LEE COUNTY 125124

B2. County Name
LEE

B3. State
FL

B4. Map/Panel Number
12071C0270

B5. Suffix
F

B6. FIRM Index Date
Aug 28, 2008

B7. FIRM Panel Effective/
Revised Date
Aug 28, 2008

B8. Flood Zone(s)
AE

B9. Base Flood Elevation(s)
(Zone AO, use base flood depth
8

B10. Indicate the source of the Base Flood Elevation (BFE) data or base flood depth entered in Item B9:
☐ FIS Profile☒ FIRM☐ Community Determined☐ Other/Source:

B11. Indicate elevation datum used for BFE in Item B9: ☐ NGVD 1929☒ NAVD 1988☐ Other/Source:

B12. Is the building located in a Coastal Barrier Resources System (CBRS) area or Otherwise Protected Area (OPA)? ☐ Yes☒ No
Designation Date: ☐ CBRS☐ OPA

SECTION C - BUILDING ELEVATION INFORMATION (SURVEY REQUIRED)

C1. Building elevations are based on: ☐ Construction Drawings*☐ Building Under Construction*☒ Finished Construction

C2. Elevations - Zones A1 - A30, AE, AH, A (with BFE), VE, V1 - V30, V (with BFE), AR, AR/A, AR/AE, AR/A1 - A30, AR/AH, AR/AO.
Complete Items C2.a -h below according to the building diagram specified in Item A7. In Puerto Rico only, enter meters.

* A new Elevation Certificate will be required when construction of the building is complete.

Benchmark Utilized: NGS A 563 (PID DF8852)Vertical Datum: NAVD88

Indicate elevation datum used for the elevations in items a) through h) below. ☐ NGVD 1929☒ NAVD 1988
☐ Other/Source:

Datum used for building elevations must be the same as that used for the BFE.

Check the measurement used.

a) Top of bottom floor (including basement, crawlspace, or enclosure floor)8-8☒ feet☐ meters

b) Top of the next higher floorN/A-☐ feet☐ meters

c) Bottom of the lowest horizontal structural member (V Zones only)N/A-☐ feet☐ meters

d) Attached garage (top of slab)8-3☒ feet☐ meters

e) Lowest elevation of machinery or equipment servicing the building
(Describe type of equipment and location in Comments)8-5☒ feet☐ meters

f) Lowest adjacent (finished) grade next to building (LAG)7-5☒ feet☐ meters

g) Highest adjacent (finished) grade next to building (HAG)7-9☒ feet☐ meters

h) Lowest adjacent grade at lowest elevation of deck or stairs, including structural supportN/A-☐ feet☐ meters

FEMA Form 086-0-33 (7/15)

Replaces all previous editions.

Page 3 of 15

ELEVATION CERTIFICATE

OMB Control Number: 1660-0008
Expiration: 11/30/2018

3231 BANYON HOLLOW LOOP

NORTH FORT MYERS

FL

33903

SECTION D - SURVEYOR, ENGINEER, OR ARCHITECT CERTIFICATION

This certification is to be signed and sealed by a land surveyor, engineer, or architect authorized by law to certify elevation information. *I certify that the information on this Certificate represents my best efforts to interpret the data available. I understand that any false statement may be punishable by fine or imprisonment under 18 U.S. Code, Section 1001.*

☐ Check here if attachments.

Were latitude and longitude in Section A provided by a licensed land surveyor?
☒ Yes ☐ No

Certifier's Name RICHARD M. RITZ		License Number 4009	
Title VICE PRESIDENT	Company Name BANKS ENGINEERING		
Address 10511-101 SIX MILE CYPRESS PARKWAY	City FORT MYERS	State FL	Zip Code 33966
Signature <i>Richard M. Ritz</i>	Date 03/02/2016	Telephone +1 (239) 939-5490	

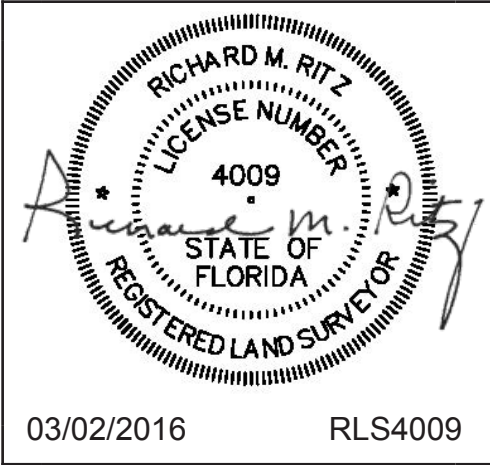

Copy both sides of this Elevation Certificate for (1) community official, (2) insurance agent/company, and (3) building owner.

Comments (including type of equipment and location , per C2(e), if applicable)"

1. Item A5: Latitude & longitude were obtained from real time GPS observation.
2. Item C2e is the elevation of the A/C slab located on the right hand (East) side of the building.

Signature *Richard M. Ritz*

Date Mar 2, 2016

SECTION E - BUILDING ELEVATION INFORMATION (SURVEY NOT REQUIRED) FOR ZONE AO AND ZONE A (WITHOUT BFE)

For Zones AO and A (without BFE), complete Items E1 -E5. If the Certificate is intended to support a LOMA or LOMR-F request, complete Sections A, B,and C. For Items E1 -E4, use natural grade, if available. Check the measurement used. In Puerto Rico only, enter meters.

E1. Provide elevation information for the following and check the appropriate boxes to show whether the elevation is above or below the highest adjacent grade (HAG) and the lowest adjacent grade (LAG).

a) Top of bottom floor (including basement, crawlspace, or enclosure) is

-

feet

meters

above or

below the HAG.

b) Top of bottom floor (including basement, crawlspace, or enclosure) is

-

feet

meters

above or

below the LAG.

E2. For Building Diagrams 6 -9 with permanent flood openings provided in Section A Items 8 and/or 9 (see pages 8 -9 of Instructions), the next higher floor (elevation C2.b in the diagrams) of the building is

-

feet

meters

above or

below the HAG.

E3. Attached garage (top of slab) is

-

feet

meters

above or

below the HAG.

E4. Top of platform of machinery and /or equipment servicing the building is

-

feet

meters

above or

below the HAG.

E5. Zone AO only: If no flood depth number is available, is the top of the bottom floor elevated in accordance with the community's floodplain management ordinance?

Yes

No

Unknown.

The local official must certify this information in Section G.

SECTION F - PROPERTY OWNER (OR OWNER'S REPRESENTATIVE) CERTIFICATION

The property owner or owner's authorized representative who completes Sections A, B, and E for Zone A (without a FEMA-issued or community-issued BFE) or Zone AO must sign here. The statements in Sections A, B, and E are correct to the best of my knowledge.

Property Owner or Owner's Authorized Representative's Name:

Address	City	State	ZIP Code
Signature	Date	Telephone	
Comments			

☐ Check here if attachments.

FEMA Form 086-0-33 (7/15)

Replaces all previous editions.

Page 4 of 15

BUILDING PHOTOGRAPHS
See instructions for Item A6

OMB Control Number: 1660-0008
Expiration: 11/30/2018

IMPORTANT: In these spaces, copy the corresponding information from Section A.			FOR INSURANCE COMPANY USE	
Building Street Address (including Apt., Unit, Suite, and/or Bldg. No.) or P.O. Route and Box No. 3231 BANYON HOLLOW LOOP			Policy Number:	
City NORTH FORT MYERS	State FL	Zip Code 33903	Company NAIC Number:	

If using the Elevation Certificate to obtain NFIP flood insurance, affix at least 2 building photographs below according to the instructions for Item A6. Identify all photographs with date taken; "Front view" and Rear view"; and, if required, "Right Side View" and "Left Side View." When applicable, photographs must show the foundation with representative examples of the flood openings or vents, as indicated in Section A8. If submitting more photographs than will fit on this page, use the Continuation Page.



RIGHT FRONT



LEFT FRONT

BUILDING PHOTOGRAPHS
Continuation Page

OMB Control Number: 1660-0008
Expiration: 11/30/2018

IMPORTANT: In these spaces, copy the corresponding information from Section A.			FORM INSURANCE COMPANY USE	
Building Street Address (including Apt., Unit,Suite, and/or Bldg. No.) or P.O.Route and Box No.			Policy Number:	
3231 BANYON HOLLOW LOOP				
City	State	Zip Code	Company NAIC Number:	
NORTH FORT MYERS	FL	33903		

If submitting more photographs than will fit on the preceding page, affix the additional photographs below. Identify all photographs with: date taken; "Front View" and "Rear View" and, if required, "Right Side View" and "Left Side View." When applicable, photographs must show the foundation with representative examples of the flood openings or vents, as indicated in Section A8.



RIGHT REAR



LEFT REAR