

DEPARTMENT OF HOMELAND SECURITY

Federal Emergency Management Agency

ELEVATION CERTIFICATE

IMPORTANT: FOLLOW THE INSTRUCTIONS ON PAGES 9-16

OMB Control Number: 1660-0008

Expiration: 11/30/2018

Copy all pages of this Elevation Certificate and all attachments for (1) community official, (2) insurance agent/company, and (3) building owner.

SECTION A - PROPERTY INFORMATION				FORM INSURANCE COMPANY USE	
A1. Building Owner's Name D.R. HORTON, INC.				Policy Number:	
A2. Building Street Address (including Apt., Unit, Suite, and/or Bldg. No.) or P.O. Route and Box No. 13391 SEASIDE HARBOUR DRIVE				Company NAIC Number:	
City NORTH FORT MYERS		State FL		Zip Code 33993	
A3. Property Description (Lot and Block Numbers, Tax Parcel Number, Legal Description, etc.) LOT 36, MOODY RIVER ESTATES UNIT SIX					
A4. Building Use (e.g., Residential, Non-Residential, Addition, Accessory, etc.)RESIDENTIAL					
A5. Latitude/Longitude: Lat. 26°39'39.5" N Long.81°54'05.9"W Horizontal Datum: <input type="radio"/> NAD 1927 <input checked="" type="radio"/> NAD 1983					
A6. Attach at least 2 photographs of the building if the Certificate is being used to obtain flood insurance.					
A7. Building Diagram Number 1A					
A8. For a building with a crawlspace or enclosure(s):					
a) Square footage of crawlspace or enclosure(s)N/A		sq ft		A9. For a building with an attached garage:	
b) Number of permanent flood openings in the crawlspace or enclosure(s) within 1.0 foot above adjacent grade		N/A		a) Square footage of attached garage 797	
c) Total net area of flood openings in A8.b		N/A		sq in	
d) Engineered flood openings?		<input type="radio"/> Yes <input checked="" type="radio"/> No		b) Number of permanent flood openings in the attached garage within 1.0 foot above adjacent grade	
				c) Total net area of flood openings in A9.b 0	
				sq in	
				d) Engineered flood openings?	
				<input type="radio"/> Yes <input checked="" type="radio"/> No	

SECTION B - FLOOD INSURANCE RATE MAP (FIRM) INFORMATION					
B1. NFIP Community Name & Community Number LEE COUNTY 125124			B2. County Name LEE		B3. State FL
B4. Map/Panel Number 12071C0267	B5. Suffix F	B6. FIRM Index Date Aug 28, 2008	B7. FIRM Panel Effective/ Revised Date Aug 28, 2008	B8. Flood Zone(s) AE	B9. Base Flood Elevation(s) (Zone AO, use base flood depth 7'
B10. Indicate the source of the Base Flood Elevation (BFE) data or base flood depth entered in Item B9: <input type="radio"/> FIS Profile <input checked="" type="radio"/> FIRM <input type="radio"/> Community Determined <input type="radio"/> Other/Source:					
B11. Indicate elevation datum used for BFE in Item B9: <input type="radio"/> NGVD 1929 <input checked="" type="radio"/> NAVD 1988 <input type="radio"/> Other/Source:					
B12. Is the building located in a Coastal Barrier Resources System (CBRS) area or Otherwise Protected Area (OPA)? <input type="radio"/> Yes <input checked="" type="radio"/> No Designation Date: <input type="radio"/> CBRS <input type="radio"/> OPA					

SECTION C - BUILDING ELEVATION INFORMATION (SURVEY REQUIRED)					
C1. Building elevations are based on: <input type="radio"/> Construction Drawings* <input type="radio"/> Building Under Construction* <input checked="" type="radio"/> Finished Construction					
C2. Elevations - Zones A1 - A30, AE, AH, A (with BFE), VE, V1 - V30, V (with BFE), AR, AR/A, AR/AE, AR/A1 - A30, AR/AH, AR/AO. Complete Items C2.a -h below according to the building diagram specified in Item A7. In Puerto Rico only, enter meters.					
* A new Elevation Certificate will be required when construction of the building is complete.					
Benchmark Utilized: NGS A 563 (PID DF8852) Vertical Datum: NAVD88					
Indicate elevation datum used for the elevations in items a) through h) below. <input type="radio"/> NGVD 1929 <input checked="" type="radio"/> NAVD 1988					
<input type="radio"/> Other/Source:					
Datum used for building elevations must be the same as that used for the BFE.					
Check the measurement used.					
a) Top of bottom floor (including basement, crawlspace, or enclosure floor)	8	-	0	<input checked="" type="radio"/> feet	<input type="radio"/> meters
b) Top of the next higher floor	19	-	0	<input checked="" type="radio"/> feet	<input type="radio"/> meters
c) Bottom of the lowest horizontal structural member (V Zones only)	N/A	-		<input type="radio"/> feet	<input type="radio"/> meters
d) Attached garage (top of slab)	7	-	5	<input checked="" type="radio"/> feet	<input type="radio"/> meters
e) Lowest elevation of machinery or equipment servicing the building (Describe type of equipment and location in Comments)	7	-	6	<input checked="" type="radio"/> feet	<input type="radio"/> meters
f) Lowest adjacent (finished) grade next to building (LAG)	7	-	2	<input checked="" type="radio"/> feet	<input type="radio"/> meters
g) Highest adjacent (finished) grade next to building (HAG)	7	-	4	<input checked="" type="radio"/> feet	<input type="radio"/> meters
h) Lowest adjacent grade at lowest elevation of deck or stairs, including structural support	N/A	-		<input type="radio"/> feet	<input type="radio"/> meters

# ELEVATION CERTIFICATE

OMB Control Number: 1660-0008  
Expiration: 11/30/2018

33993

## SECTION D - SURVEYOR, ENGINEER, OR ARCHITECT CERTIFICATION

This certification is to be signed and sealed by a land surveyor, engineer, or architect authorized by law to certify elevation information. *I certify that the information on this Certificate represents my best efforts to interpret the data available. I understand that any false statement may be punishable by fine or imprisonment under 18 U.S. Code, Section 1001.*

☒ Yes ☐ No

Telephone  
+1 (239) 939-5490

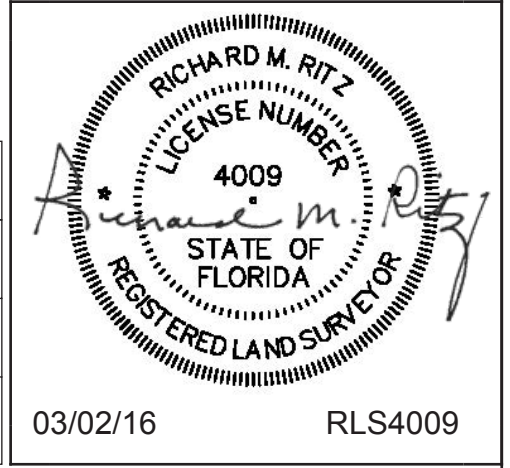

1. Item A5: Latitude & longitude were obtained by real time GPS observation.
2. Item C2e is the elevation of the A/C pad located outside the building on the right hand (East) side of the building.

Date Mar 2, 2016

**SECTION E - BUILDING ELEVATION INFORMATION (SURVEY NOT REQUIRED) FOR ZONE AO AND ZONE A (WITHOUT BFE)**

For Zones AO and A (without BFE), complete Items E1 -E5. If the Certificate is intended to support a LOMA or LOMR-F request, complete Sections A, B, and C. For Items E1 -E4, use natural grade, if available. Check the measurement used. In Puerto Rico only, enter meters.

E1. Provide elevation information for the following and check the appropriate boxes to show whether the elevation is above or below the highest adjacent grade (HAG) and the lowest adjacent grade (LAG).

a) Top of bottom floor (including basement, crawlspace, or enclosure) is \_\_\_\_\_ - \_\_\_\_\_ ☐ feet ☐ meters ☐ above or ☐ below the HAG.

b) Top of bottom floor (including basement, crawlspace, or enclosure) is \_\_\_\_\_ - \_\_\_\_\_ ☐ feet ☐ meters ☐ above or ☐ below the LAG.

E2. For Building Diagrams 6 -9 with permanent flood openings provided in Section A Items 8 and/or 9 (see pages 8 -9 of Instructions), the next higher floor (elevation C2.b in the diagrams) of the building is \_\_\_\_\_ - \_\_\_\_\_ ☐ feet ☐ meters ☐ above or ☐ below the HAG.

E3. Attached garage (top of slab) is \_\_\_\_\_ - \_\_\_\_\_ ☐ feet ☐ meters ☐ above or ☐ below the HAG.

E4. Top of platform of machinery and /or equipment servicing the building is \_\_\_\_\_ - \_\_\_\_\_ ☐ feet ☐ meters ☐ above or ☐ below the HAG.

E5. Zone AO only: If no flood depth number is available, is the top of the bottom floor elevated in accordance with the community's floodplain management ordinance? ☐ Yes ☐ No ☐ Unknown. The local official must certify this information in Section G.

## SECTION F - PROPERTY OWNER (OR OWNER'S REPRESENTATIVE) CERTIFICATION

The property owner or owner's authorized representative who completes Sections A, B, and E for Zone A (without a FEMA-issued or community-issued BFE) or Zone AO must sign here. The statements in Sections A, B, and E are correct to the best of my knowledge.

Property Owner or Owner's Authorized Representative's Name:

Address	City	State	ZIP Code
---------	------	-------	----------

Signature	Date	Telephone
-----------	------	-----------

Comments

☐ Check here if attachments.

**BUILDING PHOTOGRAPHS**  
See instructions for Item A6

OMB Control Number: 1660-0008  
Expiration: 11/30/2018

<b>IMPORTANT: In these spaces, copy the corresponding information from Section A.</b>			<b>FOR INSURANCE COMPANY USE</b>	
Building Street Address (including Apt., Unit, Suite, and/or Bldg. No.) or P.O. Route and Box No. 13391 SEASIDE HARBOUR DRIVE			Policy Number:	
City NORTH FORT MYERS	State FL	Zip Code 33993	Company NAIC Number:	

If using the Elevation Certificate to obtain NFIP flood insurance, affix at least 2 building photographs below according to the instructions for Item A6. Identify all photographs with date taken; "Front view" and Rear view"; and, if required, "Right Side View" and "Left Side View." When applicable, photographs must show the foundation with representative examples of the flood openings or vents, as indicated in Section A8. If submitting more photographs than will fit on this page, use the Continuation Page.



LEFT FRONT



RIGHT FRONT



BUILDING PHOTOGRAPHS  
Continuation Page

OMB Control Number: 1660-0008  
Expiration: 11/30/2018

IMPORTANT: In these spaces, copy the corresponding information from Section A.			FORM INSURANCE COMPANY USE	
Building Street Address (including Apt., Unit,Suite, and/or Bldg. No.) or P.O.Route and Box No.  13391 SEASIDE HARBOUR DRIVE			Policy Number:	
City  NORTH FORT MYERS	State  FL	Zip Code  33993	Company NAIC Number:	

If submitting more photographs than will fit on the preceding page, affix the additional photographs below. Identify all photographs with: date taken; "Front View" and "Rear View" and, if required, "Right Side View" and "Left Side View." When applicable, photographs must show the foundation with representative examples of the flood openings or vents, as indicated in Section A8.



LEFT REAR



RIGHT REAR