

NOTES TO USERS

This map is for use in administering the National Flood Insurance Program. It does not necessarily identify all areas subject to flooding, particularly from local drainage sources of small size. The **community map repository** should be consulted for possible updated or additional flood hazard information.

To obtain more detailed information in areas where **Base Flood Elevations (BFEs)** and/or **floodways** have been determined, users are encouraged to consult the **Flood Profiles and Floodway Data** and/or **Summary of Stillwater Elevations** tables contained within the **Flood Insurance Study (FIS)** report that accompanies this **FIRM**. Users should be aware that **BFEs** shown on the **FIRM** represent rounded whole-foot elevations. These **BFEs** are intended for flood insurance rating purposes only and should not be used as the sole source of flood elevation information. Accordingly, flood elevation data presented in the **FIS** report should be utilized in conjunction with the **FIRM** for purposes of construction and/or floodplain management.

Coastal Base Flood Elevations shown on this map apply only landward of 0.0' North American Vertical Datum of 1988 (NAVD 88). Users of this **FIRM** should be aware that coastal flood elevations are also provided in the **Summary of Stillwater Elevations** table in the **Flood Insurance Study** report for this jurisdiction. Elevations shown in the **Summary of Stillwater Elevations** table should be used for construction and/or floodplain management purposes when they are higher than the elevations shown on this **FIRM**.

Boundaries of the **floodways** were computed at cross sections and interpolated between cross sections. The **floodways** were based on hydraulic considerations with regard to requirements of the **National Flood Insurance Program**. **Floodway** widths and other pertinent **floodway** data are provided in the **Flood Insurance Study** report for this jurisdiction.

Certain areas not in **Special Flood Hazard Areas** may be protected by **flood control structures**. Refer to Section 2.4 "Flood Protection Measures" of the **Flood Insurance Study** report for information on flood control structures for this jurisdiction.

The **projection** used in the preparation of this map was Florida State Plane west zone (FIPSZONE 902). The **horizontal datum** was NAD 83, GRS80 spheroid. Differences in datum, spheroid, projection or State Plane zones used in the production of **FIRMs** for adjacent jurisdictions may result in slight positional differences in map features across jurisdiction boundaries. These differences do not affect the accuracy of this **FIRM**.

Flood elevations on this map are referenced to the **North American Vertical Datum of 1988**. These flood elevations must be compared to structure and ground elevations referenced to the same **vertical datum**. For information regarding conversion between the **National Geodetic Vertical Datum of 1929** and the **North American Vertical Datum of 1988**, visit the **National Geodetic Survey** website at <http://www.ngs.noaa.gov> or contact the **National Geodetic Survey** at the following address:

NGS Information Services
NOAA NINGS12
National Geodetic Survey
SSMC-3, #9202
1315 East-West Highway
Silver Spring, Maryland 20910-3282
(301) 713-3242

To obtain current elevation, description, and/or location information for **bench marks** shown on this map, please contact the **Information Services Branch** of the **National Geodetic Survey** at (301) 713-3242, or visit its website at <http://www.ngs.noaa.gov>.

Base map information shown on this **FIRM** was provided in digital format by the Lee County GIS Department. The road centerline information was constructed based on orthophotography produced at a scale of 1"=100' from aerial imagery flown in 1998 and updated using orthophotography dated 2002 and 2005. The surface water features were also constructed based on orthophotography produced at a scale of 1"=100' from aerial imagery flown in 1998.

This map reflects more detailed and up-to-date **stream channel configurations** than those shown on the previous **FIRM** for this jurisdiction. The **floodplains** and **floodways** that were transferred from the previous **FIRM** may have been adjusted to conform to these new **stream channel configurations**. As a result, the **Flood Profiles and Floodway Data** tables in the **Flood Insurance Study Report** (which contains authoritative hydraulic data) may reflect **stream channel distances** that differ from what is shown on this map.

Corporate limits shown on this map are based on the best data available at the time of publication. Because changes due to annexations or de-annexations may have occurred after this map was published, map users should contact appropriate community officials to verify current **corporate limit** locations.

Please refer to the separately printed **Map Index** for an overview map of the county showing the layout of map panels; community map repository addresses; and a **Listing of Communities** table containing **National Flood Insurance Program** dates for each community as well as a listing of the panels on which each community is located.

Contact the **FEMA Map Service Center** at 1-800-358-9616 for information on available products associated with this **FIRM**. Available products may include previously issued **Letters of Map Change**, a **Flood Insurance Study** report, and/or digital versions of this map. The **FEMA Map Service Center** may also be reached by Fax at 1-800-358-9620 and its website at <http://www.msc.fema.gov>.

If you have **questions about this map** or questions concerning the **National Flood Insurance Program** in general, please call 1-877-FEMA MAP (1-877-336-2627) or visit the **FEMA** website at <http://www.fema.gov>.

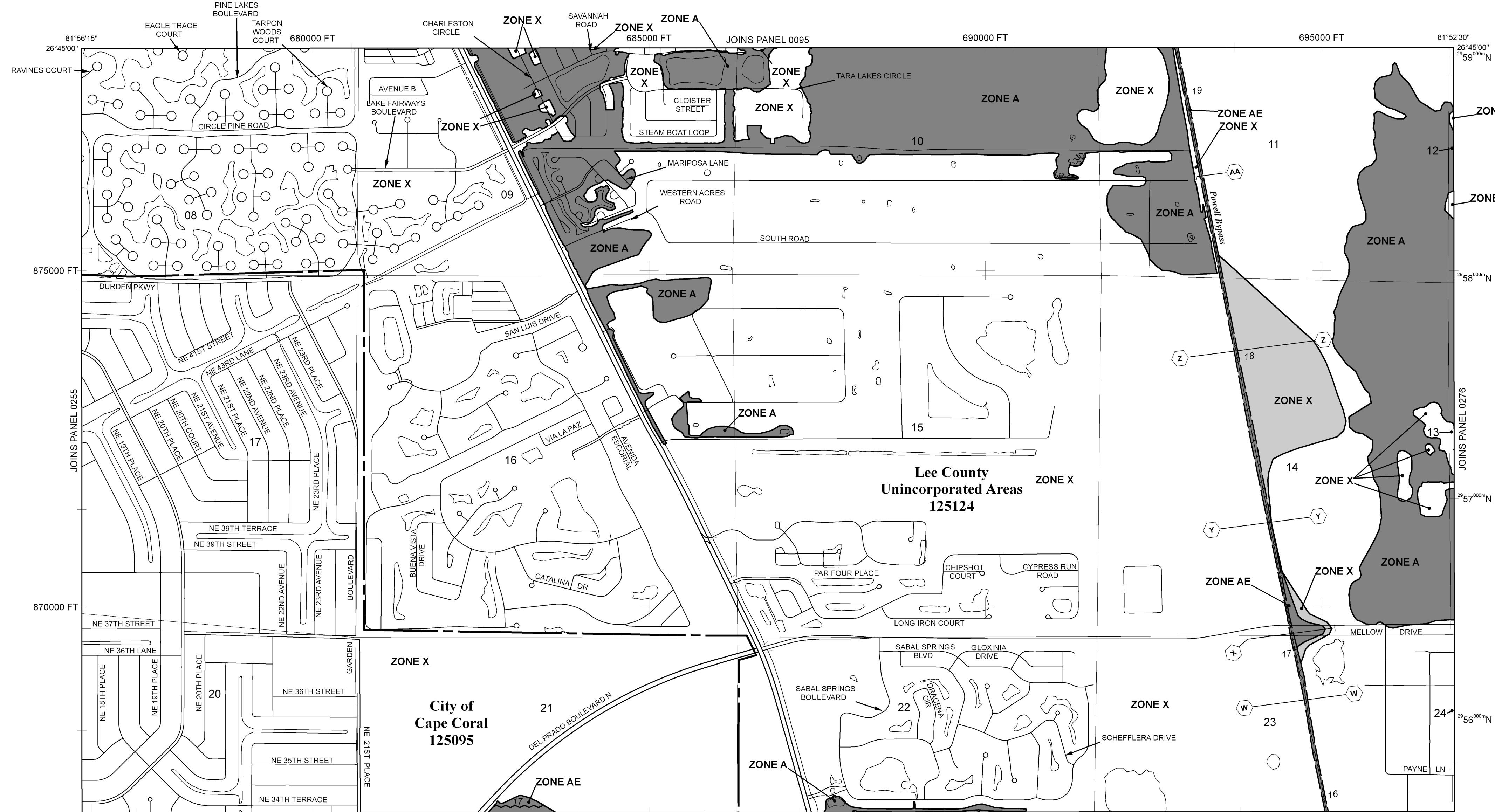

THIS AREA SHOWN AT A SCALE OF 1" = 500'
ON MAP NUMBER 12071C0258

THIS AREA SHOWN AT A SCALE OF 1" = 500'
ON MAP NUMBER 12071C0259

LEGEND

SPECIAL FLOOD HAZARD AREAS SUBJECT TO INUNDATION BY THE 1% ANNUAL CHANCE FLOOD

The 1% annual flood (100-year flood), also known as the base flood, is the flood that has a 1% chance of being equaled or exceeded in any given year. The **Special Flood Hazard Area** is the area subject to flooding by the 1% annual chance flood. Areas of **Special Flood Hazard** include Zones A, AE, AH, AO, AR, A99, V, and VE. The **Base Flood Elevation** is the water-surface elevation of the 1% annual chance flood.

ZONE A No Base Flood Elevations determined.
ZONE AE Base Flood Elevations determined.
ZONE AH Flood depths of 1 to 3 feet (usually areas of ponding); Base Flood Elevations determined.
ZONE AO Flood depths of 1 to 3 feet (usually sheet flow on sloping terrain); average depths determined. For areas of alluvial fan flooding, velocities also determined.
ZONE AR **Special Flood Hazard Area** formerly protected from the 1% annual chance flood by a flood control system that was subsequently decertified. Zone AR indicates that the former flood control system is being restored to provide protection from the 1% annual chance or greater flood.
ZONE A99 Area to be protected from 1% annual chance flood by a Federal flood protection system under construction; no Base Flood Elevations determined.
ZONE V Coastal flood zone with velocity hazard (wave action); no Base Flood Elevations determined.
ZONE VE Coastal flood zone with velocity hazard (wave action); Base Flood Elevations determined.

FLOODWAY AREAS IN ZONE AE

The floodway is the channel of a stream plus any adjacent floodplain areas that must be kept free of encroachment so that the 1% annual chance flood can be carried without substantial increases in flood heights.

OTHER FLOOD AREAS

ZONE X Areas of 0.2% annual chance flood; areas of 1% annual chance flood with average depths of less than 1 foot or with drainage areas less than 1 square mile; and areas protected by levees from 1% annual chance flood.

OTHER AREAS

ZONE X Areas determined to be outside the 0.2% annual chance floodplain.
ZONE D Areas in which flood hazards are undetermined, but possible.

COASTAL BARRIER RESOURCES SYSTEM (CBRS) AREAS
OTHERWISE PROTECTED AREAS (OPAs)

CBRS areas and OPAs are normally located within or adjacent to **Special Flood Hazard Areas**.

— Floodplain boundary
 --- Floodway boundary
 - - - Zone D boundary
 ··········· CBRS and OPA boundary
 - - - - - Boundary dividing **Special Flood Hazard Area** zones and boundary dividing **Special Flood Hazard Areas** of different Base Flood Elevations, flood depths or flood velocities.
 — 513 — Base Flood Elevation line and value; elevation in feet*
 ~~~~~ 513 ~~~~~ Epsa Flood Elevation value where uniform within zone; elevation in feet\*  
 \* Referenced to the North American Vertical Datum of 1988

⊕ Cross section line  
 ⊕ Transsect line  
 87°07'45", 32°22'30" Geographic coordinates referenced to the North American Datum of 1983 (NAD 83), Western Hemisphere  
 17°76'N 1000-meter Universal Transverse Mercator grid values, zone 17  
 600000 FT 5000-foot grid ticks: Florida State Plane coordinate system, West zone (FIPSZONE 0902), Transverse Mercator projection  
 DX5510 x Bench mark (see explanation in Notes to Users section of this **FIRM** panel)  
 ● M1.5 River Mile

**MAP REPOSITORY**  
 Refer to listing of Map Repositories on Map Index  
**EFFECTIVE DATE OF COUNTYWIDE FLOOD INSURANCE RATE MAP**  
 August 28, 2008  
**EFFECTIVE DATE(S) OF REVISION(S) TO THIS PANEL**

For community map revision history prior to countywide mapping, refer to the **Community Map History** table located in the **Flood Insurance Study** report for this jurisdiction.  
 To determine if flood insurance is available in this community, contact your insurance agent or call the **National Flood Insurance Program** at 1-800-638-6620.

**MAP SCALE 1" = 1000'**

500 0 1000 2000 FEET  
 300 0 300 600 METERS

**NATIONAL FLOOD INSURANCE PROGRAM**

**PANEL 0260F**

**FIRM**  
**FLOOD INSURANCE RATE MAP**

**LEE COUNTY, FLORIDA AND INCORPORATED AREAS**

**PANEL 260 OF 685**  
 (SEE MAP INDEX FOR FIRM PANEL LAYOUT)

**CONTAINS:**

| COMMUNITY           | NUMBER | PANEL | SUFFIX |
|---------------------|--------|-------|--------|
| CAPE CORAL, CITY OF | 125095 | 0260  | F      |
| LEE COUNTY          | 125124 | 0260  | F      |

Notice to User: The Map Number shown below should be used when placing map orders; the Community Number shown above should be used on insurance applications for the subject community.

**MAP NUMBER**  
**12071C0260F**

**EFFECTIVE DATE**  
**AUGUST 28, 2008**

**Federal Emergency Management Agency**