

LEE COUNTY SURVEY MARK DESCRIPTION

DESIGNATION 5506 COUNTY Charlotte STATE FL

LOCATION IN SEC. 32 TWP. 42S RGE. 24E USGS QUAD MAP Gilchrist, Fla

TO REACH SURVEY MARK:

TYPE OF 3 1/4" Aluminum Lee County Survey Control Mark Set in Concrete

MARK 5506 DATE SET Jan. 1999

HORIZONTAL CONTROL ORIGINATED ON 2nd/1st ORDER CONTROL BY National Geodetic Survey (NGS)

ON 1927 DATUM.

ON 1983 (1990 GPS Adj.) DATUM.

COORDINATES (FT), 2nd ORDER

COORDINATES (FT), 2nd ORDER

NORTHING (Y) N/A

NORTHING (Y) 885467.655

EASTING (X) N/A

EASTING (X) 678883.854

GRID Florida Transverse Mercator

RECOVERED BY _____

ZONE West

DATE, CONDITION _____

FIELD BOOK 4 PAGE(S) 61

RECOVERY TIES:

DISC	BEARING	DESCRIPTION
N 25° E	26.95	SET EX. PILE IN ASP. PILOT STRIP DR.
N 25° E	244.97	SET EX. PILE IN ASP. PILOT STRIP DR.
N 25° E	132.03	SET EX. DISC IN ASP. PILOT STRIP DR. FOR WOOD SHEET
N 2° E	75.94	SLY CHAIN AND WIRE POST
S 80° E	22.58	W. WIRE FENCE @ E.I. FENCE

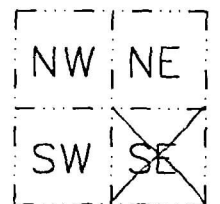
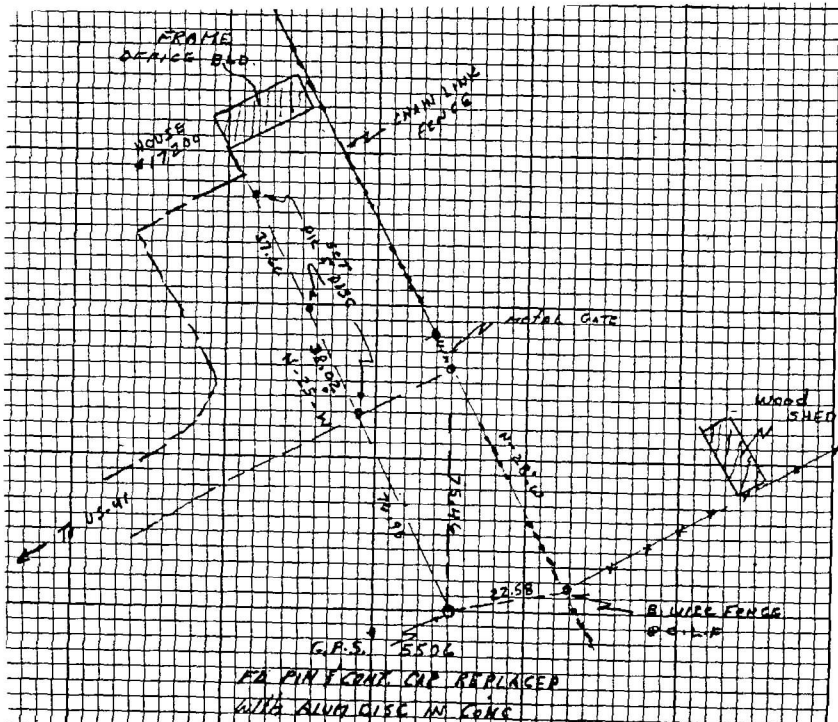

SECTION 32



SCALE: N.T.S.

SKETCH BY SAW

JOHNSON ENGINEERING, INC.

ENGINEERS, SURVEYORS AND ECOLOGISTS

OFFICE BOX 1550, FORT MYERS, FLORIDA 33902-1550, PHONE (941) 334-0048

176