

LEE COUNTY SURVEY MARK DESCRIPTION

DESIGNATION 2461 COUNTY LEE STATE FL.
 LOCATED IN SEC 22 TWP 44 S RGE 24 E USGS QUAD MAP FORT MYERS SW
 TO REACH SURVEY MARK:

TYPE OF 3/4" ALUMINUM LEE COUNTY SURVEY CONTROL MARK SET IN PAVEMENT

MARK 2461 DATE SET APRIL 23 19 99

HORIZONTAL CONTROL ORIGINATED ON 2nd/1st ORDER CONTROL BY NATIONAL GEODETIC SURVEY (NGS)

ON 1927 DATUM. ON 1983 (1990 GPS Adjustment) DATUM.

COORDINATES (FT), 2nd ORDER COORDINATES (FT), 2nd ORDER

NORTHING (N) N/A NORTHING (N) 824431.335

EASTING (E) N/A EASTING (E) 681177.706

GRID FLORIDA TRANSVERSE MERCATOR RECOVERED BY _____

ZONE WEST DATE, CONDITION _____

FIELD BOOK BL# 3 PAGE 13

RECOVERY TIES

- NO. 1 SET PK NAIL W/DISK
- NO. 2 SET PK NAIL W/DISK
- NO. 3 SET PK NAIL W/DISK



SECTION 22

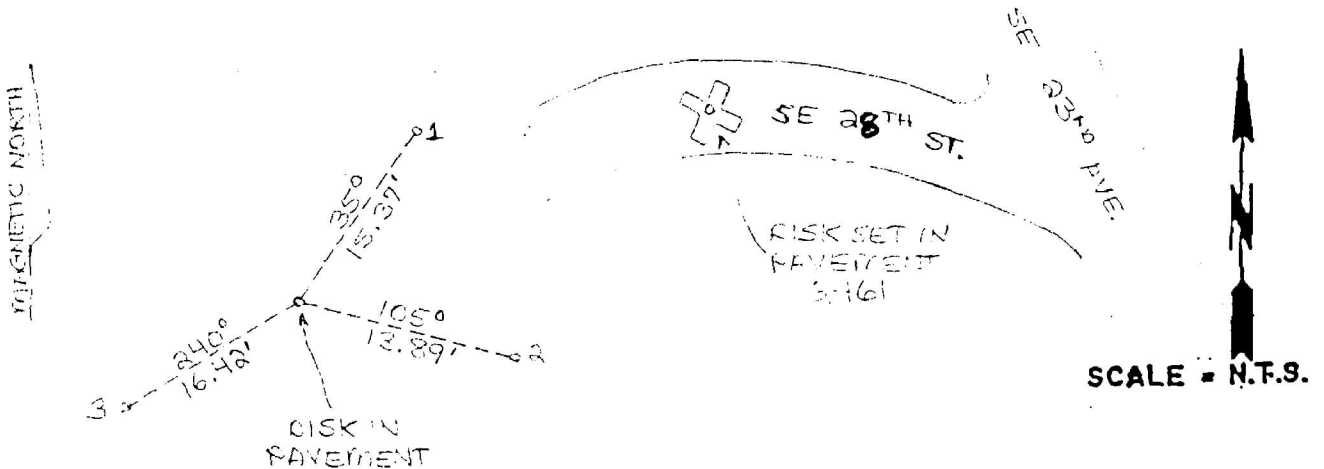

SKETCH BY LSH