

# LEE COUNTY SURVEY MARK DESCRIPTION

1353

DESIGNATION 4071 COUNTY LEE STATE FL.  
 LOCATED IN SEC 25 TWP 43S RGE 26E USGS QUAD MAP OLGA  
 TO REACH SURVEY MARK:

TYPE OF 3/4" ALUMINUM LEE COUNTY SURVEY CONTROL MARK SET IN PAVEMENT  
 MARK 4071 DATE SET APRIL 6 19 98  
 HORIZONTAL CONTROL ORIGINATED ON 2<sup>nd</sup>/1<sup>st</sup> ORDER CONTROL BY NATIONAL GEODETIC SURVEY (NGS)  
 ON 1927 DATUM. ON 1983 (1990 GPS Adjustment) DATUM.  
 COORDINATES (FT), 2<sup>nd</sup> ORDER  
 NORTHING (M) N/A NORTHING (M) 865471.1041  
 EASTING (M) N/A EASTING (M) 765038.0410  
 GRID FLORIDA TRANSVERSE MERCATOR  
 ZONE WEST  
 RECOVERED BY \_\_\_\_\_  
 DATE, CONDITION \_\_\_\_\_  
 FIELD BOOK JEI #2 PAGE 19

**RECOVERY TIES**

- NO. 1 SET PK NAIL W/DISK
- NO. 2 SET PK NAIL W/DISK
- NO. 3 SET PK NAIL W/DISK S.FACE POWER POLE

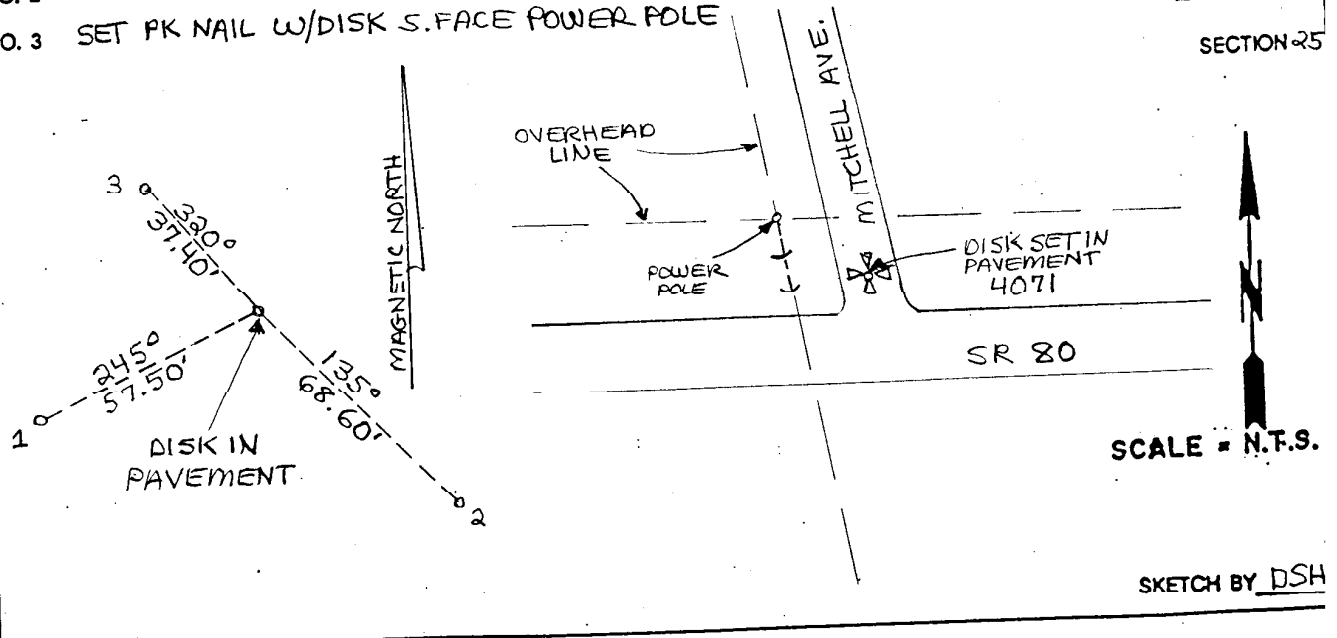

SKETCH BY DSH

**JOHNSON ENGINEERING, INC.**  
 CIVIL ENGINEERS - LAND SURVEYORS  
 2158 JOHNSON STREET, POST OFFICE BOX 1550, FORT MYERS, FLORIDA, 33902-1550  
 PHONE (941) 334-0046