

LEE COUNTY SURVEY MARK DESCRIPTION

DESIGNATION 2444 COUNTY LEE STATE FLORIDA
 LOCATED IN SEC 22 TWP 45S RGE 23E USCS QUAD MAP FORT MYERS SW

TO REACH SURVEY MARK:

FROM CAPE CORAL PKWY, RUN SOUTH ALONG PELICAN BLVD 0.9 mi.± TO EL DORADO PKWY; THENCE CONTINUE RUNNING SOUTH, RUNNING THROUGH THE INTERSECTION W/ EL DORADO PKWY ONTO ROSE GARDEN ROAD; THENCE RUN ALONG ROSE GARDEN ROAD 1 mi.± TO MARK.

TYPE OF SET 6" ROUND CONCRETE MONUMENT W/ 3" LEE COUNTY
 MARK PUBLIC WORKS ALUM. DISK DATE SET APRIL 23 19 98

HORIZONTAL CONTROL ORIGINATED ON 2ND-3RD ORDER CONTROL BY _____
 ON 1927 DATUM. ON 1983 (1990 GPS ADJUSTMENT) DATUM.

COORDINATES (FT.) 2ND ORDER COORDINATES (FT.) 2ND ORDER
 NORTHING (Y) _____ NORTHING (Y) 802968.33
 EASTING (X) _____ EASTING (X) 657682.44

GRID FLORIDA TRANSVERSE MERCATOR RECOVERED BY _____

ZONE WEST DATE CONDITION _____

FIELD BOOK BWL #3 PAGE 5

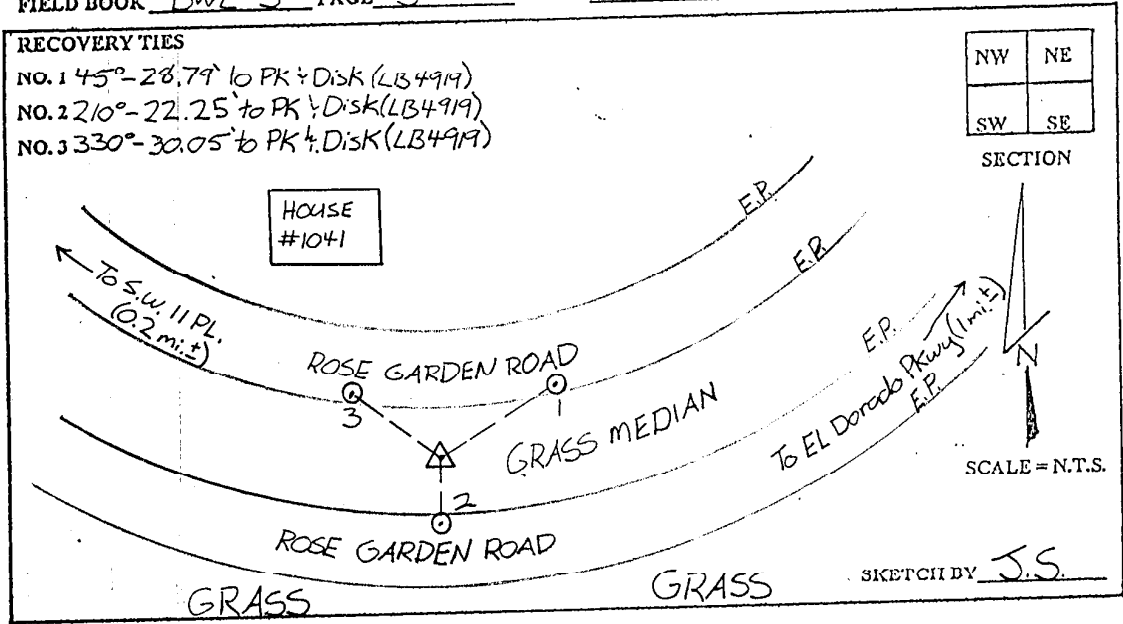

JOHNSON ENGINEERING, INC.

CIVIL ENGINEERS - LAND SURVEYORS

2158 JOHNSON STREET, POST OFFICE BOX 1550, FORT MYERS, FLORIDA, 33902-1550

PHONE: 941-334-0046