

LEE COUNTY
SURVEY MARK DESCRIPTION

DESIGNATION 2123 COUNTY LEE STATE FLORIDA
 LOCATED IN SEC 7 TWP 45S RGE 27E USGS QUAD MAP ALVA SW

TO REACH SURVEY MARK:

FROM S.R.-82, RUN NORTHERLY ALONG ALABAMA ROAD 1 mi. ± TO THE INTERSECTION OF PELHAM ROAD; THENCE CONTINUE RUNNING NORTHERLY ALONG ALABAMA ROAD 250' ± TO DISK "2123" LOCATED NORTH OF ALABAMA ROAD.

TYPE OF SET 6" ROUND CONCRETE MONUMENT W/ 3" LEE COUNTY
 MARK PUBLIC WORKS ALUM. DISK DATE SET JUNE 19 19 98

HORIZONTAL CONTROL ORIGINATED ON 2ND 1ST ORDER CONTROL BY _____
 ON _____ 1927 _____ DATUM. ON 1983 (1990 GPS ADJUSTMENT) _____ DATUM.

COORDINATES (FT). 2ND ORDER COORDINATES (FT) 2ND ORDER
 NORTHING (Y) _____ NORTHING (Y) 814744.16
 EASTING (X) _____ EASTING (X) 767205.51

GRID FLORIDA TRANSVERSE MERCATOR RECOVERED BY _____
 ZONE WEST DATE CONDITION _____
 FIELD BOOK BWL#1 PAGE 17

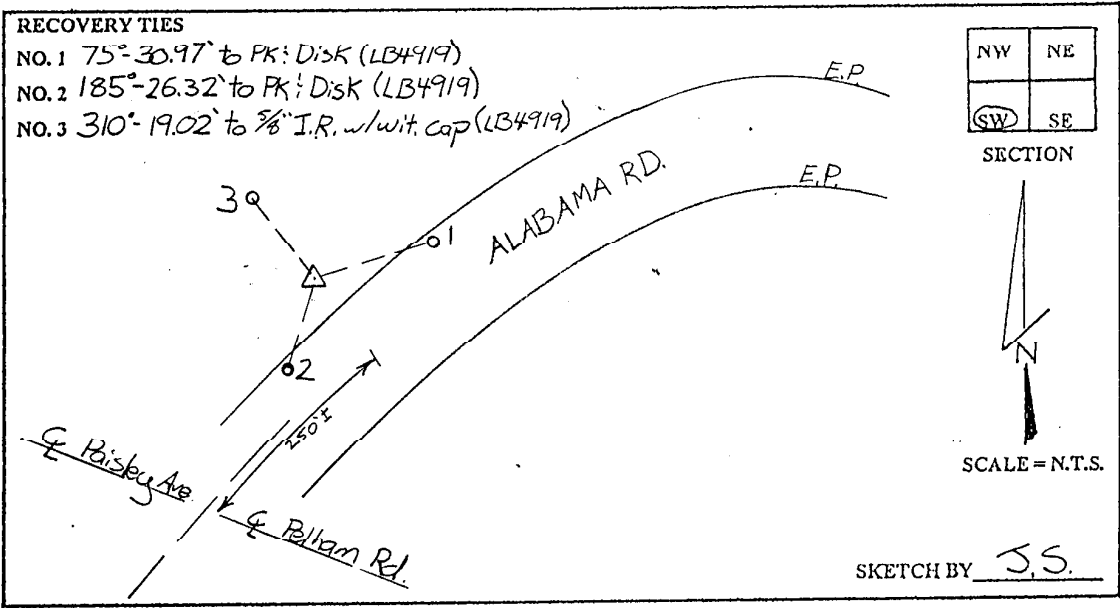

JOHNSON ENGINEERING, INC.

CIVIL ENGINEERS - LAND SURVEYORS

2158 JOHNSON STREET, POST OFFICE BOX 1550, FORT MYERS, FLORIDA, 33902-1550

PHONE: 941-334-0046