

LEE COUNTY
SURVEY MARK DESCRIPTION

DESIGNATION 2226 COUNTY LEE STATE FLORIDA
 LOCATED IN SEC 8 TWP 45S RGE 23E USGS QUAD MAP PINE ISLAND CENTER

TO REACH SURVEY MARK:

FROM CHIQUITA BLVD, RUN WEST ALONG CAPE CORAL PKWY 1.5 mi.± TO SANDS BLVD; THENCE RUN NORTH ON SANDS BLVD. 0.3 mi.± TO S.W. 45th ST; THENCE RUN WEST ON SW 45th ST. 400'± TO DISK "2226"

TYPE OF SET 3" LEE COUNTY PUBLIC WORKS ALUM. DISK IN PAVEMENT
 MARK _____ DATE SET APRIL 23 1998

HORIZONTAL CONTROL ORIGINATED ON 2ND ORDER CONTROL BY _____
 ON 1927 DATUM. ON 1983 (1990 GPS ADJUSTMENT) DATUM.

COORDINATES (FT.) 2ND ORDER COORDINATES (FT.) 2ND ORDER
 NORTHING (Y) _____ NORTHING (Y) 811985.80
 EASTING (X) _____ EASTING (X) 645348.63

GRID FLORIDA TRANSVERSE MERCATOR RECOVERED BY _____
 ZONE WEST DATE CONDITION _____

FIELD BOOK BWL #2 PAGE 1, 16

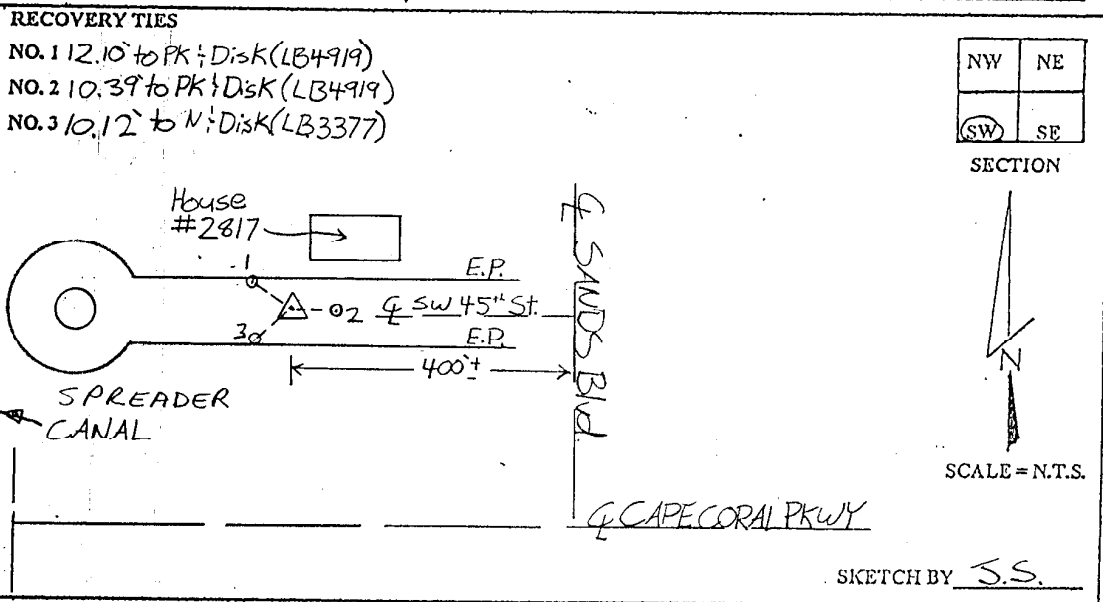

JOHNSON ENGINEERING, INC.

CIVIL ENGINEERS - LAND SURVEYORS

2158 JOHNSON STREET, POST OFFICE BOX 1550, FORT MYERS, FLORIDA, 33902-1550

PHONE: 941-334-0046